

**CORNER RECORD**

COUNTY OF MADERA T. 7 S. R. 20 E. MDM MERIDIAN CALIFORNIA  
 CORNER TYPE: GOV'T. CORNER  MEANDER  RANCHO  CONTROL  OTHER   
 CORNER IDENTIFICATION — DATE OF VISIT Sept 1976

SW COR  
SEC 17

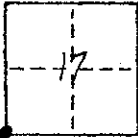

CORNER — LEFT AS FOUND  FOUND AND TAGGED  REESTABLISHED OBLITERATED CORNER  REBUILT

PHYSICAL DESCRIPTION OF CORNER FOUND; EVIDENCE AND METHOD USED TO IDENTIFY OR REESTABLISH

*Found 1 1/2" galv. pipe and Brass Cap marked for Section Cor  
 and ~~logged~~ "L.S. 3722" in Rock Mound.  
 Stamped*

PHYSICAL DESCRIPTION OF MONUMENTS REBUILT OR PERPETUATED

*NONE*

CALIFORNIA COORDINATE SYSTEM ORDER: FIRST  SECOND  THIRD   
 STATIONS USED: NGS (USC & GS)  STATE  COUNTY  OTHER  STATION \_\_\_\_\_ STATION \_\_\_\_\_  
 ZONE \_\_\_\_\_ ELEVATION \_\_\_\_\_ NORTHINGS (Y) \_\_\_\_\_ EASTINGS (X) \_\_\_\_\_

SKETCH: (Include reference tie or witness points, remarks and topo of area)

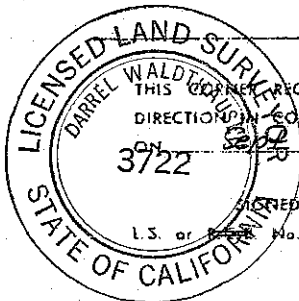
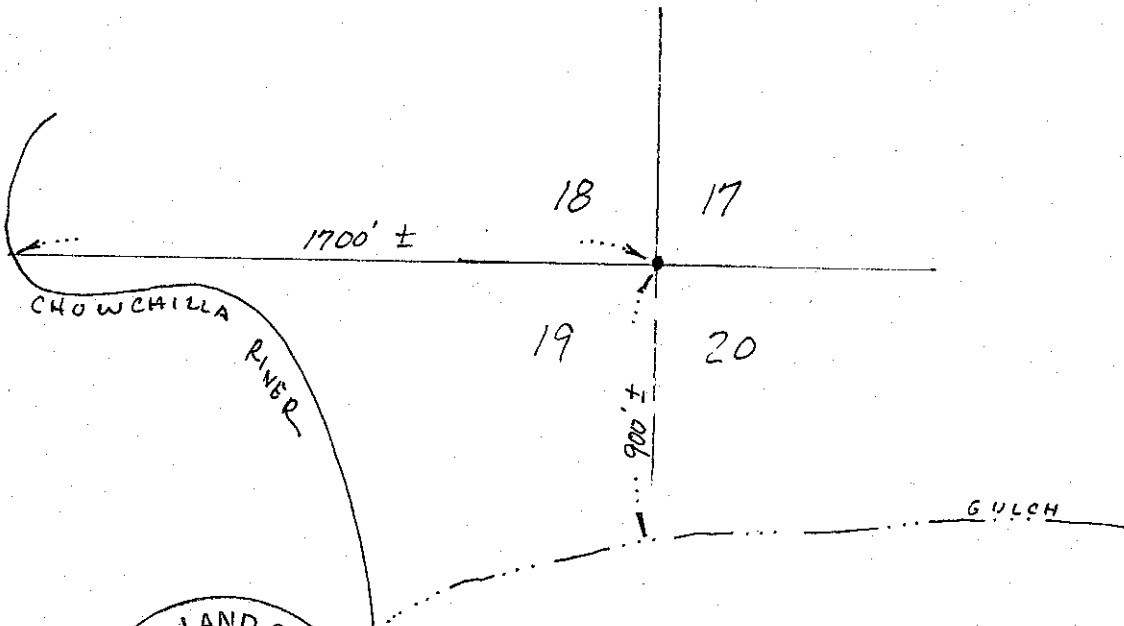

**SURVEYOR'S CERTIFICATE**

THIS CORNER RECORD WAS PREPARED BY ME OR UNDER MY  
 DIRECTION IN CONFORMANCE WITH THE LAND SURVEYORS ACT  
 ON Sept 29 1976

SIGNED: D. Waldorff  
 L.S. or P.E.S. No. 3722

SEAL

**COUNTY SURVEYOR'S CERTIFICATE**

THE CORNER RECORD WAS RECEIVED 10.4 1976  
 AND EXAMINED AND FILED Oct 6 1976

BY: A. Brate  
 TITLE: County Engineer

DOCUMENT No. 76-287

STATEMENT ON BACK OF SHEET

YES  NO