

CORNER RECORD

COUNTY OF Madera T. 7 S. R. 20 E. MDM MERIDIAN CALIFORNIA
 CORNER TYPE: GOVT. CORNER MEANDER RANCHO CONTROL OTHER
 CORNER IDENTIFICATION — DATE OF VISIT Sept 1976

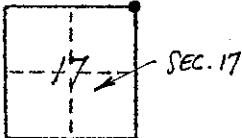

CORNER — LEFT AS FOUND FOUND AND TAGGED REESTABLISHED OBLITERATED CORNER REBUILT

PHYSICAL DESCRIPTION OF CORNER FOUND; EVIDENCE AND METHOD USED TO IDENTIFY OR REESTABLISH

Found ORIG GOVT. STONE WHICH MEASURES 22" x 13" x 6" ON SOUTHERLY SLOPE

Note: top portion of stone separated during excavation

ORIG. BEARING TREES NOT FOUND

PHYSICAL DESCRIPTION OF MONUMENTS REBUILT OR PERPETUATED

Set 3/4" pipe tagged "LS 3722" on easterly side of stone.

CALIFORNIA COORDINATE SYSTEM ORDER: FIRST SECOND THIRD
 STATIONS USED: NGS (USC & GS) STATE COUNTY OTHER STATION _____ STATION _____
 ZONE _____ ELEVATION _____ NORTHINGS (Y) _____ EASTINGS (X) _____

SKETCH: (Include reference tie or witness points, remarks and topo of area)

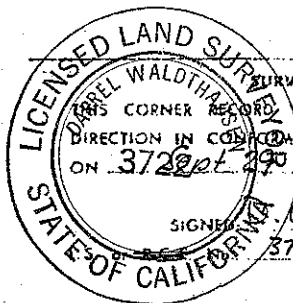
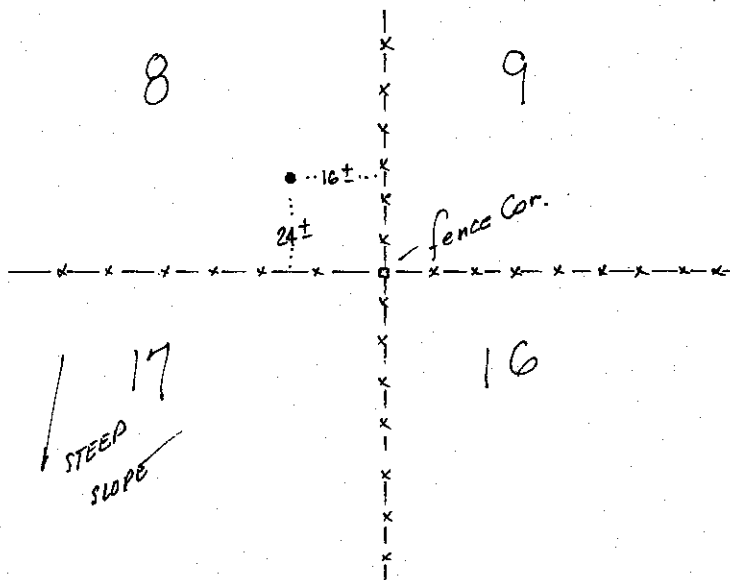

SURVEYOR'S CERTIFICATE
 THIS CORNER RECORD WAS PREPARED BY ME OR UNDER MY
 DIRECTION IN CONFORMANCE WITH THE LAND SURVEYORS ACT
 ON 3722 Sept 29 1976
 SIGNED: Daniel Waldthagen
3722

SEAL

COUNTY SURVEYOR'S CERTIFICATE
 THE CORNER RECORD WAS RECEIVED 10-4 1976
 AND EXAMINED AND FILED Oct 6 1976
 BY: A. Drote
 TITLE: County Engineer
 DOCUMENT No. 76-29-3

STATEMENT ON BACK OF SHEET

YES NO