

CORNER RECORD

COUNTY OF MADERA T. 8 S R. 23 E MD MERIDIAN CALIFORNIA
 CORNER TYPE: GOV'T. CORNER MEANDER RANCHO CONTROL OTHER
 CORNER IDENTIFICATION — DATE OF VISIT Jan 3 1985

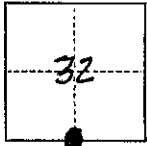

Quarter Corner, Section 32

CORNER — LEFT AS FOUND FOUND AND TAGGED REESTABLISHED OBLITERATED CORNER REBUILT

PHYSICAL DESCRIPTION OF CORNER FOUND; EVIDENCE AND METHOD USED TO IDENTIFY OR REESTABLISH

Standard GLO 3/4 inch brass cap on 1 inch iron pipe monument, dated 1922

40" dbh Blue oak, N60°E, 28'

20" dbh Blue oak, N56°W, 48'

Fence corner; intersection of North/South fence with West fence, West, 9 inches

PHYSICAL DESCRIPTION OF MONUMENTS REBUILT OR PERPETUATED

CALIFORNIA COORDINATE SYSTEM ORDER: FIRST SECOND THIRD
 STATIONS USED: NGS (USC & GS) STATE COUNTY OTHER STATION _____ STATION _____
 ZONE _____ ELEVATION _____ NORTHINGS (Y) _____ EASTINGS (X) _____

(Fold)

SKETCH: (Include reference tie or witness points, remarks and topo of area)

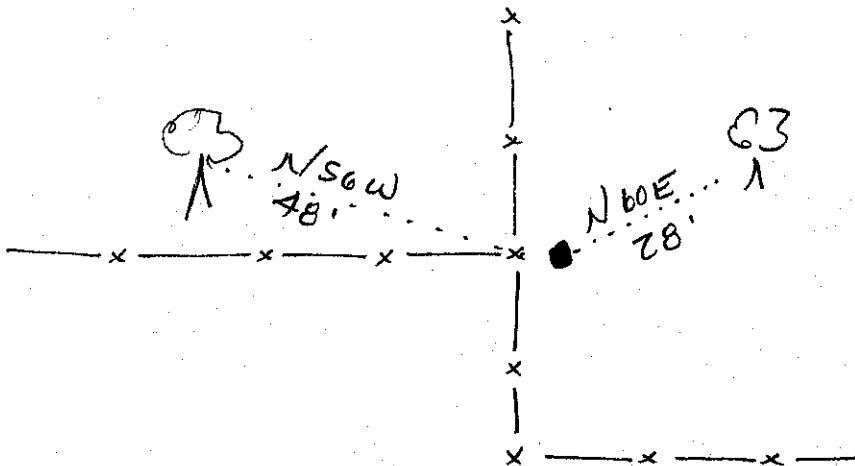

SURVEYOR'S CERTIFICATE

THIS CORNER RECORD WAS PREPARED BY ME OR UNDER MY DIRECTION IN CONFORMANCE WITH THE LAND SURVEYORS ACT ON March 8 1985

SIGNED: Charles Victor Sikora
 L.S. or R.C.E. No.: LS4126

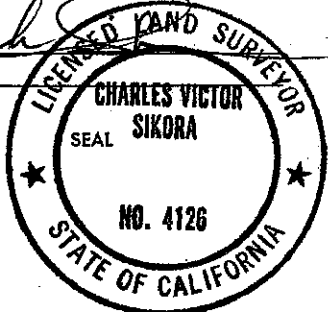

COUNTY SURVEYOR'S CERTIFICATE

THE CORNER RECORD WAS RECEIVED _____ 19____ AND EXAMINED AND FILED 3/27 1985
 BY: Thomas A. Anderson
 TITLE: _____

DOCUMENT No. _____

STATEMENT ON BACK OF SHEET YES NO