

# CORNER RECORD

COUNTY OF Madera T. 8S R. 23E M.D.B. & MERIDIAN CALIFORNIA

CORNER TYPE: GOVT. CORNER  MEANDER  RANCHO  CONTROL  OTHER

CORNER IDENTIFICATION - DATE OF VISIT May 5, 19 85

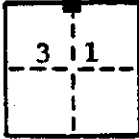

The north  $\frac{1}{4}$  corner of section 31 8/23.  
(Common to sections 30 and 31 8/23)

CORNER - LEFT AS FOUND  FOUND AND TAGGED  REESTABLISHED OBLITERATED CORNER  RESULT

**PHYSICAL DESCRIPTION OF CORNER FOUND; EVIDENCE AND METHOD USED TO IDENTIFY OR REESTABLISH**

FOUND AND ACCEPTED: A  $1\frac{1}{2}$ " O.D. I.P., up 12", with a 2" dia. brass cap stamped LS 4126. This monument is locally recognized and appears on several survey plats filed in the Madera County Records. It is accepted as the best available evidence of the original corner position.

**PHYSICAL DESCRIPTION OF MONUMENTS RESULT OR PERPETUATED**

Left monument as found. Set a metal post with Forest Service Monument signs attached 4'± SW of the corner.

CALIFORNIA COORDINATE SYSTEM ORDER: FIRST  SECOND  THIRD   
 STATIONS USED: NGS (USC & GS)  STATE  COUNTY  OTHER  STATION \_\_\_\_\_ STATION \_\_\_\_\_  
 ZONE \_\_\_\_\_ ELEVATION \_\_\_\_\_ NORTHINGS (Y) \_\_\_\_\_ EASTINGS (X) \_\_\_\_\_

**SKETCH: (Include reference tie or witness points, remarks and topo of area)**

CORNER TIES

CAP INSCRIPTION

1. A P.K. nail and tag (LS 4689) in a rock 4'x2 $\frac{1}{4}$ 'x2 $\frac{1}{2}$ ' high bears N 8° 57' 12" E, 124.96'.
2. A Digger Pine, 31.9" dia., bears N43° 29' E, 19.40'.
3. A Black Oak, 25.9" dia, bears S31° 03'W, 44.76'.
4. A P.K. nail and tag (LS 4689) in a rock 2'x2'x1' high, bears N 64° 48' 00"W, 36.47'.

T8S R23E

30  
—  
31

LS 4126

- . Corner lies 7' West of a fence corner (fences run W'ly & NE'ly from fence corner).
- . Corner lies 52 $\frac{1}{2}$ ' West of the centerline of Auberry Road (road No. 222).
- . Bearings are to the center of trees at the base. Distance are horizontal to a nail and tag (stamped LS 4689) driven into the side center of the root crown.
- . Posted Forest Service Monument and Bearing Tree signs.

V-5  
F.B. 33/09  
Job No. 84-13

THIS CORNER RECORD WAS PREPARED BY ME UNDER MY DIRECTION IN COMPLIANCE WITH THE LAND SURVEYORS ACT ON May 28 19 85 BY HOWARD ARNOLD COHEN

SIGNED: Howard Arnold Cohen

L.S. LICENSE No. 4689

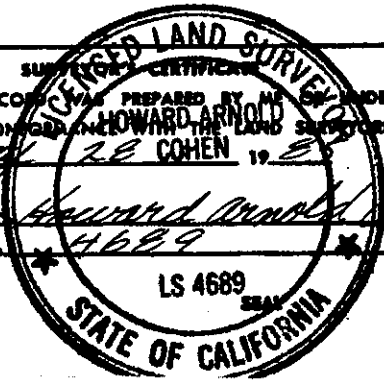

**COUNTY SURVEYOR'S CERTIFICATE**

THE CORNER RECORD WAS RECEIVED \_\_\_\_\_ 19 \_\_\_\_\_

AND EXAMINED AND FILED \_\_\_\_\_ 19 \_\_\_\_\_

BY: Howard Arnold Cohen

TITLE: \_\_\_\_\_

DOCUMENT No. \_\_\_\_\_

STATEMENT ON BACK OF SHEET

YES  NO