

CORNER RECORD

COUNTY OF MADERA T. 9 S. R. 17 E. M.D. MERIDIAN CALIFORNIA
 CORNER TYPE: GOVT. CORNER MEANDER RANCHO CONTROL OTHER
 CORNER IDENTIFICATION — DATE OF VISIT 6-17 1974

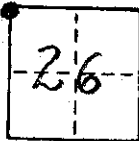

CORNER — LEFT AS FOUND FOUND AND TAGGED REESTABLISHED OBLITERATED CORNER REBUILT

PHYSICAL DESCRIPTION OF CORNER FOUND; EVIDENCE AND METHOD USED TO IDENTIFY OR REESTABLISH

FND 3/4" I.P. W/CONC PLUG & NAIL

PER. W.O. GENTRY TIES

PHYSICAL DESCRIPTION OF MONUMENTS REBUILT OR PERPETUATED

TIED SEAL ON W/WIRE RCE 7442

CALIFORNIA COORDINATE SYSTEM ORDER: FIRST SECOND THIRD
 STATIONS USED: NGS (USC & GS) STATE COUNTY OTHER STATION _____ STATION _____
 ZONE _____ ELEVATION _____ NORTHINGS (Y) _____ EASTINGS (X) _____

SKETCH: (Include reference tie or witness points, remarks and topo of area)

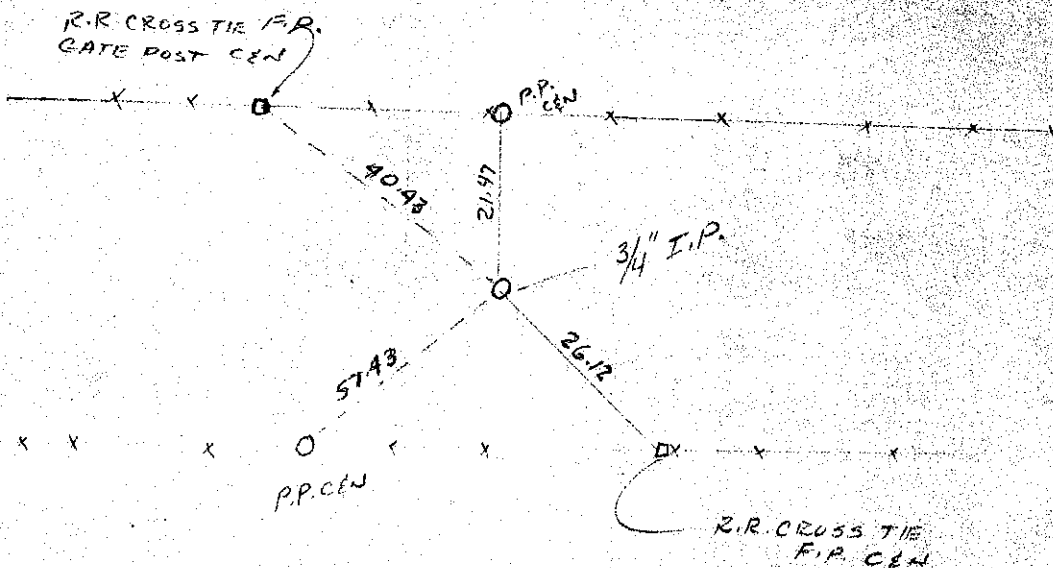

SURVEYOR'S CERTIFICATE
 THIS CORNER RECORD WAS PREPARED BY ME OR UNDER MY DIRECTION IN CONFORMANCE WITH THE LAND SURVEYORS ACT ON 10-9 1974

SIGNED: [Signature]
 R.C.E. No.: 7442

SEAL

COUNTY SURVEYOR'S CERTIFICATE
 THE CORNER RECORD WAS RECEIVED Oct 10 1974 AND EXAMINED AND FILED Oct 11 1974
 BY: [Signature]
 TITLE: County Engineer
 DOCUMENT No. 74-20-1

STATEMENT ON BACK OF SHEET

YES NO