

CORNER RECORD

COUNTY OF Madera T. 9 S R. 16 E M.D.B.&M. MERIDIAN CALIFORNIA

CORNER TYPE: GOVT. CORNER MEANDER RANCHO CONTROL OTHER
 CORNER IDENTIFICATION — DATE OF VISIT October 24, 19 74



South 1/4 corner of Section 26
 T. 9 S, R.16 E, M.D.B.&M.

CORNER — LEFT AS FOUND FOUND AND TAGGED REESTABLISHED OBLITERATED CORNER REBUILT

PHYSICAL DESCRIPTION OF CORNER FOUND; EVIDENCE AND METHOD USED TO IDENTIFY OR REESTABLISH

Reset corner as per Map of Fairmead Colony #4 recorded in Volume 3 of Maps at Page 27 Madera County Records, Madera, California

PHYSICAL DESCRIPTION OF MONUMENTS REBUILT OR PERPETUATED

3/4" Iron Pipe tagged R.C.E. 18487 UP 0.8'

CALIFORNIA COORDINATE SYSTEM ORDER: FIRST SECOND THIRD
 STATIONS USED: NGS (USC & GS) STATE COUNTY OTHER STATION _____ STATION _____
 ZONE _____ ELEVATION _____ NORTHINGS (Y) _____ EASTINGS (X) _____

SKETCH: (Include reference tie or witness points, remarks and topo of area)

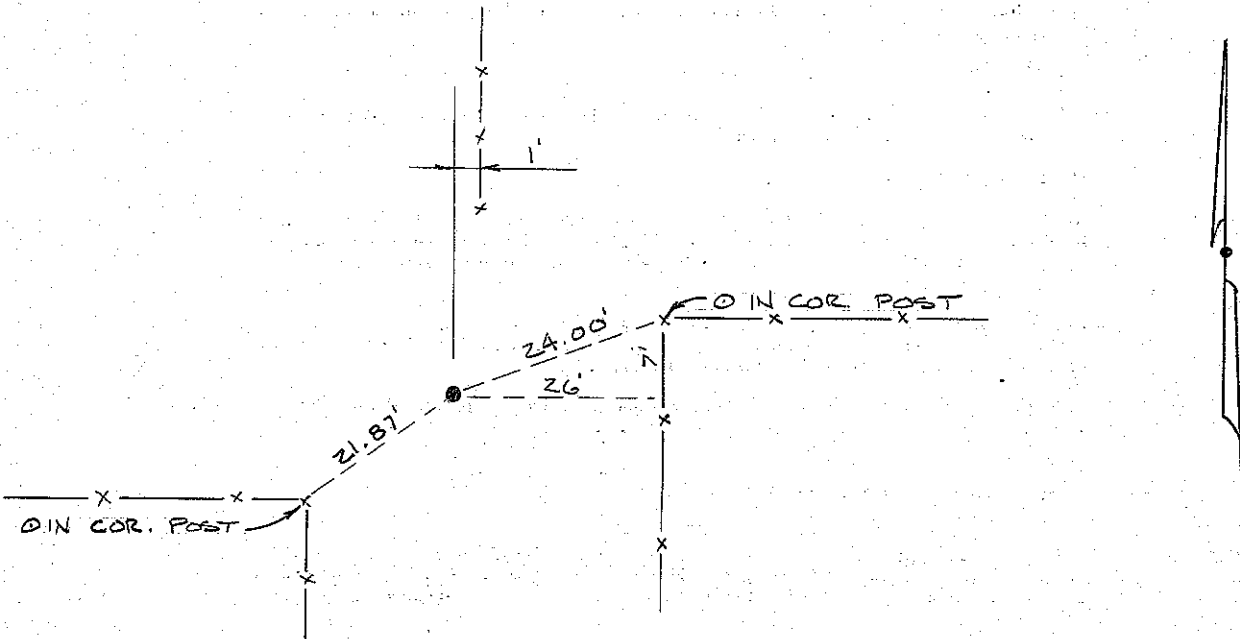

SURVEYOR'S CERTIFICATE
 THIS CORNER RECORD WAS RECEIVED UNDER MY
 DIRECTION IN CONFORMANCE WITH THE LAND SURVEYORS ACT
 ON November 4,
 SIGNED Harold D. Gies
 L.S. or R.C.E. No. No. 18,489

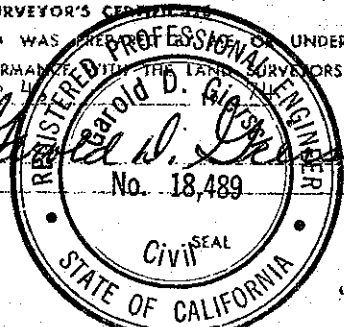

COUNTY SURVEYOR'S CERTIFICATE
 THE CORNER RECORD WAS RECEIVED Nov. 4 1974
 AND EXAMINED AND FILED Dec. 3 1974
 BY Albert C. Grote
 TITLE: County Engineer
 DOCUMENT No. 74-29-1
 STATEMENT ON BACK OF SHEET
 YES NO