

**CORNER RECORD**

Document Number \_\_\_\_\_

City of \_\_\_\_\_

County of Madera, California

Brief Legal Description Lots 61 & 66, Cascadel Woods Sub.#2 7/76-77

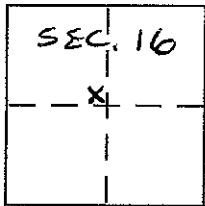

**CORNER TYPE**

Government Corner  Control   
 Meander  Property   
 Rancho  Other   
 Date of Survey July 24, 2012

**COORDINATES (Optional)**

N. \_\_\_\_\_  
 E. \_\_\_\_\_  
 Zone \_\_\_\_\_ NAD27  NAD83   
 NAD83 Epoch \_\_\_\_\_  
 Elev. \_\_\_\_\_  
 Vert. Datum: NGVD29  NAVD88   
 Meas. Units: Metric  Imperial

Corner - Left as found  Found and tagged  Established  Reestablished  Rebuilt

Identification and type of corner found: Evidence used to identify or procedure used to establish or reestablish the corner:

Found & accepted original 1" I.D.I.P. MONUMENTS & SET tags LS 4509 as noted on sketch page 2 - or as noted

A description of the physical condition of the monument as found and as set or reset:

Set 3/4" I.D.I.P.R. tagged L.S. 4509 or as noted

**SURVEYOR'S STATEMENT**

This Corner Record was prepared by me or under my direction in conformance with the Land Surveyor's Act on July 25, 2012

Signed Douglas Bredahl P.L.S or R.C.E. No. 4509

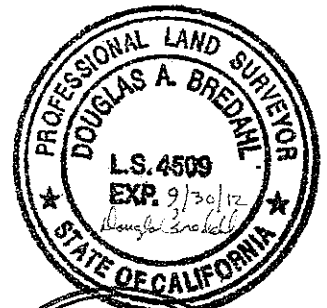

**COUNTY SURVEYOR'S STATEMENT**

This Corner Record was received 12/10/12

and examined and filed 12/19/12

Signed David McMillan P.L.S or R.C.E. No. 6968

Title Acting Co. Surveyor



County Surveyor's Comment Use SW corner Lot 61 with caution - water meter cover could move and change monument position.