

CORNER RECORD

COUNTY OF MADERA T. 8 S R. 22 E MD MERIDIAN CALIFORNIA
 CORNER TYPE: GOV'T. CORNER MEANDER RANCHO CONTROL OTHER
 CORNER IDENTIFICATION — DATE OF VISIT 7-7 19 76



S/4 COR SEC. 22, T8S, R22E
N/4 COR SEC 27 " "

CORNER — LEFT AS FOUND FOUND AND TAGGED REESTABLISHED OBLITERATED CORNER REBUILT

PHYSICAL DESCRIPTION OF CORNER FOUND; EVIDENCE AND METHOD USED TO IDENTIFY OR REESTABLISH

FOUND 3" IRON PIPE UP 48". TIES TO PREVIOUS SURVEYS BY MADERA COUNTY AND OTHERS VERIFIED LOCATION. MADERA COUNTY ROAD DEPT. SUPERVISOR TESTIFIED HE ASSISTED IN SETTING EXISTING PIPE FENCE POST OVER ORIGINAL CORNER MONUMENT.

PHYSICAL DESCRIPTION OF MONUMENTS REBUILT OR PERPETUATED

SET A 2" BRASS CAP INSIDE EXISTING PIPE MONUMENT. SET SHINNERS IN WITNESS TREES.

CALIFORNIA COORDINATE SYSTEM ORDER: FIRST SECOND THIRD
 STATIONS USED: NGS (USC & GS) STATE COUNTY OTHER STATION _____ STATION _____
 ZONE _____ ELEVATION _____ NORTHINGS (Y) _____ EASTINGS (X) _____

SKETCH: (Include reference tie or witness points, remarks and topo of area)

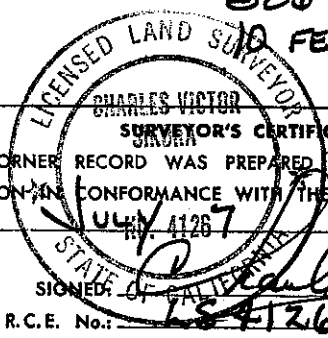
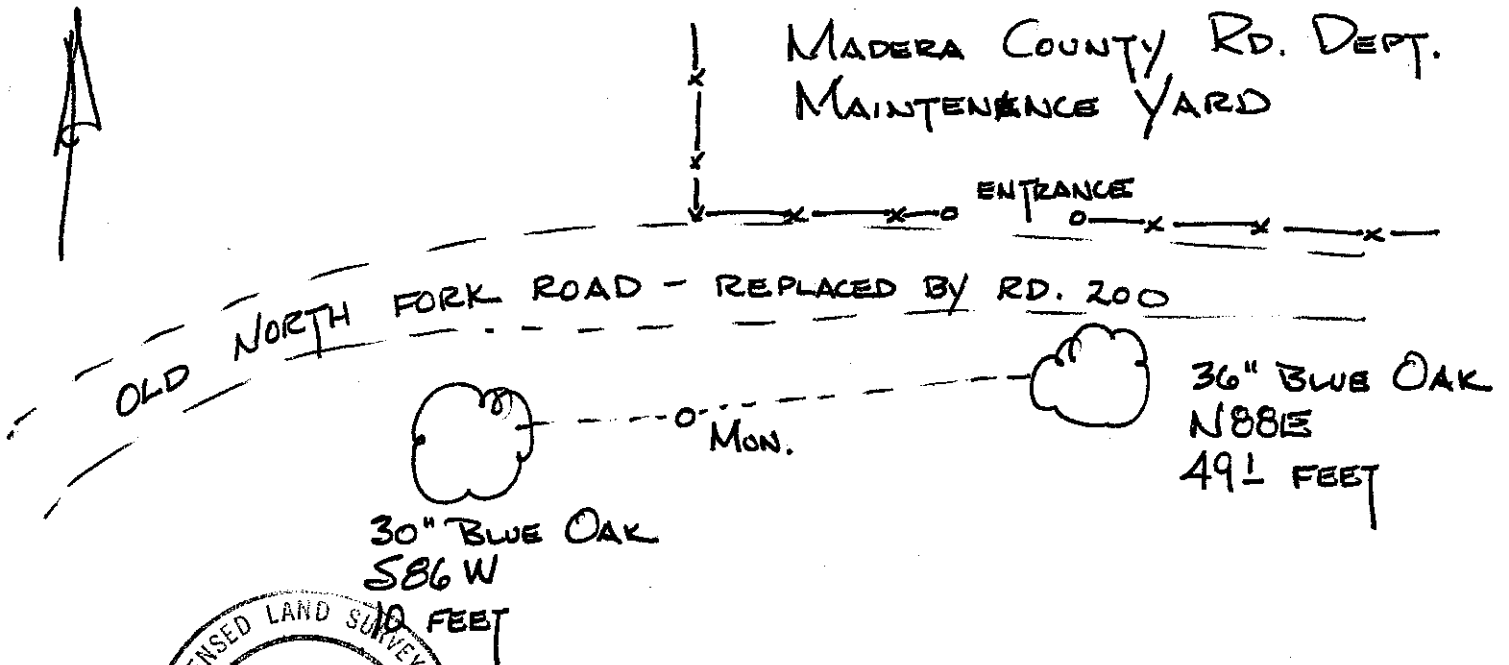

THIS CORNER RECORD WAS PREPARED BY ME OR UNDER MY DIRECTION IN CONFORMANCE WITH THE LAND SURVEYORS ACT ON July 11 1976 19 76
 SIGNED: [Signature]
 L.S. or R.C.E. No.: 26-1216

COUNTY SURVEYOR'S CERTIFICATE
 THE CORNER RECORD WAS RECEIVED 7-12 1976
 AND EXAMINED AND FILED July 12 19 76
 BY: [Signature]
 TITLE: Civil Engr. Asst.
 DOCUMENT No. 76-16-4

SEAL

STATEMENT ON BACK OF SHEET

YES NO