

CORNER RECORD

COUNTY OF MADERA T. 8S R. 22E M.D. MERIDIAN CALIFORNIA

CORNER TYPE: GOV'T. CORNER MEANDER RANCHO CONTROL OTHER
 CORNER IDENTIFICATION — DATE OF VISIT 7-7 19 76



E 1/4 COR. SEC. 22, T. 8S., R. 22E.
W 1/4 COR. SEC. 23

CORNER — LEFT AS FOUND FOUND AND TAGGED REESTABLISHED OBLITERATED CORNER REBUILT

PHYSICAL DESCRIPTION OF CORNER FOUND; EVIDENCE AND METHOD USED TO IDENTIFY OR REESTABLISH

SET BY SINGLE PROPORTION FROM FOUND SECTION CORNERS. NO EXISTING EVIDENCE OF ORIGINAL CORNER REMAINS

PHYSICAL DESCRIPTION OF MONUMENTS REBUILT OR PERPETUATED

SET A 3/4" x 30" I.P. WITH 2" BRASS CAP. SET SHINNERS A MEASUREMENT POINTS ON WITNESS TREES.

CALIFORNIA COORDINATE SYSTEM ORDER: FIRST SECOND THIRD
 STATIONS USED: NGS (USC & GS) STATE COUNTY OTHER STATION _____ STATION _____
 E _____ ELEVATION _____ NORTHINGS (Y) _____ EASTINGS (X) _____

SKETCH: (Include reference tie or witness points, remarks and topo of area)

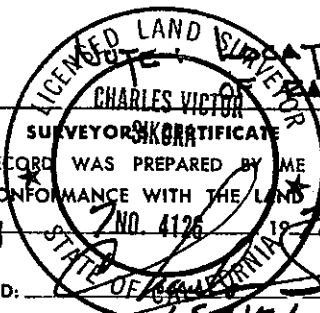
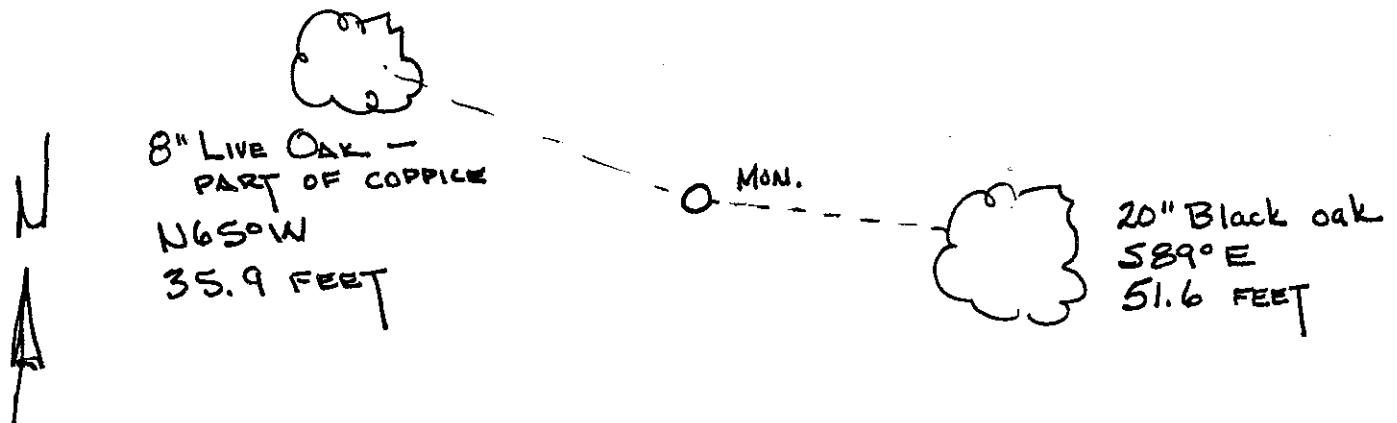

THIS CORNER RECORD WAS PREPARED BY ME OR UNDER MY DIRECTION IN CONFORMANCE WITH THE LAND SURVEYORS ACT ON July 19 76 NO. 4126 76

SIGNED: _____
 L.S. or R.C.E. No.: _____

LOCATED IN OPEN FIELD ABOUT 40 FEET EASTERLY RANCHER'S INTERIOR ACCESS ROAD.

COUNTY SURVEYOR'S CERTIFICATE
 THE CORNER RECORD WAS RECEIVED 7-12 19 76
 AND EXAMINED AND FILED July 12 19 76
 BY: Joe B. Millham
 TITLE: Civil Engineering Asst.
 DOCUMENT No. 76-16-01
 STATEMENT ON BACK OF SHEET