

CORNER RECORD

COUNTY OF MADERA T. 85 R. 22E. M.D.B. & M. MERIDIAN CALIF.

CORNER TYPE: GOV'T. CORNER () MEANDER () RANCHO () CONTROL () OTHER ()

CORNER IDENTIFICATION --- DATE OF VISIT 10-11 1976



S.E. CORNER SEC. 9 - 8-22

CORNER -- LEFT AS FOUND () FOUND & TAGGED () REESTABLISHED OBLITERATED CORNER ()
REBUILT ()

PHYSICAL DESCRIPTION OF CORNER FOUND: EVIDENCE & METHOD USED TO IDENTIFY OR REESTABLISH: FND. 1/2" I.P. TAGGED R.C.E. 5982 FOR S.E. CORNER
SECT. 9-8-22.

PHYSICAL DESCRIPTION OF MONUMENTS REBUILT OR PERPETUATED:

CALIFORNIA COORDINATE SYSTEM ORDER: FIRST () SECOND () THIRD ()
STATIONS USED: NOS (USC & GS) () STATE () COUNTY () OTHER () STATION _____
STATION _____ ZONE _____ ELEVATION _____ NORTHINGS (Y) _____
EASTINGS (X) _____

SKETCH: (INCLUDE REFERENCE TIE OR WITNESS POINTS, REMARKS AND TOPO OF AREA)

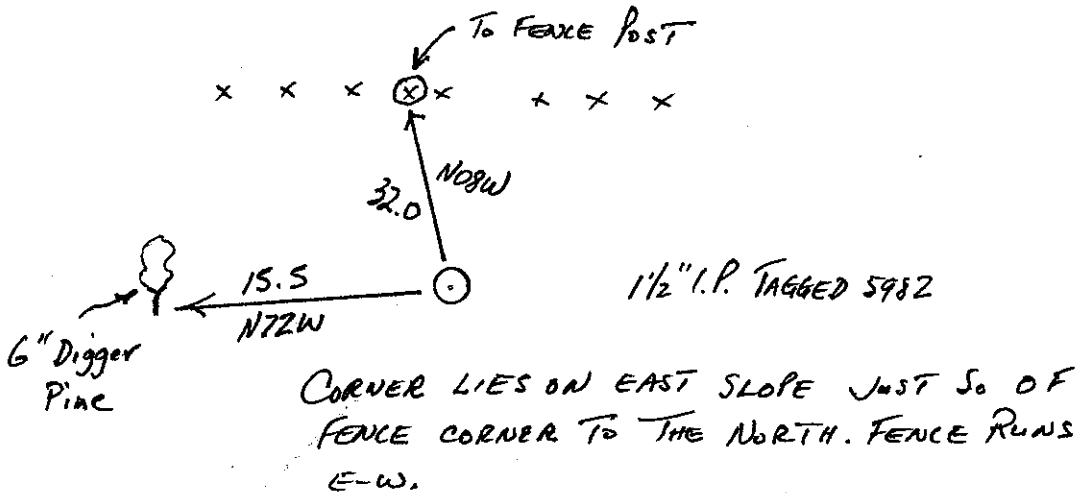

SURVEYOR'S CERTIFICATE

THIS CORNER RECORD WAS PREPARED BY ME OR UNDER MY DIRECTION IN CONFORMANCE WITH THE LAND SURVEYORS ACT ON

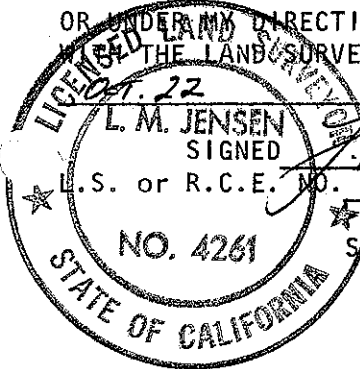

10-22 1976
L.M. JENSEN
SIGNED
L.S. or R.C.E. NO. L.S. 4261

COUNTY SURVEYOR'S CERTIFICATE

THE CORNER RECORD WAS RECEIVED 10-26-76 AND EXAMINED
AND FILED 10-27 1976

BY: A. Grote
TITLE: Co. Engr.

DOCUMENT NO. 76.30.2
STATEMENT ON BACK OF SHEET
YES () NO ()