

CORNER RECORD

COUNTY OF MADERA T. 8 S R. 21 E MERIDIAN CALIF.

CORNER TYPE: GOV'T. CORNER () MEANDER () RANCHO () CONTROL () OTHER (X)

CORNER IDENTIFICATION --- DATE OF VISIT MAY 5 1977



N 1/4 Sec. 18 T. 8 S, R. 21 E. M.D.B. & M
1" I.P. TAGGED L.S. 2229

CORNER -- LEFT AS FOUND (X) FOUND & TAGGED () REESTABLISHED OBLITERATED CORNER ()
REBUILT ()

PHYSICAL DESCRIPTION OF CORNER FOUND: EVIDENCE & METHOD USED TO IDENTIFY OR REESTABLISH:

1" IP ID ROCK M.D. TAGGED L.S. 2229
FENCE RUNS EAST, WEST.

PHYSICAL DESCRIPTION OF MONUMENTS REBUILT OR PERPETUATED:

CALIFORNIA COORDINATE SYSTEM ORDER: FIRST () SECOND () THIRD ()

STATIONS USED: NOS (USC & GS) () STATE () COUNTY () OTHER () STATION _____

STATION _____ ZONE _____ ELEVATION _____ NORTHINGS (Y) _____

EASTINGS (X) _____

SKETCH: (INCLUDE REFERENCE TIE OR WITNESS POINTS, REMARKS AND TOPO OF AREA)

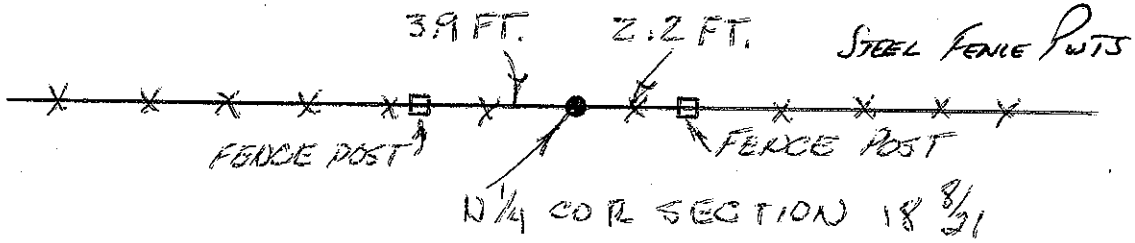

SURVEYOR'S CERTIFICATE

THIS CORNER RECORD WAS PREPARED BY ME OR UNDER MY DIRECTION IN CONFORMANCE WITH THE LAND SURVEYORS ACT ON _____ 1977

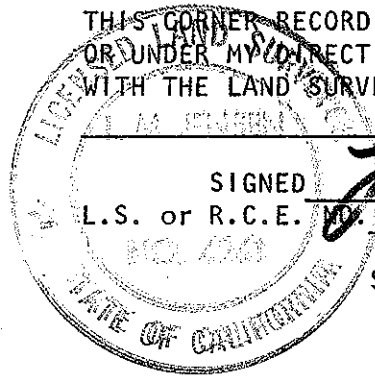

SIGNED [Signature]
L.S. or R.C.E. NO. 254261

SEAL

COUNTY SURVEYOR'S CERTIFICATE

THE CORNER RECORD WAS RECEIVED 8-12-77 AND EXAMINED AND FILED AUG 15 1977

BY: A. Grote
TITLE: County Engineer

DOCUMENT NO. 77-140-01
STATEMENT ON BACK OF SHEET
YES () NO (X)