

CORNER RECORD

COUNTY OF MADERA T. 8 R. 21 MDB MERIDIAN CALIFORNIA
CORNER TYPE: GOV'T. CORNER MEANDER RANCHO CONTROL OTHER
CORNER IDENTIFICATION - DATE OF VISIT _____ 19____

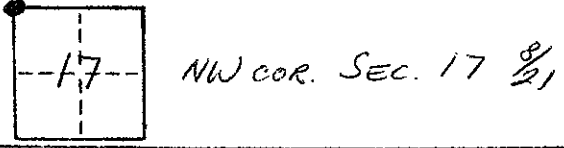

CORNER - LEFT AS FOUND FOUND AND TAGGED REESTABLISHED OBLITERATED CORNER RESULT

PHYSICAL DESCRIPTION OF CORNER FOUND; EVIDENCE AND METHOD USED TO IDENTIFY OR REESTABLISH

FD. 1" I.P. & TAG RCE 5982

PHYSICAL DESCRIPTION OF MONUMENTS RESULT OR PERPETUATED

CALIFORNIA COORDINATE SYSTEM: ORDER: FIRST SECOND THIRD
STATIONS USED: NGS (USC & GS) STATE COUNTY OTHER STATION _____ STATION _____
ZONE _____ ELEVATION _____ NORTHINGS (Y) _____ EASTINGS (X) _____

SKETCH: (Include reference tie or witness points, remarks and topo of area)

2 ORIGINAL BEARING TREES (1 STUMP), CORNER IS
2.5' E + 4.7' SO OF FENCE COR.

COPIED FROM P/M 118 BY MCKEE RCE 5982 & R/S B. 14 P. 28

SURVEYOR'S CERTIFICATE
THIS CORNER RECORD WAS PREPARED BY ME OR UNDER MY
DIRECTION IN CONFORMANCE WITH THE LAND SURVEYORS ACT
ON _____ 19____
SIGNED: _____
L.S. or R.C.E. No: _____
SEAL

COUNTY SURVEYOR'S CERTIFICATE
THE CORNER RECORD WAS RECEIVED _____ 19____
AND EXAMINED AND FILED _____ 19____
BY: _____
TITLE: _____
DOCUMENT No. _____
STATEMENT ON BACK OF SHEET
YES NO