

CORNER RECORD

COUNTY OF MADERA T. 85 R. 21 E. M.D.B. MERIDIAN CALIF.

CORNER TYPE: GOV'T. CORNER ( ) MEANDER ( ) RANCHO ( ) CONTROL ( ) OTHER (  )

CORNER IDENTIFICATION --- DATE OF VISIT 20 FEB. 19 77

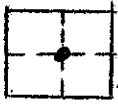

C 1/4 SEC. 7/8/21

CORNER -- LEFT AS FOUND (  ) FOUND & TAGGED ( ) REESTABLISHED OBLITERATED CORNER ( )  
REBUILT ( )

PHYSICAL DESCRIPTION OF CORNER FOUND: EVIDENCE & METHOD USED TO IDENTIFY OR REESTABLISH:

Found 1 1/2" I.P. WITH BRASS CAP STAMPED P.C.E. 5982 FOR C 1/4 SEC. 7/8/21

PHYSICAL DESCRIPTION OF MONUMENTS REBUILT OR PERPETUATED:

CALIFORNIA COORDINATE SYSTEM ORDER: FIRST ( ) SECOND ( ) THIRD ( )  
STATIONS USED: NOS (USC & GS) ( ) STATE ( ) COUNTY ( ) OTHER ( ) STATION \_\_\_\_\_  
STATION \_\_\_\_\_ ZONE \_\_\_\_\_ ELEVATION \_\_\_\_\_ NORTHINGS (Y) \_\_\_\_\_  
EASTINGS (X) \_\_\_\_\_

SKETCH: (INCLUDE REFERENCE TIE OR WITNESS POINTS, REMARKS AND TOPO OF AREA)

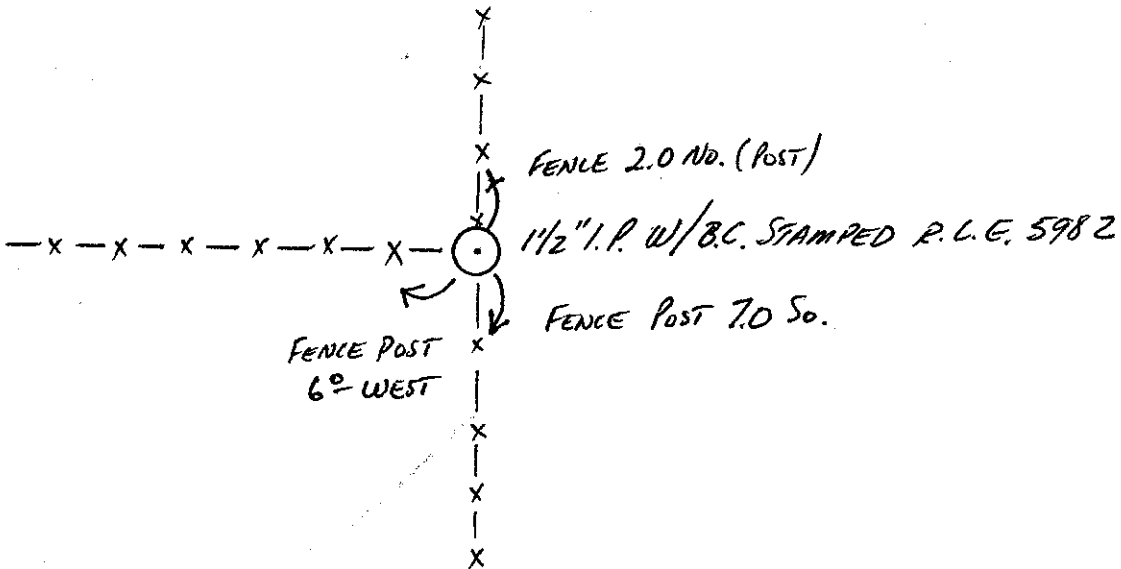

**LAND SURVEYOR'S CERTIFICATE**  
THIS CORNER RECORD WAS PREPARED BY ME OR UNDER MY DIRECTION IN CONFORMANCE WITH THE LAND SURVEYORS ACT ON 20 FEB. 19 77  
SIGNED [Signature]  
L.S. No. R.C.E. NO. 4261

**COUNTY SURVEYOR'S CERTIFICATE**  
THE CORNER RECORD WAS RECEIVED 3-9-77 AND EXAMINED AND FILED Mar 10 1977  
BY: [Signature]  
TITLE: County Engineer  
DOCUMENT NO. 77-04-01  
STATEMENT ON BACK OF SHEET  
YES ( ) NO (  )