

CORNER RECORD

DPD-3011 (NEW 11/93)

Document Number 95107

City of COARSEGOLD County of MADERA, California

Brief Legal Description WEST 1/4 CORNER SECTION 4 T. 8 S., R. 21 E. M.D.B. + M.

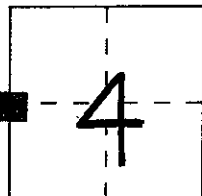

CORNER TYPE

Government Corner  Control   
Meander  Property   
Rancho  Other   
Date of Survey 04/95

Coordinates (Optional)

N. \_\_\_\_\_  
E. \_\_\_\_\_  
Zone \_\_\_\_\_ NAD: '27 \_\_\_\_\_ '83 \_\_\_\_\_  
NAD-83 Epoch \_\_\_\_\_  
Elevation \_\_\_\_\_

Corner — Left as found  Found and tagged  Established  Reestablished  Rebuilt

Identification and type of corner found: Evidence used to identify or procedure used to establish or reestablish the corner:

FOUND CALIFORNIA DIVISION OF HIGHWAYS BRASS CAP SET FLUSH IN CONCRETE AND STAMPED FOR SECTION CORNER. THIS MONUMENT REPLACED THE 1/2" REBAR AND CAP LS 9837 FROM CORNER RECORD DATED 6/28/52 IN THE SPRING OF 1988.

A description of the physical condition of the monument as found and as set or reset:

SET CALIFORNIA DIVISION OF HIGHWAYS BRASS CAP STAMPED FOR SECTION CORNER IN MONUMENT WELL.

SURVEYOR'S STATEMENT

This Corner Record was prepared by me or under my direction in conformance with the Land Surveyors' Act on 7/5 1995.

Signed [Signature] L.S. or R.C.E. Number 6499  
For the State of California  
Department of Transportation

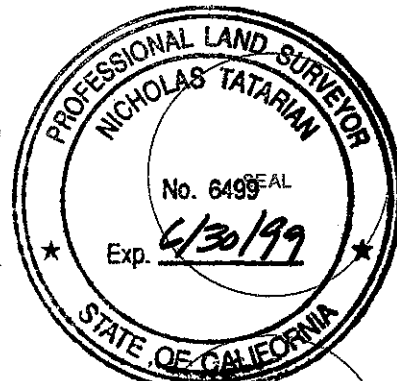

COUNTY SURVEYOR'S STATEMENT

This Corner Record was received 10 JULY 1995 and examined and filed 12 JULY 1995.

Signed [Signature] Title ACTING Co. Surveyor

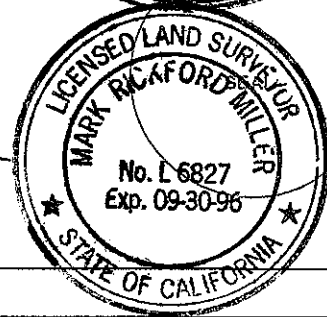

County Surveyor's Comment \_\_\_\_\_

W 1/4 SECTION 4 8/21

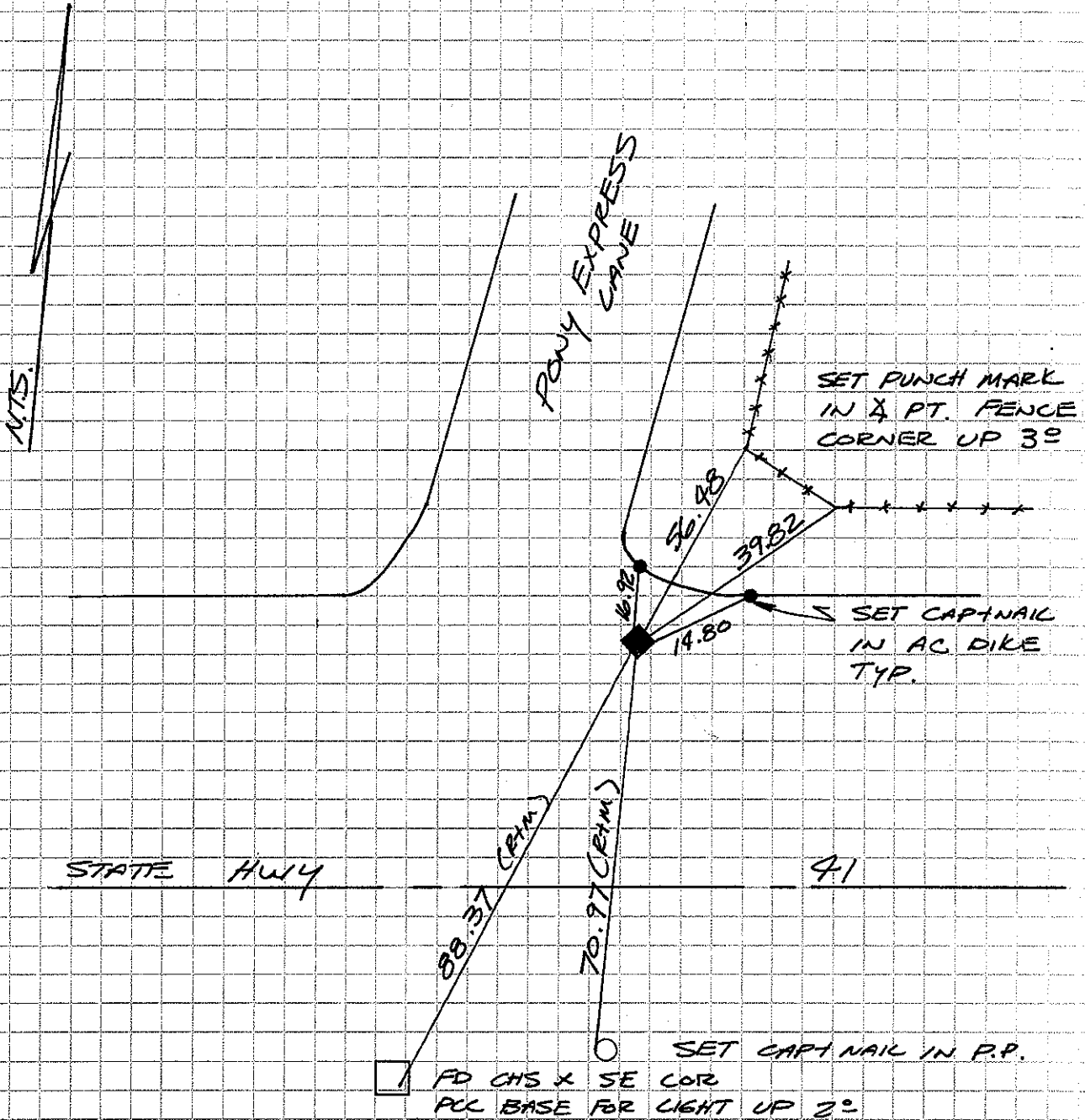

NOTE: RECORD DISTANCES SHOWN ARE FROM CALTRANS CORNER RECORD DATED 3/21/88.

082130640w