

# Appendix F

Representation of SR41  
Expansion

### GENERAL NOTES

- ALL WORK SHALL CONFORM TO THE STATE OF CALIFORNIA DEPARTMENT OF TRANSPORTATION STANDARD SPECIFICATIONS, DATED JULY 1989 AND STANDARD PLANS, DATED JULY 2004, AND THE SPECIAL PROVISIONS.
- EXISTING FACILITIES ARE SHOWN BY REFERENCE TO RECORD DATA. THE ENGINEER ASSUMES NO LIABILITY FOR THE ACCURACY OR COMPLETENESS OF THE DATA.
- ARRANGEMENTS SHALL BE MADE WITH UTILITY COMPANIES FOR ANY NECESSARY UTILITY RELOCATION INCLUDING OVERHEAD CONFLICTS.
- THE LIMITS OF WORK ARE ENCOMPASSED BY THE EXISTING RIGHT-OF-WAY AND SHALL INCLUDE ONLY SUCH WORK AS IS SHOWN ON THIS PLAN.
- ROADWAY ALIGNMENT AND DETAILS BASED ON CALTRANS STATE HIGHWAY DESIGN AS BUILT PLANS (1228000) CONTRACT # 06-305514 (EAS365511).
- DESIGN SPEED ALONG SR 41 FREEWAY AND EXPRESSWAY = 70 MPH DESIGN SPEED ON SR 41 HIGHWAY = 55 MPH.
- THIS IS A PRELIMINARY PLANLINE FOR PLANNING PURPOSES ONLY.

Underground Service Alert  
  
 Call: TOLL FREE  
 1-800-227-2600  
**TWO WORKING DAYS BEFORE YOU DIG**

### ARROW LEGEND

TYPE I	
TYPE III (L)	
TYPE III (R)	
TYPE VI (L)	



PLAN SCALE = 1"=50'

### LINETYPE LEGEND

NORTH BOUND CENTERLINE		A100
SOUTH BOUND CENTERLINE		B100
PROPOSED EP		
PROPOSED RIGHT OF WAY		
EXISTING RW/ACCESS CONTROL		
EXISTING RW/ACCESS CONTROL		

### CONSTRUCTION NOTES

1	9.0" PCC OVER 13.0" AGGREGATE BASE.
2	REMOVAL AND DISPOSAL OF EXISTING ASPHALT CONCRETE.
3	ASPHALT CONCRETE DIKE, TYPE A, PER STATE STANDARD PLAN A87B.
4	LEFT EDGE LINE, DETAIL 25, PER STATE STANDARD PLAN A20B.
5	LANE LINE, DETAIL 12, PER STATE STANDARD PLAN A20A.
6	RIGHT EDGE LINE, DETAIL 27B, PER STATE STANDARD PLAN A20B.
7	PAINTED MEDIAN ISLAND, DETAIL 38, PER STANDARD PLAN A20D.
8	REMOVE EXISTING STRIPING.
9	CHANNELIZATION LINE, DETAIL 38, PER STANDARD PLAN A20D.
10	CHANNELIZATION LINE, DETAIL 38A, PER STANDARD PLAN A20D.
11	CHANNELING CHEVRON, 12" WIDE @ 24' SPACING.
12	6" ASPHALT CONCRETE OVER 12" AGGREGATE BASE.

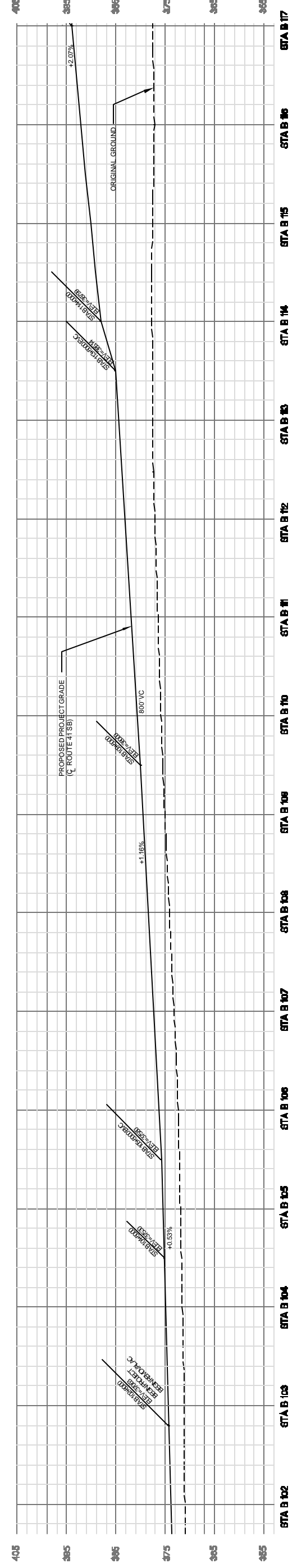

PROFILE SCALE = 1"=10'  
 HORIZ. SCALE = 1"=100'  
 VERT. SCALE = 1"=10'

GATEWAY VILLAGE  
 SR 41 EXPANSION  
 PRELIMINARY PLANLINE  
 AND PROFILE

### REVISIONS

Designed By: WB  
 Drawn By: JET  
 Checked By: WB  
 Scale: 1"=50'  
 Date: 3/05/07

File No: 95-250.5  
 Sheet:  
 1 of 9



**TPG Consulting**  
 1234567890  
 Visalia Office  
 1234 N. Main Street, Suite 100  
 Visalia, CA 93291  
 Phone: (559) 735-1234  
 Fax: (559) 735-5678  
 Website: www.tpg.com

**San Luis Obispo**  
 1234 N. Main Street, Suite 100  
 San Luis Obispo, CA 93401  
 Phone: (805) 735-1234  
 Fax: (805) 735-5678  
 Website: www.tpg.com

**Firestone Office**  
 1234 N. Main Street, Suite 100  
 Firestone, CA 94505  
 Phone: (925) 735-1234  
 Fax: (925) 735-5678  
 Website: www.tpg.com

**Dublin Office**  
 1234 N. Main Street, Suite 100  
 Dublin, CA 94568  
 Phone: (925) 735-1234  
 Fax: (925) 735-5678  
 Website: www.tpg.com

**GENERAL NOTES**

- ALL WORK SHALL CONFORM TO THE STATE OF CALIFORNIA DEPARTMENT OF TRANSPORTATION STANDARD SPECIFICATIONS, DATED JULY 1999 AND STANDARD PLANS, DATED JULY 2004, AND THE SPECIAL PROVISIONS.
- EXISTING FACILITIES ARE SHOWN BY REFERENCE TO RECORD DATA. THE ENGINEER ASSUMES NO LIABILITY FOR THE ACCURACY OR COMPLETENESS OF THE DATA.
- ARRANGEMENTS SHALL BE MADE WITH UTILITY COMPANIES FOR ANY NECESSARY UTILITY RELOCATION INCLUDING OVERHEAD CONFLICTS.
- THE LIMITS OF WORK ARE ENCOMPASSED BY THE EXISTING RIGHT-OF-WAY AND SHALL INCLUDE ONLY SUCH WORK AS IS SHOWN ON THIS PLAN.
- ROADWAY ALIGNMENT AND DETAILS BASED ON CALTRANS STATE HIGHWAY DESIGN AS BUILT PLANS (122000) CONTRACT # 06-306514 (EA 306511).
- DESIGN SPEED ALONG SR 41 FREEWAY AND EXPRESSWAY = 70 MPH DESIGN SPEED ON SR 41 HIGHWAY = 55 MPH.
- THIS IS A PRELIMINARY PLANLINE FOR PLANNING PURPOSES ONLY.

Underground Service Alert  
**CALL BEFORE YOU DIG**  
 Call: TOLL FREE  
 1-800-227-2600  
**TWO WORKING DAYS BEFORE YOU DIG**

**ARROW LEGEND**

TYPE I	↔
TYPE III (L)	↔
TYPE III (R)	↔
TYPE VI (L)	↔

**LINE TYPE LEGEND**

NORTH BOUND CENTERLINE	—+—
SOUTH BOUND CENTERLINE	—+—
PROPOSED EP	—+—
PROPOSED RIGHT OF WAY	—+—
EXISTING RIGHT OF WAY	—+—
PROPOSED RW/ACCESS CONTROL	—+—
EXISTING RW/ACCESS CONTROL	—+—

**CONSTRUCTION NOTES**

- 9.0" FCC OVER 13.0" AGGREGATE BASE.
- REMOVAL AND DISPOSAL OF EXISTING ASPHALT CONCRETE.
- ASPHALT CONCRETE DIKE, TYPE A, PER STATE STANDARD PLAN A87B.
- LEFT EDGE LINE, DETAIL 25, PER STATE STANDARD PLAN A20B.
- LANE LINE, DETAIL 12, PER STATE STANDARD PLAN A20A.
- RIGHT EDGE LINE, DETAIL 27B, PER STATE STANDARD PLAN A20B.
- PAINTED MEDIAN ISLAND, DETAIL 36, PER STANDARD PLAN A20D.
- REMOVE EXISTING STRIPING.
- CHANNELIZATION LINE, DETAIL 38, PER STANDARD PLAN A20D.
- CHANNELIZATION LINE, DETAIL 38A, PER STANDARD PLAN A20D.
- CHANNELING CHEVRON, 12" WIDE @ 24" SPACING.
- 6" ASPHALT CONCRETE OVER 12" AGGREGATE BASE.



PLAN SCALE = 1"=50'

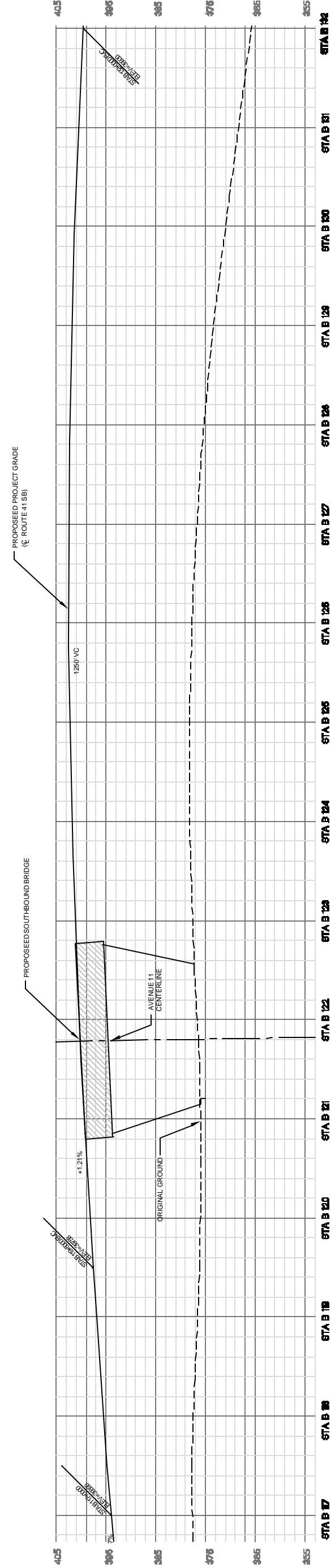
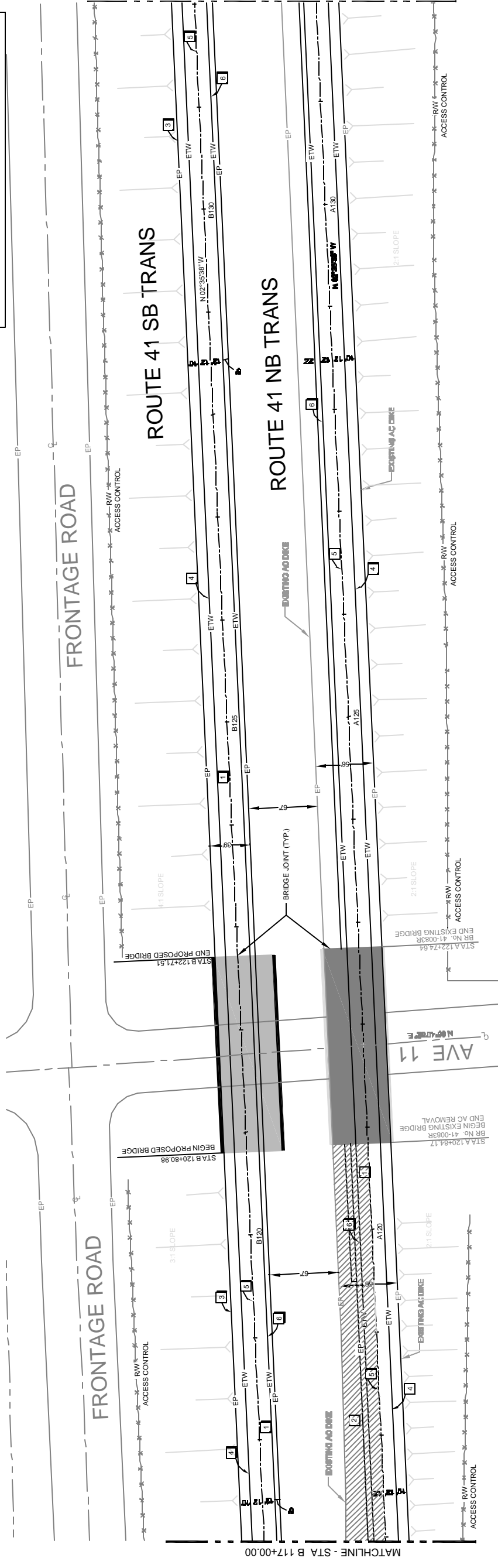

PROFILE SCALE = 1"=10'  
 VERT. SCALE = 1"=10'  
 HOR. SCALE = 1"=100'

**TPG Consulting**  
 CONSULTING ENGINEERS  
 1000 N. Santa Ana Blvd. Suite 100  
 Santa Ana, California 92701  
 Phone: (714) 241-1111  
 Fax: (714) 241-1111

**Vallejo Office**  
 1000 N. Santa Ana Blvd. Suite 100  
 Santa Ana, California 92701  
 Phone: (714) 241-1111  
 Fax: (714) 241-1111

**San Luis Obispo**  
 1000 N. Santa Ana Blvd. Suite 100  
 Santa Ana, California 92701  
 Phone: (714) 241-1111  
 Fax: (714) 241-1111

**Palmdale Office**  
 1000 N. Santa Ana Blvd. Suite 100  
 Santa Ana, California 92701  
 Phone: (714) 241-1111  
 Fax: (714) 241-1111

**Dublin Office**  
 1000 N. Santa Ana Blvd. Suite 100  
 Santa Ana, California 92701  
 Phone: (714) 241-1111  
 Fax: (714) 241-1111



**GATEWAY VILLAGE**  
 SR 41 EXPANSION  
 PRELIMINARY PLANLINE  
 AND PROFILE  
 AVENUE 11 TO AVENUE 12

**REVISIONS**

Designed By:	WB
Drawn By:	JET
Checked By:	WB
Scale:	1"=50'
Date:	03/05/07

**GENERAL NOTES**

- ALL WORK SHALL CONFORM TO THE STATE OF CALIFORNIA DEPARTMENT OF TRANSPORTATION STANDARD SPECIFICATIONS, DATED JULY 1999 AND STANDARD PLANS, DATED JULY 2004, AND THE SPECIAL PROVISIONS.
- EXISTING FACILITIES ARE SHOWN BY REFERENCE TO RECORD DATA. THE ENGINEER ASSUMES NO LIABILITY FOR THE ACCURACY OR COMPLETENESS OF THE DATA.
- ARRANGEMENTS SHALL BE MADE WITH UTILITY COMPANIES FOR ANY NECESSARY UTILITY RELOCATION INCLUDING OVERHEAD CONFLICTS.
- THE LIMITS OF WORK ARE ENCOMPASSED BY THE EXISTING RIGHT-OF-WAY AND SHALL INCLUDE ONLY SUCH WORK AS IS SHOWN ON THIS PLAN.
- ROADWAY ALIGNMENT AND DETAILS BASED ON CALTRANS STATE HIGHWAY DESIGN AS BUILT PLANS (1220000) CONTRACT # 06-306514 (EA 306511).
- DESIGN SPEED ALONG SR 41 FREEWAY AND EXPRESSWAY = 70 MPH DESIGN SPEED ON SR 41 HIGHWAY = 55 MPH.
- THIS IS A PRELIMINARY PLANLINE FOR PLANNING PURPOSES ONLY.

Underground Service Alert  
**CALL BEFORE YOU DIG**  
 Call: TOLL FREE  
 1-800-227-2600  
**TWO WORKING DAYS BEFORE YOU DIG**

**ARROW LEGEND**

TYPE I	
TYPE III (L)	
TYPE III (R)	
TYPE VI (L)	

**CURVE DATA - FLOW LINE**

CURVE	LOCATION	DELTA	RADIUS	LENGTH
①	A138+49.6	08°18'43"	3500.0'	507.8'
②	B142+20.45	08°18'43"	4972.0'	721.4'

**LINETYPE LEGEND**

NORTH BOUND CENTERLINE		+ A100
SOUTH BOUND CENTERLINE		+ B100
PROPOSED EP		
EXISTING RIGHT OF WAY		
PROPOSED RW/ACCESS CONTROL		
EXISTING RW/ACCESS CONTROL		

PLAN SCALE = 1"=50'

**CONSTRUCTION NOTES**

- 9.0' PCC COVER 13.0' AGGREGATE BASE.
- REMOVAL AND DISPOSAL OF EXISTING ASPHALT CONCRETE.
- ASPHALT CONCRETE DIKE, TYPE A, PER STATE STANDARD PLAN A207B.
- LEFT EDGE LINE, DETAIL 25, PER STATE STANDARD PLAN A20B.
- LANE LINE, DETAIL 12, PER STATE STANDARD PLAN A20A.
- RIGHT EDGE LINE, DETAIL 27B, PER STATE STANDARD PLAN A20B.
- PAINTED MEDIAN ISLAND, DETAIL 38, PER STANDARD PLAN A20D.
- REMOVE EXISTING STRIPING.
- CHANNELIZATION LINE, DETAIL 38, PER STANDARD PLAN A20D.
- CHANNELIZATION LINE, DETAIL 38A, PER STANDARD PLAN A20D.
- CHANNELING CHEVRON, 12" WIDE @ 24' SPACING.
- 6" ASPHALT CONCRETE OVER 12" AGGREGATE BASE.

**TPG CONSULTING**  
 20250  
 Valencia Office  
 1000 N. Second Street, Suite 100  
 Valencia, CA 91355  
 Phone: (661) 251-1111  
 Fax: (661) 251-1111  
 www.tpg.com

**San Luis Obispo**  
 1000 N. Second Street, Suite 100  
 San Luis Obispo, CA 93426  
 Phone: (805) 781-1111  
 Fax: (805) 781-1111  
 www.tpg.com

**Firestone Office**  
 1000 N. Second Street, Suite 100  
 Firestone, CA 94505  
 Phone: (925) 955-1111  
 Fax: (925) 955-1111  
 www.tpg.com

**Dublin Office**  
 1000 N. Second Street, Suite 100  
 Dublin, CA 94568  
 Phone: (925) 835-1111  
 Fax: (925) 835-1111  
 www.tpg.com



**GATEWAY VILLAGE**  
 SR 41 EXPANSION  
 AVENUE 11 TO AVENUE 12  
 PRELIMINARY PLANLINE  
 AND PROFILE

**REVISIONS**

Designed By:	WB
Drawn By:	JET
Checked By:	WB
Scale:	1"=50'
Date:	03/05/07

File No: 95-250.5  
 Sheet: 3 of 9

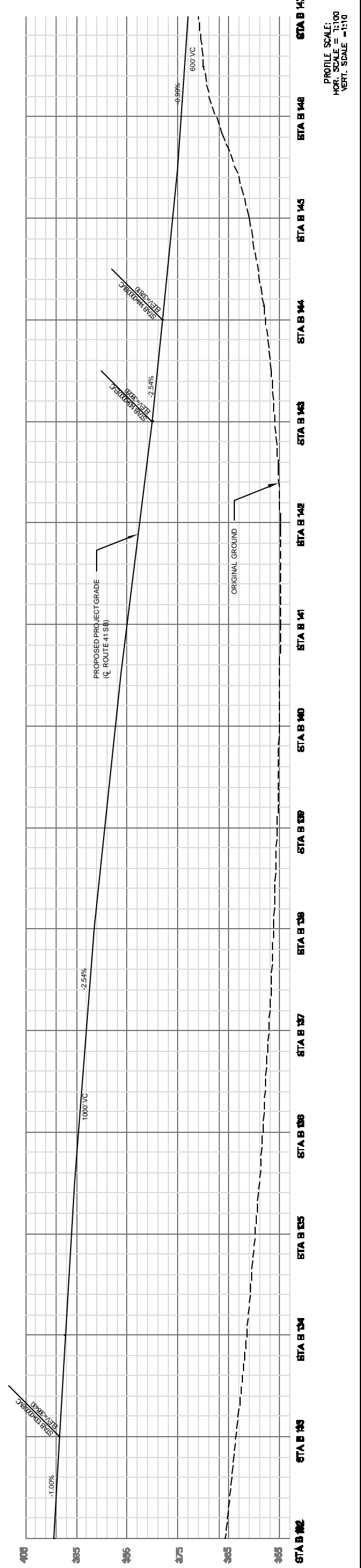
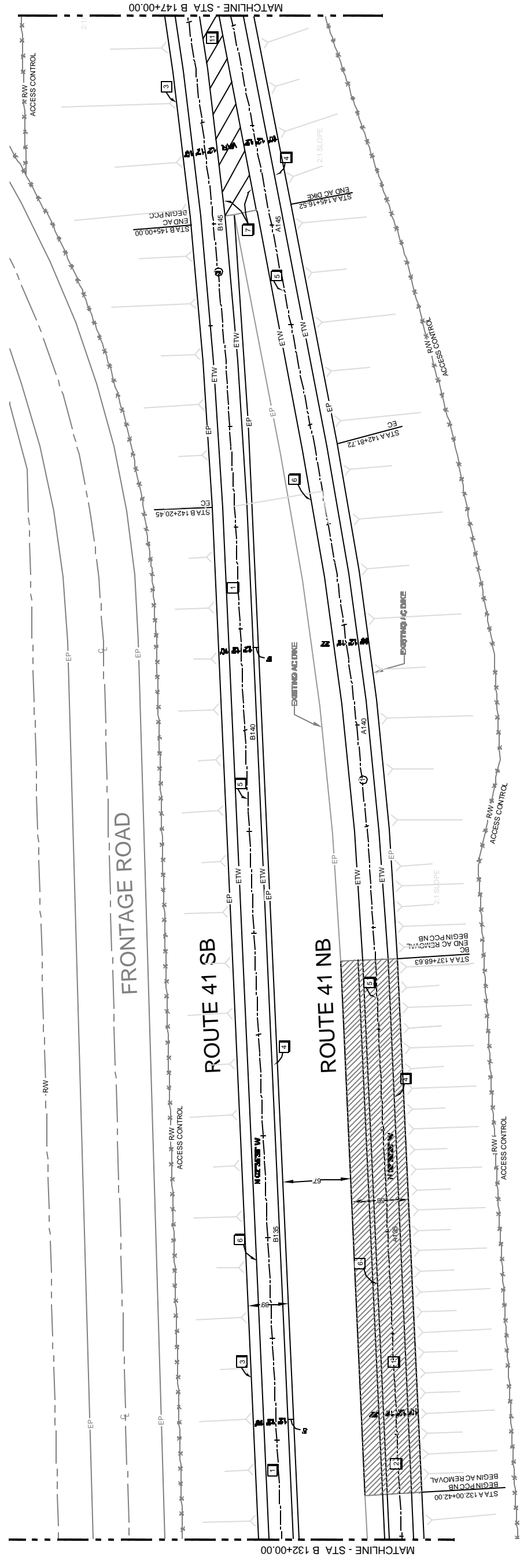

### GENERAL NOTES

- ALL WORK SHALL CONFORM TO THE STATE OF CALIFORNIA DEPARTMENT OF TRANSPORTATION STANDARD SPECIFICATIONS, DATED JULY 1989 AND STANDARD PLANS, DATED JULY 2004, AND THE SPECIAL PROVISIONS.
- EXISTING FACILITIES ARE SHOWN BY REFERENCE TO RECORD DATA. THE ENGINEER ASSUMES NO LIABILITY FOR THE ACCURACY OR COMPLETENESS OF THE DATA.
- ARRANGEMENTS SHALL BE MADE WITH UTILITY COMPANIES FOR ANY NECESSARY UTILITY RELOCATION INCLUDING OVERHEAD CONFLICTS.
- THE LIMITS OF WORK ARE ENCOMPASSED BY THE EXISTING RIGHT-OF-WAY AND SHALL INCLUDE ONLY SUCH WORK AS IS SHOWN ON THIS PLAN.
- ROADWAY ALIGNMENT AND DETAILS BASED ON CALTRANS STATE HIGHWAY DESIGN AS BUILT PLANS (122000) CONTRACT # 06-305514 (EA 305511).
- DESIGN SPEED ALONG SR 41 FREEWAY AND EXPRESSWAY = 70 MPH DESIGN SPEED ON SR 41 HIGHWAY = 55 MPH.
- THIS IS A PRELIMINARY PLANLINE FOR PLANNING PURPOSES ONLY.

Underground Service Alert  
  
 Call: TOLL FREE  
 1-800-227-2600  
**TWO WORKING DAYS BEFORE YOU DIG**

### ARROW LEGEND

TYPE I	
TYPE III (L)	
TYPE III (R)	
TYPE VI (L)	

### LINE TYPE LEGEND

NORTHBOUND CENTERLINE	—+— A100
SOUTHBOUND CENTERLINE	—+— B100
PROPOSED EP	—+—
EXISTING RIGHT OF WAY	—+—
PROPOSED RW/ACCESS CONTROL	—+—
EXISTING RW/ACCESS CONTROL	—+—

### CONSTRUCTION NOTES

- 9.0' FCC OVER 13.0' AGGREGATE BASE.
- REMOVAL AND DISPOSAL OF EXISTING ASPHALT CONCRETE.
- ASPHALT CONCRETE DIKE, TYPE A, PER STATE STANDARD PLAN A207B.
- LEFT EDGE LINE, DETAIL 25, PER STATE STANDARD PLAN A20B.
- LANE LINE, DETAIL 12, PER STATE STANDARD PLAN A20A.
- RIGHT EDGE LINE, DETAIL 27B, PER STATE STANDARD PLAN A20B.
- PAINTED MEDIAN ISLAND, DETAIL 38, PER STANDARD PLAN A20D.
- REMOVE EXISTING STRIPING.
- CHANNELIZATION LINE, DETAIL 38, PER STANDARD PLAN A20D.
- CHANNELIZATION LINE, DETAIL 38A, PER STANDARD PLAN A20D.
- CHANNELING CHEVRON, 12" WIDE @ 24" SPACING.
- 6" ASPHALT CONCRETE OVER 12" AGGREGATE BASE.



PLAN SCALE = 1"=50'

### CURVE DATA - FLOW LINE

CURVE	LOCATION	DELTA	RADIUS	LENGTH
①	A162+81.98	0°13'58"	6000 FT	986.85 FT
②	B153+48.11	0°13'58"	4952 FT	799.58 FT

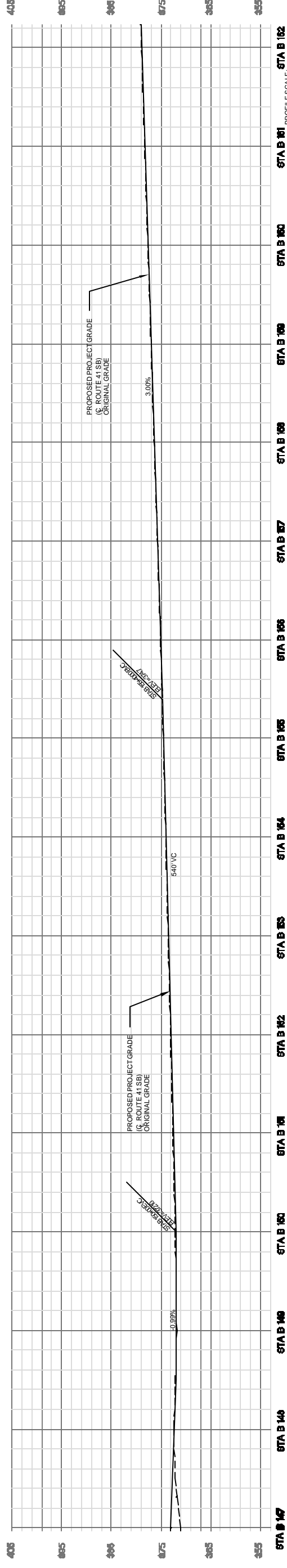
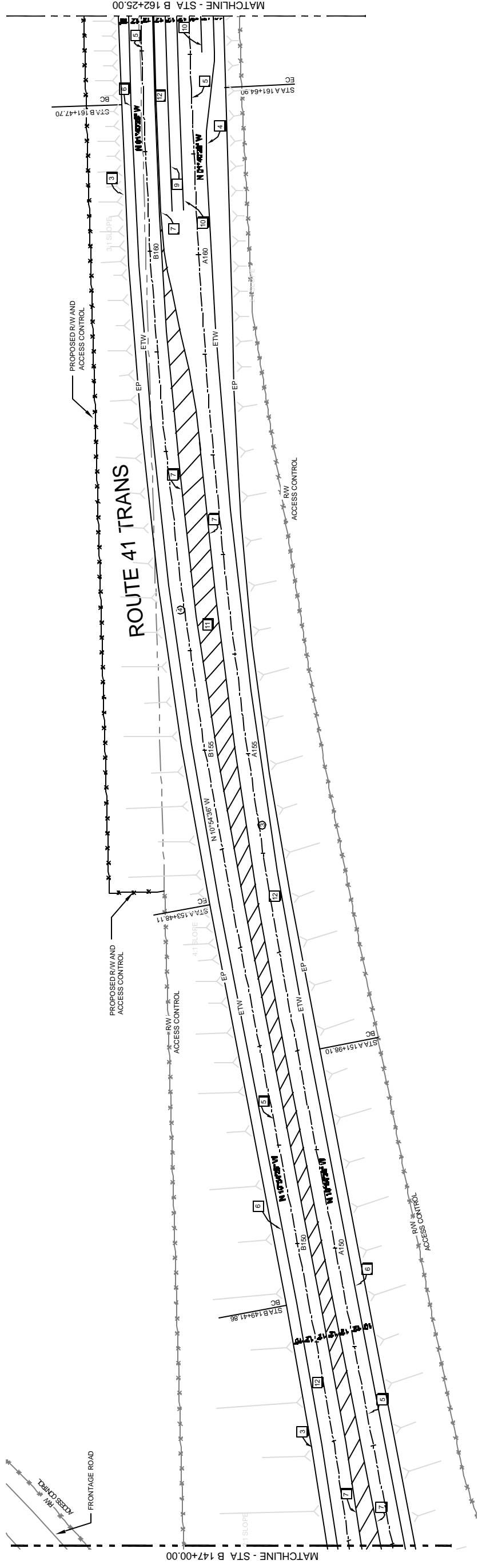

**TPG Consulting**  
 Visalia Office  
 1000 N. University Blvd, Suite 100  
 Visalia, CA 93291  
 Phone: (559) 735-1111  
 Fax: (559) 735-1112

**San Luis Obispo**  
 1000 N. University Blvd, Suite 100  
 Visalia, CA 93291  
 Phone: (559) 735-1111  
 Fax: (559) 735-1112

**Firearm Offices**  
 1000 N. University Blvd, Suite 100  
 Visalia, CA 93291  
 Phone: (559) 735-1111  
 Fax: (559) 735-1112

**Dublin Office**  
 1000 N. University Blvd, Suite 100  
 Visalia, CA 93291  
 Phone: (559) 735-1111  
 Fax: (559) 735-1112



**GATEWAY VILLAGE**  
 SR 41 EXPANSION  
 AVENUE 11 TO AVENUE 12  
 PRELIMINARY PLANLINE  
 AND PROFILE

### REVISIONS

Designed By: WB  
 Drawn By: JET  
 Checked By: WB  
 Scale: 1"=50'  
 Date: 03/05/07

File No: 95-250.5  
 Sheet: 4 of 9



### GENERAL NOTES

1. ALL WORK SHALL CONFORM TO THE STATE OF CALIFORNIA DEPARTMENT OF TRANSPORTATION STANDARD SPECIFICATIONS, DATED JULY 1989 AND STANDARD PLANS, DATED JULY 2004, AND THE SPECIAL PROVISIONS.
2. EXISTING FACILITIES ARE SHOWN BY REFERENCE TO RECORD DATA. THE ENGINEER ASSUMES NO LIABILITY FOR THE ACCURACY OR COMPLETENESS OF THE DATA.
3. ARRANGEMENTS SHALL BE MADE WITH UTILITY COMPANIES FOR ANY NECESSARY UTILITY RELOCATION INCLUDING OVERHEAD CONFLICTS.
4. THE LIMITS OF WORK ARE ENCOMPASSED BY THE EXISTING RIGHT-OF-WAY AND SHALL INCLUDE ONLY SUCH WORK AS IS SHOWN ON THIS PLAN.
5. ROADWAY ALIGNMENT AND DETAILS BASED ON CALTRANS STATE HIGHWAY DESIGN AS BUILT PLANS (122000) CONTRACT # 06-308514 (EA 308511).
6. DESIGN SPEED ALONG SR 41 FREEWAY AND EXPRESSWAY = 70 MPH DESIGN SPEED ON SR 41 HIGHWAY = 55 MPH.
7. THIS IS A PRELIMINARY PLANLINE FOR PLANNING PURPOSES ONLY.

Underground Service Alert

Call: TOLL FREE  
1-800-227-2600



**TWO WORKING DAYS BEFORE YOU DIG**

### ARROW LEGEND

TYPE I	
TYPE III (L)	
TYPE III (R)	
TYPE VI (L)	

### LINETYPE LEGEND

NORTH BOUND CENTERLINE		A100
SOUTH BOUND CENTERLINE		B100
PROPOSED EP		
EXISTING RIGHT OF WAY		
PROPOSED RW/ACCESS CONTROL		
EXISTING RW/ACCESS CONTROL		

### CONSTRUCTION NOTES

1. 90' PCC OVER 13.0" AGGREGATE BASE.
2. REMOVAL AND DISPOSAL OF EXISTING ASPHALT CONCRETE.
3. ASPHALT CONCRETE DIKE, TYPE A, PER STATE STANDARD PLAN A47B.
4. LEFT EDGE LINE, DETAIL 25, PER STATE STANDARD PLAN A20B.
5. LANE LINE, DETAIL 12, PER STATE STANDARD PLAN A20A.
6. RIGHT EDGE LINE, DETAIL 27B, PER STATE STANDARD PLAN A20B.
7. PAINTED MEDIAN ISLAND, DETAIL 38, PER STANDARD PLAN A20D.
8. REMOVE EXISTING STRIPING.
9. CHANNELIZATION LINE, DETAIL 38, PER STANDARD PLAN A20D.
10. CHANNELIZATION LINE, DETAIL 38A, PER STANDARD PLAN A20D.
11. CHANNELING CHEVRON, 12" WIDE @ 24 SPACING.
12. 6" ASPHALT CONCRETE OVER 12" AGGREGATE BASE.

PLAN SCALE = 1"=50'

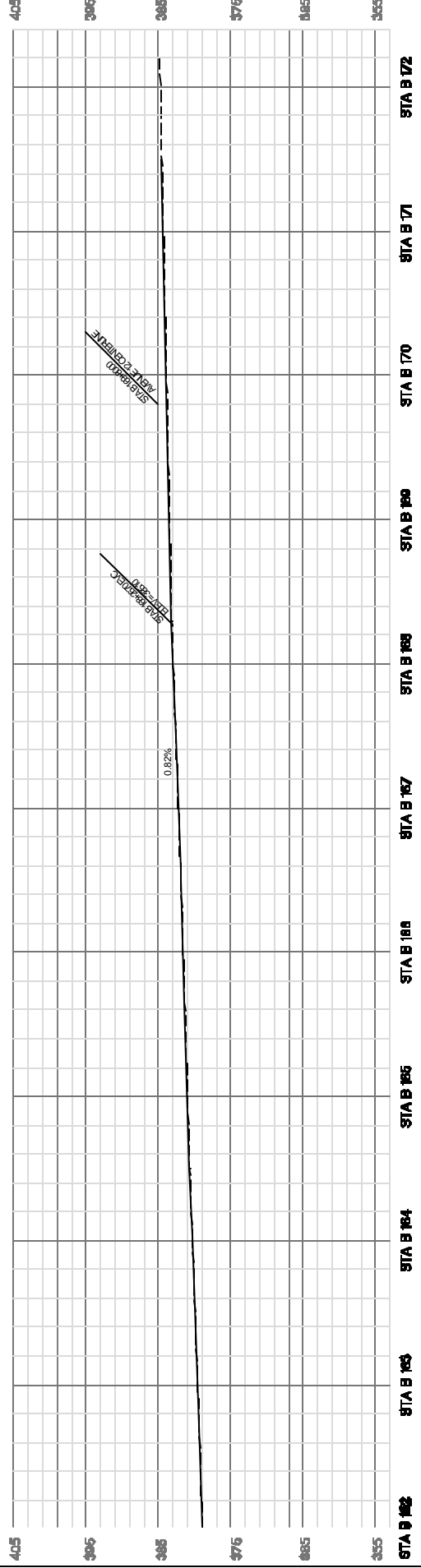
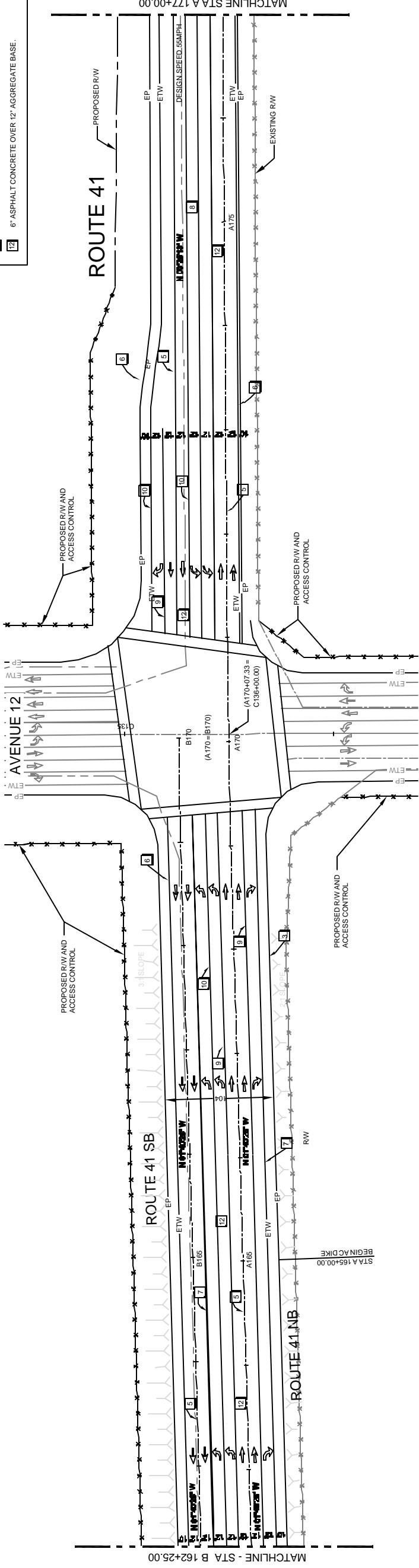

PROFILE SCALE:  
HOR. SCALE = 1"=100  
VERT. SCALE = 1"=10



**Vsalia Office**  
100 N. Sutter Street, Suite 600  
Vashti, California 95631  
Phone: (916) 279-1100  
Fax: (916) 279-1101  
www.tpg.com

**San Jose Office**  
100 N. Sutter Street, Suite 600  
Vashti, California 95631  
Phone: (916) 279-1100  
Fax: (916) 279-1101  
www.tpg.com

**Mobile Office**  
100 N. Sutter Street, Suite 600  
Vashti, California 95631  
Phone: (916) 279-1100  
Fax: (916) 279-1101  
www.tpg.com



GATEWAY VILLAGE  
SR 41 EXPANSION  
PRELIMINARY PLANLINE  
AND PROFILE  
AVENUE 11 TO AVENUE 12

### REVISIONS

Designed By:	WB
Drawn By:	JET
Checked By:	WB
Scale:	1"=50'
Date:	03/05/07

File No: 95-250.5

Sheet:

5 of 9

### GENERAL NOTES

- ALL WORK SHALL CONFORM TO THE STATE OF CALIFORNIA DEPARTMENT OF TRANSPORTATION STANDARD SPECIFICATIONS, DATED JULY 1999 AND STANDARD PLANS, DATED JULY 2004, AND THE SPECIAL PROVISIONS.
- EXISTING FACILITIES ARE SHOWN BY REFERENCE TO RECORD DATA. THE ENGINEER ASSUMES NO LIABILITY FOR THE ACCURACY OR COMPLETENESS OF THE DATA.
- ARRANGEMENTS SHALL BE MADE WITH UTILITY COMPANIES FOR ANY NECESSARY UTILITY RELOCATION INCLUDING OVERHEAD CONFLICTS.
- THE LIMITS OF WORK ARE ENCOMPASSED BY THE EXISTING RIGHT-OF-WAY AND SHALL INCLUDE ONLY SUCH WORK AS IS SHOWN ON THIS PLAN.
- ROADWAY ALIGNMENT AND DETAILS BASED ON CALTRANS STATE HIGHWAY DESIGN AS BUILT PLANS (122000) CONTRACT # 08-305514 (EA 305511).
- DESIGN SPEED ALONG SR 41 FREEWAY AND EXPRESSWAY = 70 MPH DESIGN SPEED ON SR 41 HIGHWAY = 55 MPH.
- THIS IS A PRELIMINARY PLANLINE FOR PLANNING PURPOSES ONLY.



### ARROW LEGEND

TYPE I	
TYPE III (L)	
TYPE III (R)	
TYPE VI (L)	



PLAN SCALE = 1"=30'

### LINE TYPE LEGEND

NORTH BOUND CENTERLINE		A100
SOUTH BOUND CENTERLINE		B100
PROPOSED EP		
EXISTING RIGHT OF WAY		
PROPOSED RW/ACCESS CONTROL		
EXISTING RW/ACCESS CONTROL		

### CONSTRUCTION NOTES

- 9.0' PCC COVER 13.0' AGGREGATE BASE.
- REMOVAL AND DISPOSAL OF EXISTING ASPHALT CONCRET.
- ASPHALT CONCRETE DIKE, TYPE A, PER STATE STANDARD PLAN A87B.
- LEFT EDGE LINE, DETAIL 25, PER STATE STANDARD PLAN A20B.
- LANE LINE, DETAIL 12, PER STATE STANDARD PLAN A20A.
- RIGHT EDGE LINE, DETAIL 27B, PER STATE STANDARD PLAN A20B.
- PAINTED MEDIAN ISLAND, DETAIL 38, PER STANDARD PLAN A20D.
- REMOVE EXISTING STRIPING.
- CHANNELIZATION LINE, DETAIL 38, PER STANDARD PLAN A20D.
- CHANNELING CHEVRON, 12" WIDE @ 24' SPACING.
- 6" ASPHALT CONCRETE OVER 12" AGGREGATE BASE.



GATEWAY VILLAGE  
SR 41 EXPANSION  
PRELIMINARY PLANLINE  
AND PROFILE  
AVENUE 11 TO AVENUE 12

### REVISIONS

Designed By:	WB
Drawn By:	JET
Checked By:	WB
Scale:	1"=50'
Date:	03/05/07

File No: 95-250.5  
Sheet: 6 of 9

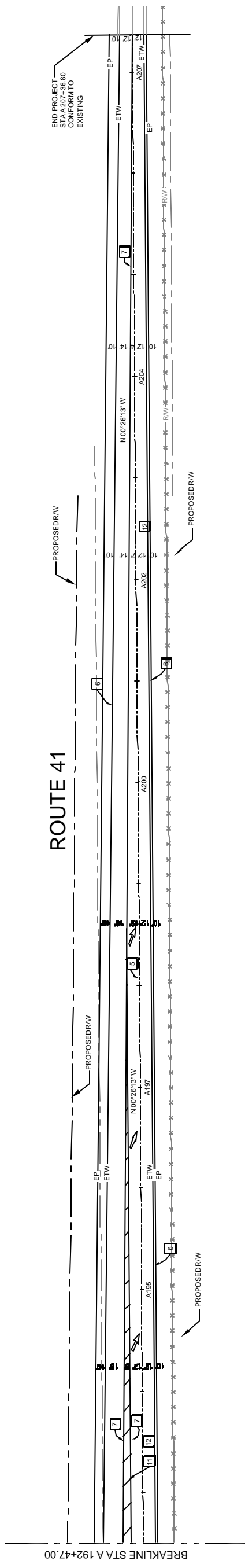
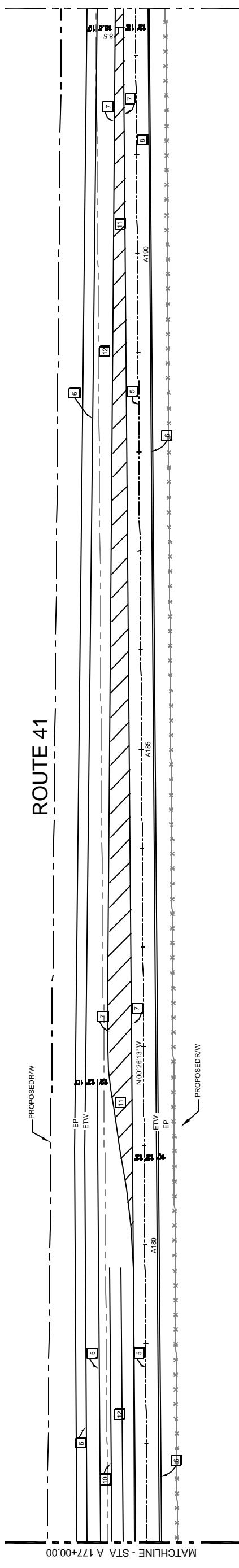

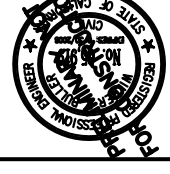

**GATEWAY VILLAGE  
 SR 41 EXPANSION  
 AVENUE 11 TO AVENUE 12  
 AND PROFILE**

REVISIONS	Description	By	Date

Designed By: WB  
 Drawn By: TLC  
 Checked By: WB  
 Scale: NTS  
 Date: 03/05/07

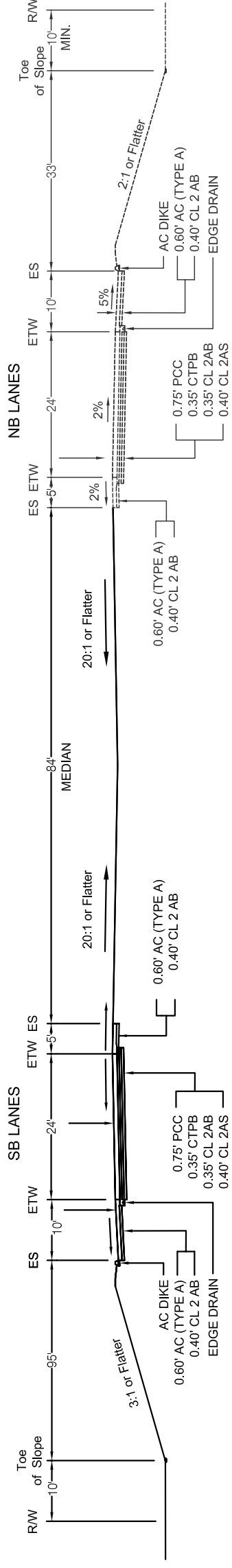

**ROUTE 41 NB AND SB LANES**

STA A102+80 TO A114+53.00 NB  
 STA B102+80 TO A114+53.00 SB  
 NTS

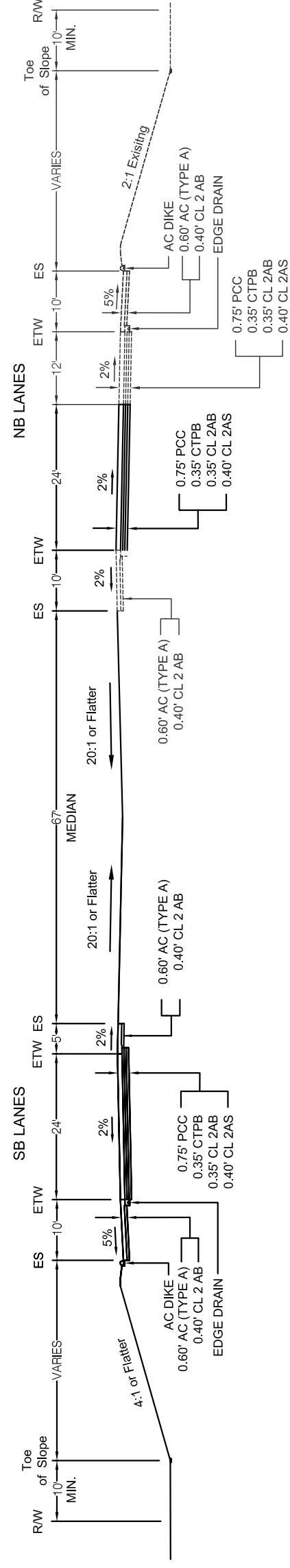

**ROUTE 41 NB AND SB LANES**

STA A114+53.00 TO A119+50.00 NB  
 STA B114+53.00 TO B119+50.00 SB  
 NTS

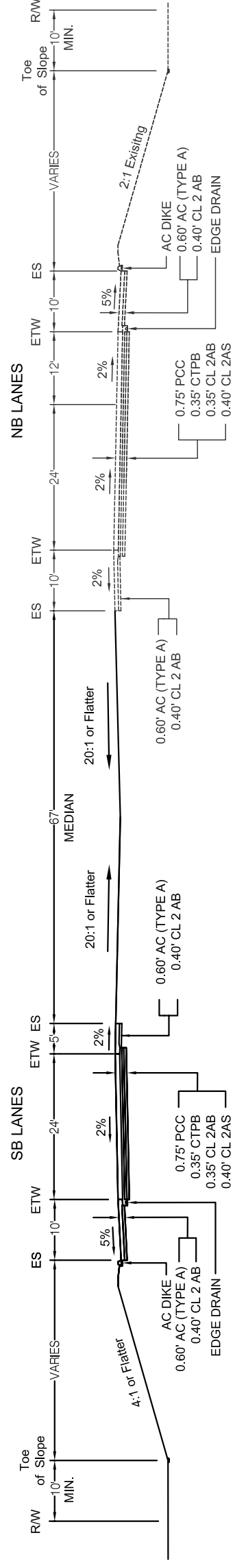

**ROUTE 41 NB AND SB LANES**

STA A119+50.00 TO A120+84.17 NB  
 STA B119+50.00 TO B120+80.98 SB  
 NTS

**Underground Service Alert**  
 CALL BEFORE YOU DIG  
 1-800-227-2600  
 Call: TOLL FREE

TWO WORKING DAYS BEFORE YOU DIG

- GENERAL NOTES**
- ALL WORK SHALL CONFORM TO THE STATE OF CALIFORNIA DEPARTMENT OF TRANSPORTATION STANDARD SPECIFICATIONS, DATED JULY 1999 AND STANDARD PLANS, DATED JULY 2004, AND THE SPECIAL PROVISIONS.
  - EXISTING FACILITIES ARE SHOWN BY REFERENCE TO RECORD DATA. THE ENGINEER ASSUMES NO LIABILITY FOR THE ACCURACY OR COMPLETENESS OF THE DATA.
  - ARRANGEMENTS SHALL BE MADE WITH UTILITY COMPANIES FOR ANY NECESSARY UTILITY RELOCATION INCLUDING OVERHEAD CONFLICTS.
  - THE LIMITS OF WORK ARE ENCOMPASSED BY THE EXISTING RIGHT-OF-WAY AND SHALL INCLUDE ONLY SUCH WORK AS IS SHOWN ON THIS PLAN.
  - ROADWAY ALIGNMENT AND DETAILS BASED ON CALTRANS STATE HIGHWAY DESIGN AS BUILT PLANS (1220000) CONTRACT # 06-305514 (EA-305511).
  - DESIGN SPEED ALONG SR 41 FREEWAY AND EXPRESSWAY = 70 MPH DESIGN SPEED ON SR 41 HIGHWAY = 55 MPH.
  - THIS IS A PRELIMINARY PLANLINE FOR PLANNING PURPOSES ONLY.





**GATEWAY VILLAGE  
 SR 41 EXPANSION  
 PRELIMINARY PLANLINE  
 AND PROFILE**

REVISIONS	Description	By	Date

Designed By: WB  
 Drawn By: TLC  
 Checked By: WB  
 Scale: NTS  
 Date: 03/05/07



**Underground Service Alert**  
 CALL BEFORE YOU DIG  
 1-800-227-2600

TWO WORKING DAYS BEFORE YOU DIG

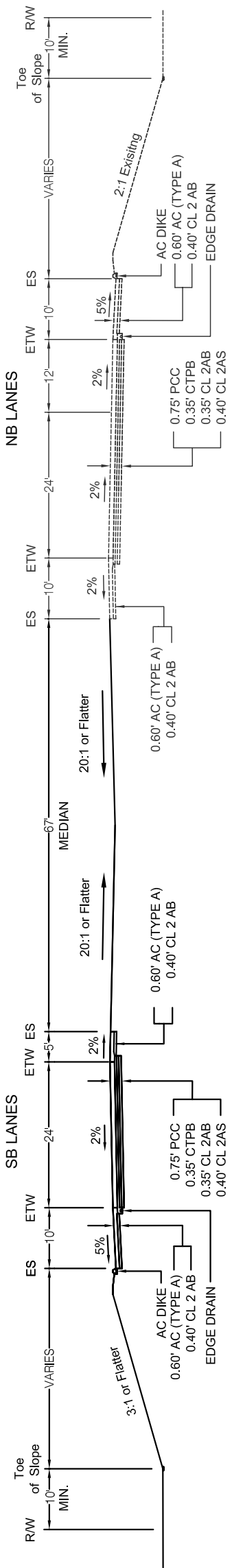

**ROUTE 41 NB AND SB LANES**

STA A122+74.64 to A132+42.00 NB  
 STA B122+71.51 to B132+42.00 SB  
 NTS

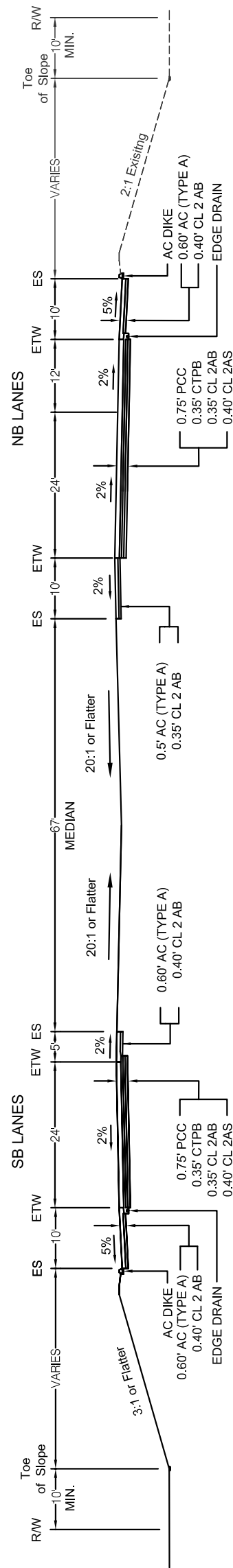

**ROUTE 41 NB AND SB LANES**

STA A132+42.00 to A137+68.63 NB  
 STA B132+42.00 to B137+68.63 SB  
 NTS

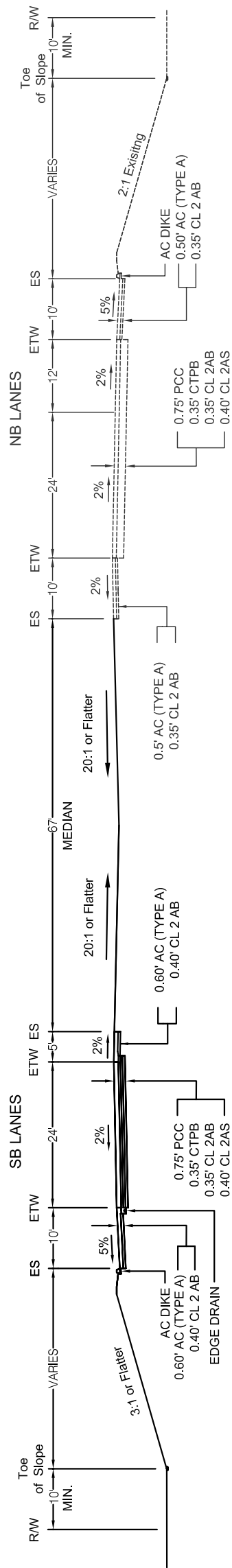

**ROUTE 41 NB AND SB LANES**

STA A137+68.63 to A142+81.72 NB  
 STA B137+68.63 to B142+20.45 SB  
 NTS

- GENERAL NOTES**
- ALL WORK SHALL CONFORM TO THE STATE OF CALIFORNIA DEPARTMENT OF TRANSPORTATION STANDARD SPECIFICATIONS, DATED JULY 1999 AND STANDARD PLANS, DATED JULY 2004, AND THE SPECIAL PROVISIONS.
  - EXISTING FACILITIES ARE SHOWN BY REFERENCE TO RECORD DATA. THE ENGINEER ASSUMES NO LIABILITY FOR THE ACCURACY OR COMPLETENESS OF THE DATA.
  - ARRANGEMENTS SHALL BE MADE WITH UTILITY COMPANIES FOR ANY NECESSARY UTILITY RELOCATION INCLUDING OVERHEAD CONFLICTS.
  - THE LIMITS OF WORK ARE ENCOMPASSED BY THE EXISTING RIGHT-OF-WAY AND SHALL INCLUDE ONLY SUCH WORK AS IS SHOWN ON THIS PLAN.
  - ROADWAY ALIGNMENT AND DETAILS BASED ON CALTRANS STATE HIGHWAY DESIGN AS BUILT PLANS (122000) CONTRACT # 06-305514 (EA 305511).
  - DESIGN SPEED ALONG SR 41 FREEWAY AND EXPRESSWAY = 70 MPH DESIGN SPEED ON SR 41 HIGHWAY = 55 MPH.
  - THIS IS A PRELIMINARY PLANLINE FOR PLANNING PURPOSES ONLY.

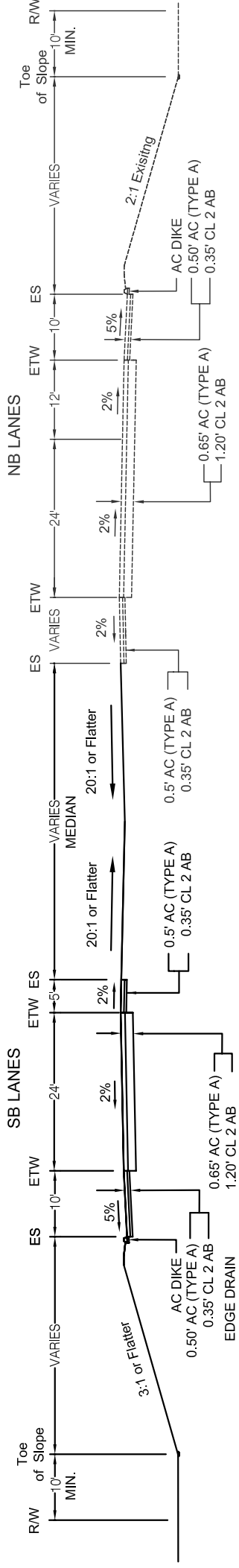

## ROUTE 41 NB AND SB LANES

STA A142+81.72 to A145+16.52 NB  
 STA B142+20.45 to B145+00.00 SB  
 NTS

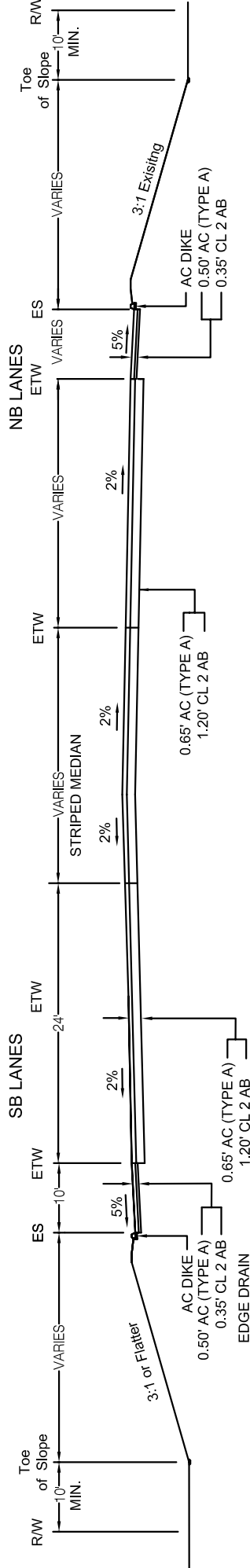

## ROUTE 41 NB AND SB LANES

STA A145+16.52 to A170+00.00 NB  
 STA B145+00.00 to B170+00.00 SB  
 NTS

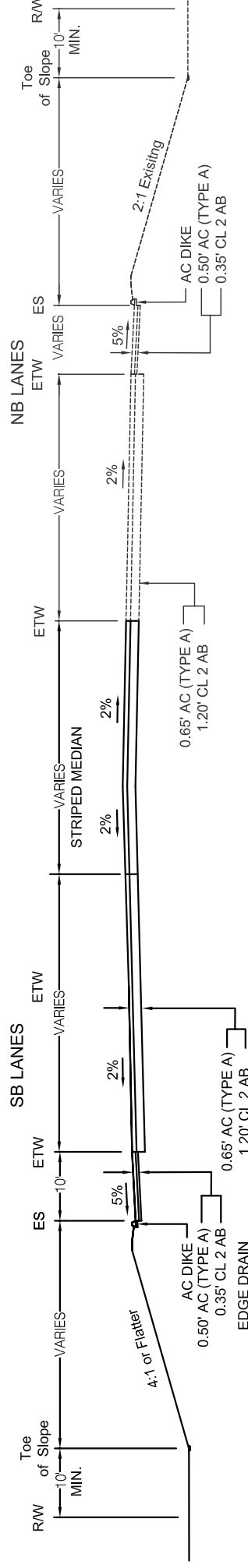

## ROUTE 41 NB AND SB LANES

STA A170+00.00 to A207+36.80 NB  
 STA B170+00.00 to B207+36.80 SB  
 NTS

GATEWAY VILLAGE  
 SR 41 EXPANSION  
 AVENUE 11 TO AVENUE 12  
 PRELIMINARY PLAN  
 AND PROFILE



**TPG Consulting Incorporated**  
**Visalia Office**  
 1000 Highway 99, Suite 100  
 Visalia, California 93291  
 Telephone 559.739.8072  
 Fax 559.739.8377  
**San Luis Obispo**  
 550 Highway 101, Suite 100  
 San Luis Obispo, California 93420  
 Telephone 805.547.7498  
 Fax 805.547.9598  
**Fresno Office**  
 8405 N Fresno Street, Suite 200  
 Fresno, California 93720  
 Telephone 559.432.4871  
 Fax 559.432.7554  
**Dallas Office**  
 6997 Laramie Blvd.  
 Dallas, Texas 75249  
 Telephone 801.996.3150  
 Fax 800.596.5570

**Underground Service Alert**  
 CALL BEFORE YOU DIG  
 Call: TOLL FREE  
 1-800-227-2600  
 TWO WORKING DAYS BEFORE YOU DIG

### GENERAL NOTES

1. ALL WORK SHALL CONFORM TO THE STATE OF CALIFORNIA DEPARTMENT OF TRANSPORTATION STANDARD SPECIFICATIONS, DATED JULY 1999 AND STANDARD PLANS, DATED JULY 2004, AND THE SPECIAL PROVISIONS.
2. EXISTING FACILITIES ARE SHOWN BY REFERENCE TO RECORD DATA. THE ENGINEER ASSUMES NO LIABILITY FOR THE ACCURACY OR COMPLETENESS OF THE DATA.
3. ARRANGEMENTS SHALL BE MADE WITH UTILITY COMPANIES FOR ANY NECESSARY UTILITY RELOCATION INCLUDING OVERHEAD CONFLICTS.
4. THE LIMITS OF WORK ARE ENCOMPASSED BY THE EXISTING RIGHT-OF-WAY AND SHALL INCLUDE ONLY SUCH WORK AS IS SHOWN ON THIS PLAN.
5. ROADWAY ALIGNMENT AND DETAILS BASED ON CALTRANS STATE HIGHWAY DESIGN AS BUILT PLANS (12/20/00) CONTRACT # 06-308514 (EA 308511).
6. DESIGN SPEED ALONG SR 41 FREEWAY AND EXPRESSWAY = 70 MPH DESIGN SPEED ON SR 41 HIGHWAY = 55 MPH.
7. THIS IS A PRELIMINARY PLANLINE FOR PLANNING PURPOSES ONLY.

REVISIONS	Description	By	Date

Designed By: WB  
 Drawn By: TLC  
 Checked By: WB  
 Scale: NTS  
 Date: 03/05/07

