

# CORNER RECORD

Agency Index \_\_\_\_\_

Document Number \_\_\_\_\_

City of UNINCORPORATED County of MADERA, California

Brief Legal Description LOT 1916 OF YOSEMITE LAKES PARK, BOOK 16 OF MAPS AT PAGES 37-70, M.C.R.

	CORNER TYPE		COORDINATES (Optional)		
	Government Corner	<input type="checkbox"/>	Control	<input type="checkbox"/>	N. _____ E. _____
	Meander	<input type="checkbox"/>	Property	<input checked="" type="checkbox"/>	Elevation _____
	Rancho	<input type="checkbox"/>	Other	<input type="checkbox"/>	Units Metric <input type="checkbox"/> U.S. Survey Foot <input checked="" type="checkbox"/>
Date of Survey <u>DECEMBER 12, 2017</u>				Horizontal Datum _____	
				Zone _____ Epoch Date _____	
				Vertical Datum _____	
				<input type="checkbox"/> Complies with Public Resources Code §§8801-8819	
				<input type="checkbox"/> Complies with Public Resources Code §§8890-8902	

SEC. 26, T.8S., R20E., MDM

PLS Act Ref.:	<input checked="" type="checkbox"/> 8765(d)	<input type="checkbox"/> 8771	<input type="checkbox"/> 8773	<input type="checkbox"/> Other:
Corner/ Monument:	<input type="checkbox"/> Left as found	<input type="checkbox"/> Established	<input type="checkbox"/> Rebuilt	<input type="checkbox"/> Pre-Construction
	<input type="checkbox"/> Found and tagged	<input checked="" type="checkbox"/> Reestablished	<input type="checkbox"/> Referenced	<input type="checkbox"/> Post-Construction

Narrative of corner identified and monument as found, set, reset, replaced, or removed:

See sheet #2 for description(s):

### SURVEYOR'S STATEMENT

This Corner Record was prepared by me or under my direction in conformance with

the Professional Land Surveyors' Act on DECEMBER 13, 2017.

Signed  P.L.S. or R.C.E. No. PLS 8393

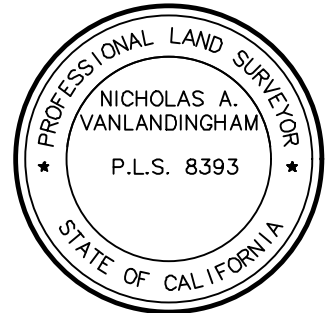

### COUNTY SURVEYOR'S STATEMENT

This Corner Record was received December 13, 2017

and examined and filed December 15, 2017.

Signed  P.L.S. or R.C.E. No. PLS 6968

Title Acting County Surveyor

County Surveyor's Comment





SCALE 1"=60'

# CORNER RECORD

LOT 1916 OF YOSEMITE LAKES PARK  
RECORDED IN BOOK 16 OF MAPS AT PAGES 37-70, M.C.R.  
LOCATED IN SECTION 26, 8/20

SEARCHED  
FOR NOT FOUND

SET 5/8" REBAR  
W/ CAP PLS 8393

LOT 1917

N44°09'40"E 283.24'  
(S44°11'26"W 283.15')(1)

(L=34.79' R=230.00')  
(Δ=8°40'00")(1)(M)

BEAR PAW CT  
BEAR PAW WAY  
Basis of Bearings  
60'(1)(M)  
60'(1)(M)

LOT 1916

N29°10'43"W 174.88'  
(S29°10'00"E 175.00')(1)

N48°49'33"E 316.00'  
(S48°50'00"W 315.98')(1)

(S41°10'00"E 133.57')(1)(M)

LOT 1915

SET 5/8" REBAR  
W/ CAP PLS 8393

S29°10'43"E 64.95'  
(S29°10'00"E 65.00')(1)

## LEGEND

- FOUND MONUMENT PER RECORD MAP
- SET 5/8" REBAR, W/CAP, MARKED "PLS 8393"
- PROPERTY LINE
- ADJOINING PROPERTY LINE
- - - RIGHT-OF-WAY CENTERLINE
- (...)(1) DATA PER BK. 16, PG. 37-70, M.C.R.

JONES SNYDER & ASSOCIATES  
P.O. BOX 2292, OAKHURST, CA 93644  
(559)683-7661 WWW.JSSURVEYING.COM

DATE: 12/15/17 BY: NAV

FILE:C:\Users\Owner\appdata\local\temp\AcPublish\_2436\CORNER-RECORD.dwg