

# CORNER RECORD

COUNTY OF Madera T. 8 S R. 20 E Mt. Diablo MERIDIAN CALIFORNIA

CORNER TYPE: GOV'T. CORNER  MEANDER  RANCHO  CONTROL  OTHER

CORNER IDENTIFICATION — DATE OF VISIT 10 Sep 19 74

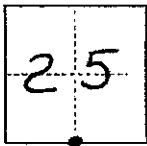

CORNER — LEFT AS FOUND  FOUND AND TAGGED  REESTABLISHED OBLITERATED CORNER  REBUILT

PHYSICAL DESCRIPTION OF CORNER FOUND; EVIDENCE AND METHOD USED TO IDENTIFY OR REESTABLISH

Fd. 1" diam. steel axle, up 0<sup>2</sup>' w/ 2 bearing trees.

PHYSICAL DESCRIPTION OF MONUMENTS REBUILT OR PERPETUATED

CALIFORNIA COORDINATE SYSTEM ORDER: FIRST  SECOND  THIRD   
 STATIONS USED: NGS (USC & GS)  STATE  COUNTY  OTHER  STATION \_\_\_\_\_ STATION \_\_\_\_\_  
 ZONE \_\_\_\_\_ ELEVATION \_\_\_\_\_ NORTHINGS (Y) \_\_\_\_\_ EASTINGS (X) \_\_\_\_\_

SKETCH: (Include reference tie or witness points, remarks and topo of area)

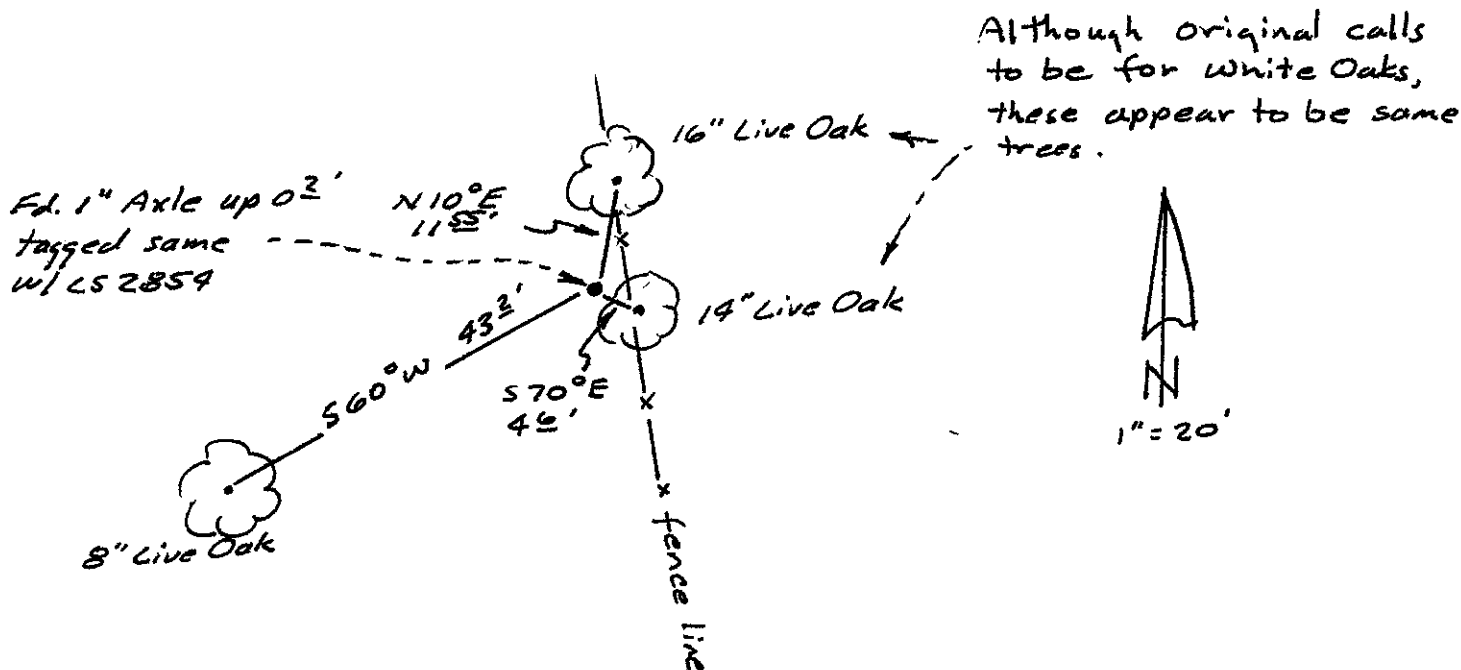

**SURVEYOR'S CERTIFICATE**

THIS CORNER RECORD WAS PREPARED BY ME OR UNDER MY DIRECTION IN CONFORMANCE WITH THE LAND SURVEYORS ACT ON Sept 16 1974.

SIGNED: J. E. Shepherd

L.S. or R.G.E. No.: 2854

SEAL

**COUNTY SURVEYOR'S CERTIFICATE**

THE CORNER RECORD WAS RECEIVED Oct. 14 1974 AND EXAMINED AND FILED Oct. 23 1974

BY: Albert O. Grote

TITLE: County Engineer

DOCUMENT No. 74-24-4

STATEMENT ON BACK OF SHEET

YES  NO

Note: By a previous survey, R/S Book 14, page 9, MCR, a monument for the same corner is a 2" I.P. with brass cap Tagged RCE 12406 N 21° 33' 38" W 104.41 feet from this newly set monument. However, this new monument is set at a point that fits 2 original bearing trees.

0820640200