

CORNER RECORD

COUNTY OF MADERA T. 85 R. 20 E. M.D.B. & MERIDIAN CALIF.

CORNER TYPE: GOV'T. CORNER () MEANDER () RANCHO () CONTROL () OTHER ()

CORNER IDENTIFICATION --- DATE OF VISIT 10 MAY 19 76



1/4 Section 2/8/20

A CHISELED X IN A GRANITE STONE 8" X 16" X 32", 10.60 WEST OF N-S FENCELINE.

CORNER -- LEFT AS FOUND () FOUND & TAGGED () REESTABLISHED OBLITERATED CORNER () REBUILT ()

PHYSICAL DESCRIPTION OF CORNER FOUND: EVIDENCE & METHOD USED TO IDENTIFY OR REESTABLISH:

FOUND ORIGINAL BEARING TREE FOR CORNER
SEE BELOW.

PHYSICAL DESCRIPTION OF MONUMENTS REBUILT OR PERPETUATED:

LEFT AS FOUND.

CALIFORNIA COORDINATE SYSTEM ORDER: FIRST () SECOND () THIRD ()

STATIONS USED: NOS (USC & GS) () STATE () COUNTY () OTHER () STATION _____

STATION _____ ZONE _____ ELEVATION _____ NORTHINGS (Y) _____

EASTINGS (X) _____

SKETCH: (INCLUDE REFERENCE TIE OR WITNESS POINTS, REMARKS AND TOPO OF AREA)

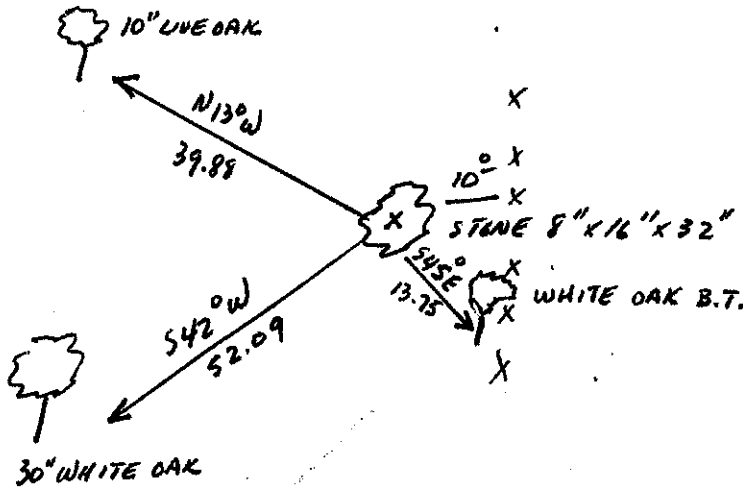

SURVEYOR'S CERTIFICATE

THIS CORNER RECORD WAS PREPARED BY ME OR UNDER MY DIRECTION IN CONFORMANCE WITH THE LAND SURVEYORS ACT ON _____

12 MAY 1976

SIGNED

J. M. Jensen

L.S. or R.C.E. NO. _____

L.S. 4261

NO. 4261

SEAL

COUNTY SURVEYOR'S CERTIFICATE

THE CORNER RECORD WAS RECEIVED 5-17-76 AND

EXAMINED & FILED MAY 17 1976

BY: A. Grote

TITLE: County Engineer

DOCUMENT NO. 76-12-4

STATEMENT ON BACK OF SHEET

YES () NO ()

