

T 7S R. 23E

R.D. \_\_\_\_\_

County Madera

Merid. \_\_\_\_\_

N.F. \_\_\_\_\_

State CA

CORNER DIAGRAM

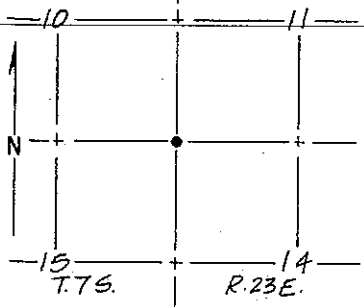

DESCRIBE CORNER MONUMENT FOUND

Found a 3" x 3" post in a rock mound.

DESCRIBE BEARING TREES OR OTHER OFFICIAL ACCESSORIES FOUND

I found a 51" fir (30" fir S 14° E. 10 lks) snag and a 38" S. pine (14" S. Pine S 36° W. 39 lks).

PHOTO IDENTIFICATION DATA

Photo No. \_\_\_\_\_

Filed At. \_\_\_\_\_

Object Ident. \_\_\_\_\_

Ident. By \_\_\_\_\_

Signature

7

PLANE COORDINATE POSITION DATA

State \_\_\_\_\_ Zone \_\_\_\_\_

Estab. By \_\_\_\_\_

Agency

8

DESCRIBE CORNER LOCATION RELATIVE TO NEAR-BY FEATURES, ALSO HOW TO REACH CORNER  
From Road 7S02 turn southerly on Road 7S03 approx. 1/10 mile to a stock trail heading easterly. Follow approximately 1/5 mile past an old rail bed and turn southerly on a stock trail approximately 1/5 mile to corner.

Signature

Title

Division

Headquarters

Date

FS-7100-52 (3/68)

*[Handwritten Signature]*

LS 4298

10/7/87

CORNER RECORD (PERPETUATION)

MONUMENT: DESCRIBE NEW MONUMENT SET, OR WORK DONE TO PRESERVE EXISTING MONUMENT

Reset with a U.S.F.S. monument in a rock mound. Marked corner to Sec. 10, Sec. 11, Sec. 14, and Sec. 15, T. 7S., R. 23E.

ACCESSORIES: DESCRIBE NEW BY'S WITNESS OBJECTS ETC. ESTABLISHED, OR WORK DONE TO PRESERVE EXISTING EVIDENCE

I blazed a 16" fir N 67° W. 55.35' and a 26" fir S 77° E., 31.30'. I measured a 51" fir S. 14° E. 6.6' and a 38" S. pine S. 30° W., 25.50'. I set a U.S.F.S. post N. 45° E. 3.0'.

Work Done By Jones

Title surveyor

Date 8-11-

State Registration No. LS 4298  
or Agency

Certified Cor. Record Prepared? Yes No

Filed At: \_\_\_\_\_

Date \_\_\_\_\_

REMARKS

Index File No.

T.

R.

M.

Tract or Surv. No.

Cor.