

3X No. _____

CORNER RECORD (SEARCH)
(Ref. FSM 7151.4)

Tract or Survey No. _____

Cor. No. E 14

T 7S R. 23E

R.D. _____ County _____

Madera

Merid. _____ N.F. _____

State CA

CORNER DIAGRAM

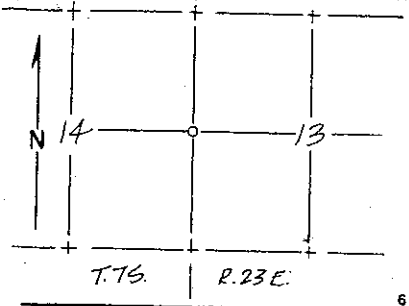

DESCRIBE CORNER MONUMENT FOUND

None found.

DESCRIBE BEARING TREES OR OTHER OFFICIAL ACCESSORIES FOUND

None found

PHOTO IDENTIFICATION DATA

Photo No. _____
 Filed At. _____
 Object Ident. _____
 Ident. By _____
Signature

DESCRIBE CORNER LOCATION RELATIVE TO NEAR-BY FEATURES, ALSO HOW TO REACH CORNER

From Road 7S02 turn southerly on Road 7S03 for approx. 2-1/5 miles to a road bearing east. Head east approximately 1 mile to K-tag. Go north to corner in heavy logging area.

PLANE COORDINATE POSITION DATA

State _____ Zone _____
 X _____
 Y _____
 Estab. By _____
Agency

Signature *[Signature]* Title _____ Division LS4206 Headquarters _____ Date 10/7/87 FS-7100-52 (3/68)

CORNER RECORD (PERPETUATION)

MONUMENT: DESCRIBE NEW MONUMENT SET, OR WORK DONE TO PRESERVE EXISTING MONUMENT

I set a U.S.F.S. monument in a rock mound marked 1/4 corner to Section 13 and Section 14, T 7S, R 23E.

ACCESSORIES: DESCRIBE NEW BT'S WITNESS OBJECTS ETC. ESTABLISHED, OR WORK DONE TO PRESERVE EXISTING EVIDENCE

I blazed a 30" S. pine N 22° E 56.41', a 6" fir S 59° E, 7.51' and an 8" fir S 63° W, 16.19'. I set a U.S.F.S. post N 45° W. 2.0'.

Work Done By _____ Title _____ Date _____ State Registration No. or Agency _____
 Certified Cor. Record Prepared? Yes No Filed At: _____ Date _____

REMARKS

Index File No. T. R. M. Tract or Surv. No. Cor.