

# CORNER RECORD

COUNTY OF MADERA T. 7S. R. 22E M.D. \_\_\_\_\_ MERIDIAN \_\_\_\_\_ CALIFORNIA

CORNER TYPE: GOVT. CORNER  MEANDER  RANCHO  CONTROL  OTHER

CORNER IDENTIFICATION - DATE OF VISIT April 22 19 81



NW corner Section 22 7/22

CORNER - LEFT AS FOUND  FOUND AND TAGGED  REESTABLISHED OBLITERATED CORNER  REBUILT

**PHYSICAL DESCRIPTION OF CORNER FOUND; EVIDENCE AND METHOD USED TO IDENTIFY OR REESTABLISH**

RECORD: Post 4" square, 2' in earth, 2' above it  
 Field notes W.F. Benson; U.S. Surveyor, 1878.  
 FOUND & : 2 1/4" O.D. iron pipe with brass cap up 9" in 2' dia. rock  
 ACCEPTED mound. Two original bearing trees and remains of two others.

**PHYSICAL DESCRIPTION OF MONUMENTS REBUILT OR PERPETUATED**

Left fd. monument in place. Painted the pipe red. Set fiberglass sign post 4' from the monument with a Forest Service corner "Attention" sign attached.

CALIFORNIA COORDINATE SYSTEM ORDER: FIRST  SECOND  THIRD

STATIONS USED: NGS (USC & GS)  STATE  COUNTY  OTHER  STATION \_\_\_\_\_ STATION \_\_\_\_\_

ZONE \_\_\_\_\_ ELEVATION \_\_\_\_\_ NORTHINGS (Y) \_\_\_\_\_ EASTINGS (X) \_\_\_\_\_

**SKETCH: (Include reference tie or witness points, remarks and topo of area)**

CORNER TIES

- N 44° 44' E, 12.49 Ft., to an 11.6" White Fir
- S 14° 01' E, 20.88 Ft., to a 10.2" Incense Cedar
- S 88° 49' E, 48.51 Ft., to a 41.6" Black Oak (Original Bearing Tree)
- S 50° 07' W, 20.76 Ft. to a 19.4" Black Oak
- N 38° 05' W, 16.62 Ft., to a 18.8" Black Oak (Original Bearing Tree)

CAP INSCRIPTION

LS 4689  
 T7S R22E  
 S16 S15  
 S21 S22  
 1960  
 W.O. GENTRY

Bearings are to the center of trees at base; distances are horizontal to nail and tag (stamped LS 4689) driven into base of trees, unless noted otherwise.

Posted Forest Service Monument and Bearing Tree signs.

Blazed and scribed trees and stamped monument in accord with Bureau of Land Management 1973 "Manual of Surveying Instructions."

N - 13  
 1 08

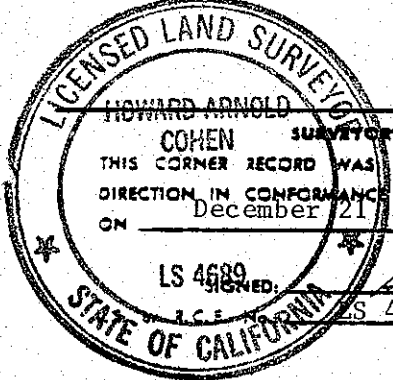

**SURVEYOR'S CERTIFICATE**  
 THIS CORNER RECORD WAS PREPARED BY ME OR UNDER MY DIRECTION IN CONFORMANCE WITH THE LAND SURVEYORS ACT ON December 21 19 81  
 SIGNED: Howard Arnold Cohen  
 LS 4689

**COUNTY SURVEYOR'S CERTIFICATE**  
 THE CORNER RECORD WAS RECEIVED \_\_\_\_\_ 19 \_\_\_\_\_ AND EXAMINED AND FILED \_\_\_\_\_ 19 \_\_\_\_\_  
 BY: [Signature]  
 TITLE: \_\_\_\_\_  
 DOCUMENT No. \_\_\_\_\_  
 STATEMENT ON BACK OF SHEET