

CORNER RECORD

COUNTY OF MADERA T. 7S. R. R2E. M.D.B. & M. MERIDIAN CALIF.

CORNER TYPE: GOV'T. CORNER () MEANDER () RANCHO () CONTROL () OTHER ()

CORNER IDENTIFICATION --- DATE OF VISIT 15 FEB. 1977 19 77

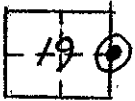

E 1/4 COR. SEC. 19 T. 7S, R. 2E, M.D.B. & M.

G.L.O. 2" BRASS CAP IN N-S FENCE.

CORNER -- LEFT AS FOUND () FOUND & TAGGED () REESTABLISHED OBLITERATED CORNER ()
REBUILT ()

PHYSICAL DESCRIPTION OF CORNER FOUND: EVIDENCE & METHOD USED TO IDENTIFY OR REESTABLISH:
2 1/2" BRASS CAP STAMPED G.L.O., FOR E 1/4 SEC. 19 IN 2" IRON PIPE IN N-S FENCE LINE, STAMPED 1917 SURVEY.

PHYSICAL DESCRIPTION OF MONUMENTS REBUILT OR PERPETUATED:

CALIFORNIA COORDINATE SYSTEM ORDER: FIRST () SECOND () THIRD ()
STATIONS USED: NOS (USC & GS) () STATE () COUNTY () OTHER () STATION _____
STATION _____ ZONE _____ ELEVATION _____ NORTHINGS (Y) _____
EASTINGS (X) _____

SKETCH: (INCLUDE REFERENCE TIE OR WITNESS POINTS, REMARKS AND TOPO OF AREA)

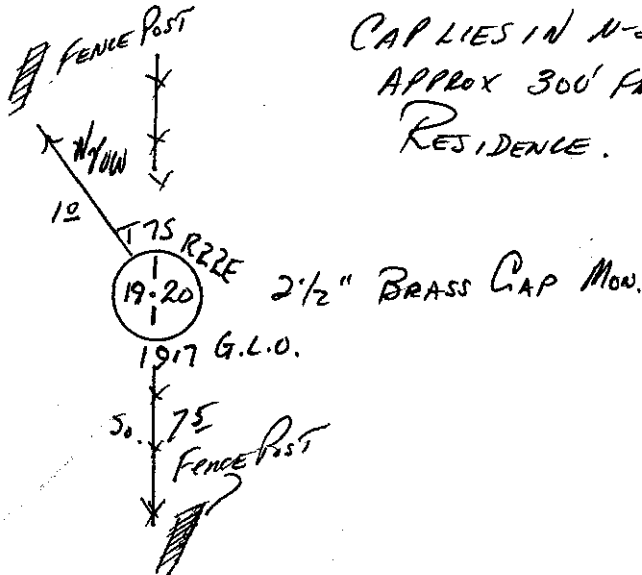

SURVEYOR'S CERTIFICATE

THIS CORNER RECORD WAS PREPARED BY ME OR UNDER MY DIRECTION IN CONFORMANCE WITH THE LAND SURVEYORS ACT ON 15 APRIL 1977

L. M. JENSEN

SIGNED

S. or R.C.E. NO. L.S. 4261

NO. 4261

SEAL

COUNTY SURVEYOR'S CERTIFICATE

THE CORNER RECORD WAS RECEIVED 5-9-77 AND EXAMINED AND FILED May 16 1977

BY: A. Grote

TITLE: Co. Engr.

DOCUMENT NO. 77-08-07

STATEMENT ON BACK OF SHEET

YES () NO (X)