

CORNER RECORD

COUNTY OF MADERA T. 7S R. 22E M.D.B. & MERIDIAN CALIF.

CORNER TYPE: GOV'T. CORNER () MEANDER () RANCHO () CONTROL () OTHER ()

CORNER IDENTIFICATION --- DATE OF VISIT 5 APRIL 1976 1976

C/4 OF SECTION 17 T 7S R 22E M.D.B. & M.

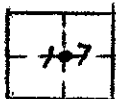

CORNER -- LEFT AS FOUND () FOUND & TAGGED () REESTABLISHED OBLITERATED CORNER ()
REBUILT ()

PHYSICAL DESCRIPTION OF CORNER FOUND: EVIDENCE & METHOD USED TO IDENTIFY OR REESTABLISH:

1" I.P. TAGGED R.C.E. 5982 WEST OF FENCE LINE.

PHYSICAL DESCRIPTION OF MONUMENTS REBUILT OR PERPETUATED:

CALIFORNIA COORDINATE SYSTEM ORDER: FIRST () SECOND () THIRD ()

STATIONS USED: NOS (USC & GS) () STATE () COUNTY () OTHER () STATION _____

STATION _____ ZONE _____ ELEVATION _____ NORTHINGS (Y) _____

EASTINGS (X) _____

SKETCH: (INCLUDE REFERENCE TIE OR WITNESS POINTS, REMARKS AND TOPO OF AREA)

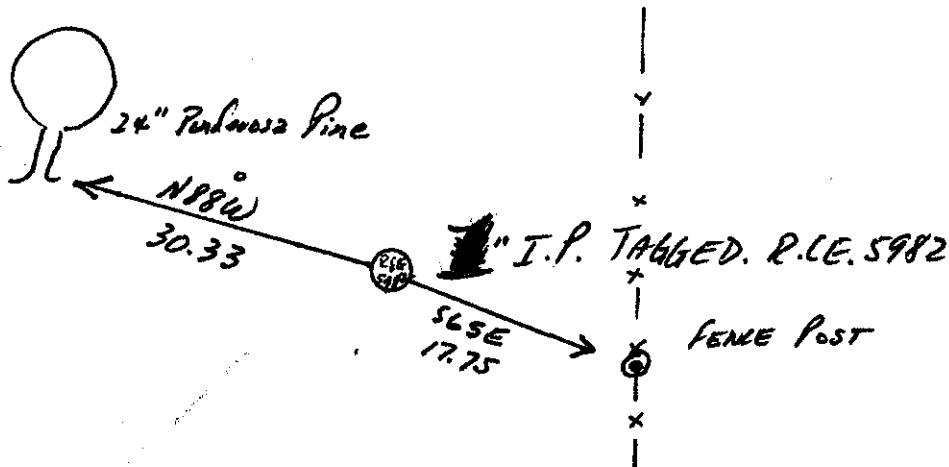

SURVEYOR'S CERTIFICATE

THIS CORNER RECORD WAS PREPARED BY ME
UNDER MY DIRECTION IN CONFORMANCE
WITH THE LAND SURVEYORS ACT ON 5 MAY
L. M. JENSEN 1976

SIGNED
L. S. or R. C. E. NO. 4261

L. M. Jensen
L.S. 4261

SEAL

COUNTY SURVEYOR'S CERTIFICATE

THE CORNER RECORD WAS RECEIVED 5-6

May 11 1976

BY: A. Grote

TITLE: County Engineer

DOCUMENT NO. 76-11-2

STATEMENT ON BACK OF SHEET

YES () NO ()