

CORNER RECORD

COUNTY OF MADERA T. 7S R. 22E M.D. _____ MERIDIAN _____ CALIFORNIA _____
 CORNER TYPE: GOVT. CORNER MEANDER RANCHO CONTROL OTHER
 CORNER IDENTIFICATION - DATE OF VISIT April 9 1981

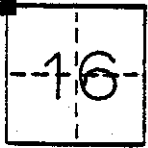

Northwest corner Section 16 7/22

CORNER - LEFT AS FOUND FOUND AND TAGGED REESTABLISHED OBLITERATED CORNER RESULT

PHYSICAL DESCRIPTION OF CORNER FOUND; EVIDENCE AND METHOD USED TO IDENTIFY OR REESTABLISH

RECORD: Iron pipe 3' long, 2" dia., 24" in the ground with brass cap
 Field notes of A.W. Brown, U.S. Surveyor, March 1917
 FOUND & : GLO brass cap on 2" O.D. iron pipe, and
 ACCEPTED five original bearing trees

PHYSICAL DESCRIPTION OF MONUMENTS RESULT OR PERPETUATED

Left GLO monument in place. Painted the 2" pipe red. Set fiberglass post 4' from the monument with a Forest Service "Attention" sign attached.

CALIFORNIA COORDINATE SYSTEM ORDER: FIRST SECOND THIRD
 STATIONS USED: NGS (USC & GS) STATE COUNTY OTHER STATION _____ STATION _____
 ZONE _____ ELEVATION _____ NORTHINGS (Y) _____ EASTINGS (X) _____

SKETCH: (Include reference tie or witness points, remarks and topo of area)

CORNER TIES

CAP INSCRIPTION

- N 68° 03' E, 28.89 Ft. to a 16.5" Ponderosa Pine (Original Bearing Tree) T7S R22E
- S 63° 48' E, 16.64 Ft. to a 13.5" Ponderosa Pine (Original Bearing Tree) S 8 S 9
- S 27° 17' W, 25.84 Ft. to a 19.8" Ponderosa Pine (Original Bearing Tree) S17 S16
- N 09° 37' W, 12.03 Ft. to a 17.2" Ponderosa Pine (Original Bearing Tree) 1917
- N 33° 06' W, 54.83 Ft. to a 26.1" Black Oak (Original Bearing Tree)

Bearings are to the center of trees at base; distances are horizontal to nail and tag (stamped LS 4689) driven into base of trees, unless noted otherwise.

Posted Forest Service Monument and Bearing Tree signs.

Blazed and scribed trees and stamped monument in accord with Bureau of Land Management 1973 "Manual of Surveying Instructions."

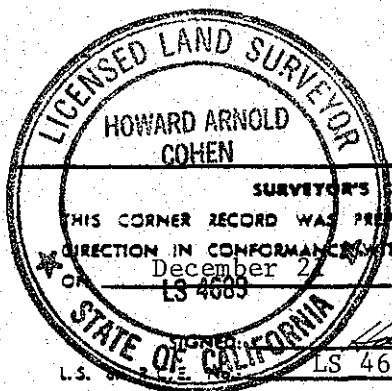

SURVEYOR'S CERTIFICATE
 THIS CORNER RECORD WAS PREPARED BY ME OR UNDER MY DIRECTION IN CONFORMANCE WITH THE LAND SURVEYORS ACT OF _____ 1981
 OF LS 4689
 SIGNED Howard Arnold Cohen
 L.S. LS 4689

J - 9
 I 03

COUNTY SURVEYOR'S CERTIFICATE
 THE CORNER RECORD WAS RECEIVED _____ 19____
 AND EXAMINED AND FILED _____
 BY [Signature]
 TITLE: _____
 DOCUMENT No. _____
 STATEMENT ON BACK OF SHEET