

# CORNER RECORD

COUNTY OF MADERA T. 7S R. 22E M.D. \_\_\_\_\_ MERIDIAN CALIFORNIA  
 CORNER TYPE: GOV'T. CORNER  MEANDER  RANCHO  CONTROL  OTHER   
 CORNER IDENTIFICATION — DATE OF VISIT December 19 81



Northeast 1/16 corner Section 16 7/22  
 (SW corner of the NE NE Section 16 7/22)

CORNER — LEFT AS FOUND  FOUND AND TAGGED  REESTABLISHED OBLITERATED CORNER  RESULT

**PHYSICAL DESCRIPTION OF CORNER FOUND; EVIDENCE AND METHOD USED TO IDENTIFY OR REESTABLISH**

FOUND: A 2" O.D. iron pipe untagged. Not accepted  
 Corner postion established by section subdivision survey

**PHYSICAL DESCRIPTION OF MONUMENTS RESULY OR PERPETUATED**

Set a 30" long aluminum monument with a 3 1/4" aluminum cap stamped with the Forest Service logo, the date (1981) and LS 4689.

CALIFORNIA COORDINATE SYSTEM ORDER: FIRST  SECOND  THIRD   
 STATIONS USED: NGS (USC & GS)  STATE  COUNTY  OTHER  STATION \_\_\_\_\_ STATION \_\_\_\_\_  
 ZONE \_\_\_\_\_ ELEVATION \_\_\_\_\_ NORTHINGS (Y) \_\_\_\_\_ EASTINGS (X) \_\_\_\_\_

**SKETCH: (Include reference tie or witness points, remarks and topo of area)**

CORNER TIES

N 21°14.9'E, 61.45 Ft., to a chiseled "+" in the top of a 3' high concrete filled steel stanchion supporting Ducey's Lodge sign.

N 76° 20'E, 20.27 Ft., to a 27" Ponderosa Pine

S 49° 04'W, 31.01 Ft., to the NE corner of a residential structure

N 41° 56.7'W, 27.95 Ft., to the top center of a Ponderosa Pine stump

North 43.2 Ft., to the centerline of North Shore Road

Bearings are to the center of trees at base; distances are horizontal to nail and tag (stamped LS 4689) driven into base of trees, unless noted otherwise.

Placed Forest Service "Bearing Tree" and "Monument" signs on the 27" P.P.

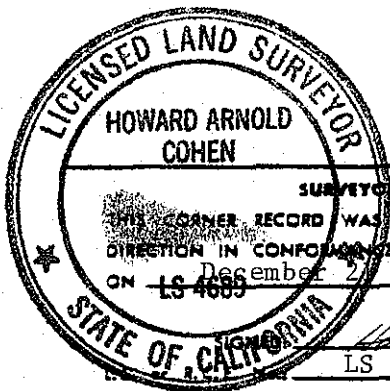

**SURVEYOR'S CERTIFICATE**

THIS CORNER RECORD WAS PREPARED BY ME OR UNDER MY DIRECTION IN CONFORMANCE WITH THE LAND SURVEYORS ACT ON December 2 19 81

*Howard Arnold Cohen*  
 LS 4689

K-12

**COUNTY SURVEYOR'S CERTIFICATE**

THE CORNER RECORD WAS RECEIVED \_\_\_\_\_ 19 \_\_\_\_\_ AND EXAMINED AND FILED \_\_\_\_\_

BY *[Signature]*  
 TITLE: \_\_\_\_\_

DOCUMENT No. \_\_\_\_\_

STATEMENT ON BACK OF SHEET