

CORNER RECORD

COUNTY OF MADERA T. 7S R. 22E M.D. MERIDIAN CALIFORNIA

CORNER TYPE: GOVT. CORNER MEANDER RANCHO CONTROL OTHER
 CORNER IDENTIFICATION — DATE OF VISIT April 21 19 81

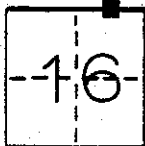

East 1/16 Section 16 7/22
 (NE corner of NW NE Section 16 7/22)

CORNER — LEFT AS FOUND FOUND AND TAGGED REESTABLISHED OBLITERATED CORNER RESULT

PHYSICAL DESCRIPTION OF CORNER FOUND; EVIDENCE AND METHOD USED TO IDENTIFY OR REESTABLISH

Found and accepted nail and tag stamped LS 2737

PHYSICAL DESCRIPTION OF MONUMENTS REBUILT OR PERPETUATED

Replaced nail and tag with a brass cap in a drill hole on a large rock outcrop, stamped for the corner with the date (1981) and LS 4689.

CALIFORNIA COORDINATE SYSTEM ORDER: FIRST SECOND THIRD
 STATIONS USED: NGS (USC & GS) STATE COUNTY OTHER STATION STATION
 ZONE ELEVATION NORTHINGS (Y) EASTINGS (X)

SKETCH: (Include reference tie or witness points, remarks and topo of area)

CORNER TIES

CAP INSCRIPTION

- N 31° 14' 06" E, 49.02 Ft. to a chiseled cross in a large rock outcrop E 1/16 S 9 S 16
- N 84° 07' E, 76.58 Ft. to a 10.4" Live Oak LS 4689
- S 47° 23' E, 94.40 Ft. to a 17.8" Black Oak 1981
- S 79° 56' W, 113.6 Ft. to a 24" Ponderosa Pine

Bearings are to the center of trees at base; distances are horizontal to nail and tag (stamped LS 4689) driven into base of trees, unless noted otherwise.

Posted Forest Service Monument and Bearing Tree signs.

Blazed and scribed trees and stamped monument in accord with Bureau of Land Management 1973 "Manual of Surveying Instructions."

J - 12
 1 05

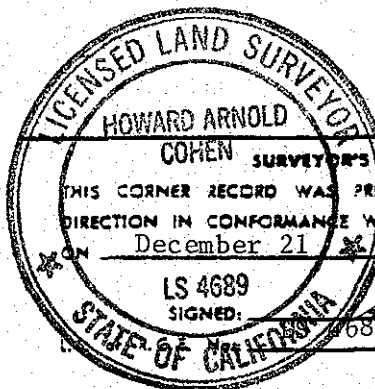

SURVEYOR'S CERTIFICATE
 THIS CORNER RECORD WAS PREPARED BY ME OR UNDER MY DIRECTION IN CONFORMANCE WITH THE LAND SURVEYORS ACT
 ON December 21 19 81

LS 4689
 SIGNED: Howard Arnold Cohen

COUNTY SURVEYOR'S CERTIFICATE
 THE CORNER RECORD WAS RECEIVED 19
 AND EXAMINED AND FILED
 BY:
 TITLE:

DOCUMENT No.
 STATEMENT ON BACK OF SHEET