

CORNER RECORD

COUNTY OF MADERA T. 7S R. 22E M.D. MERIDIAN CALIFORNIA
 CORNER TYPE: GOVT. CORNER MEANDER RANCHO CONTROL OTHER
 CORNER IDENTIFICATION — DATE OF VISIT April 27 19 81



Center North Northeast 1/64 Section 16 7/22
 (NW corner of the S 1/2 NE NE Section 16 7/22)

CORNER — LEFT AS FOUND FOUND AND TAGGED REESTABLISHED OBLITERATED CORNER RESULT
 PHYSICAL DESCRIPTION OF CORNER FOUND; EVIDENCE AND METHOD USED TO IDENTIFY OR REESTABLISH

Corner established by section subdivision survey

PHYSICAL DESCRIPTION OF MONUMENTS RESULT OR PERPETUATED
 Set a 30" aluminum monument with a 3 1/4" aluminum cap and Forest Service logo, stamped with the date (1981) and LS 4689. Set a fiberglass post about 4' from the monument with a Forest Service corner "Monument" sign attached.

CALIFORNIA COORDINATE SYSTEM ORDER: FIRST SECOND THIRD
 STATIONS USED: NGS (USC & GS) STATE COUNTY OTHER STATION _____ STATION _____
 ZONE _____ ELEVATION _____ NORTHINGS (Y) _____ EASTINGS (X) _____

SKETCH: (Include reference tie or witness points, remarks and topo of area)

CORNER TIES

- N 45 04' E, 40.90 Ft., to an 11.3" Incense Cedar
- S 71 14' E, 62.07 Ft., to a 9.5" Ponderosa Pine
- S 57 34' W, 20.97 Ft., to a 13.2" Black Oak

CAP INSCRIPTION

S 16
 C-N-NE
 1/64
 LS 4689
 1981

Corner is on West slope near the top of ridge and about 30' East of residential structure.

Bearings are to the center of trees at base; distances are horizontal to nail and tag (stamped LS 4689) driven into base of trees, unless noted otherwise.

Posted Forest Service Monument and Bearing Tree signs.

Blazed and scribed trees and stamped monument in accord with Bureau of Land Management 1973 "Manual of Surveying Instructions."

JK 12
 1 10

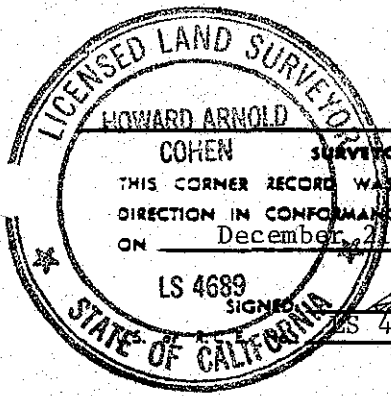

SURVEYOR'S CERTIFICATE
 THIS CORNER RECORD WAS PREPARED BY ME OR UNDER MY DIRECTION IN CONFORMANCE WITH THE LAND SURVEYORS ACT ON December 27 19 81
 LS 4689
 SIGNED Howard Arnold Cohen
 LS 4689

COUNTY SURVEYOR'S CERTIFICATE
 THE CORNER RECORD WAS RECEIVED _____ 19 _____ AND EXAMINED AND FILED _____ 19 _____
 BY: [Signature]
 TITLE: _____
 DOCUMENT No. _____
 STATEMENT ON BACK OF SHEET