

CORNER RECORD

COUNTY OF MADERA T. 7S R. 22E M.D. _____ MERIDIAN _____ CALIFORNIA

CORNER TYPE: GOVT. CORNER MEANDER RANCHO CONTROL OTHER
 CORNER IDENTIFICATION — DATE OF VISIT July 19 81



North 1/64 corner Section 15 7/22
 (NE corner of S 1/2 NE NE Section 16 7/22)

CORNER — LEFT AS FOUND FOUND AND TAGGED REESTABLISHED OBLITERATED CORNER REBUILT

PHYSICAL DESCRIPTION OF CORNER FOUND; EVIDENCE AND METHOD USED TO IDENTIFY OR REESTABLISH

Corner established by section subdivision survey.

PHYSICAL DESCRIPTION OF MONUMENTS REBUILT OR PERPETUATED

Set 30" aluminum monument with 3 1/4" aluminum cap with Forest Service logo, stamped with the date (1981) and LS 4689. Set a fiberglass post about 4' from the monument with a Forest Service corner "Monument" sign attached.

CALIFORNIA COORDINATE SYSTEM ORDER: FIRST SECOND THIRD
 STATIONS USED: NGS (USC & GS) STATE COUNTY OTHER STATION _____ STATION _____
 ZONE _____ ELEVATION _____ NORTHINGS (Y) _____ EASTINGS (X) _____

SKETCH: (Include reference tie or witness points, remarks and topo of area)
CORNER TIES

- N 16° 02' E, 87.00 Ft., to a 29.1" Ponderosa Pine
- N 62° 09' E, 49.91 Ft., to a 28.9" Ponderosa Pine
- S 49° 11' E, 66.69 Ft., to a 28.7" Ponderosa Pine
- S 46° 07' W, 92.08 Ft., to a 27.4" Ponderosa Pine
- Nail & Shiner in road 274 bears S 76°E, 215.5 Ft.
- A 20' x 20' concrete slab of camp site #4 of Ducey's bears S 56° 27'W, 162.15 Ft. (north corner of slab)
- An angle point in the creek bears N 51°W, 28 Ft. with a creek course of S 31°E and S 35°W.

CAP INSCRIPTION

N-N
 1/64
 S 16 · S 15
 LS 4689
 1981

Bearings are to the center of trees at base; distances are horizontal to nail (stamped LS 4689) driven into base of trees, unless noted otherwise. Post Forest Service Monument and Bearing Tree signs.

Blazed and described trees and stamped monument in accord with Bureau of Land Management "Manual of Surveys Instructions."

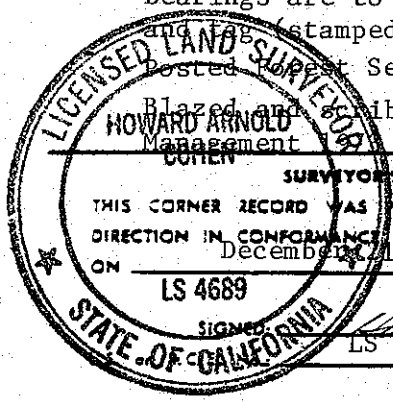

SURVEYOR'S CERTIFICATE
 THIS CORNER RECORD WAS PREPARED BY ME OR UNDER MY DIRECTION IN CONFORMANCE WITH THE LAND SURVEYORS ACT ON December 21 19 81
 LS 4689
 SIGNED Howard Arnold Cohen
 LS 4689

COUNTY SURVEYOR'S CERTIFICATE
 THE CORNER RECORD WAS RECEIVED _____ 19 _____ AND EXAMINED AND FILED BY [Signature]
 TITLE: _____
 DOCUMENT No. _____
 STATEMENT ON BACK OF SHEET

JK-13
 1 11