

CORNER RECORD

COUNTY OF Madera T. 7 S R. 22E M.D.B. & MERIDIAN CALIFORNIA

CORNER TYPE: GOV'T. CORNER MEANDER RANCHO CONTROL OTHER

CORNER IDENTIFICATION -- DATE OF VISIT December 28 1982

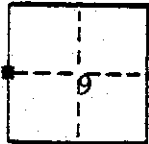

West $\frac{1}{4}$ corner section 9 7/22

CORNER -- LEFT AS FOUND FOUND AND TAGGED REESTABLISHED OBLITERATED CORNER REBUILT

PHYSICAL DESCRIPTION OF CORNER FOUND; EVIDENCE AND METHOD USED TO IDENTIFY OR REESTABLISH

Found A 1 "O.D., I.P., up 11" with a 2 $\frac{1}{2}$ " brass cap stamped for the corner with GLO logo dated 1917.

PHYSICAL DESCRIPTION OF MONUMENTS REBUILT OR PERPETUATED

Left monument as found. Set a metal post with a Forest Service K-tag and monument sign attached 4' \pm NW of corner.

CALIFORNIA COORDINATE SYSTEM ORDER: FIRST SECOND THIRD
 STATIONS USED: NGS (USC & GS) STATE COUNTY OTHER STATION _____ STATION _____
 ZONE _____ ELEVATION _____ NORTHINGS (Y) _____ EASTINGS (X) _____

SKETCH: (Include reference tie or witness points, remarks and topo of area)

Corner Ties:

Cap Inscription

Original Bearing Tree

A Black Oak, 39.2" dia., with faintly visible healed blaze bears N 51 3/4° W; 52.67'.

S8
|
1/4
|
S9
1917

New Bearing Tree

A Black Oak, 27.8" dia., bears S 40 1/2° E; 91.52'.

New Bearing Object

A Chiseled "X" in a retaining wall bears S 39° 15'E; 43.30'.

Corner is south 37' of Bass Lake Road

Corner is N 0° 02' 22" E; 2648.13' from SW corner section 9 7/22.

- . Bearings are to the center of trees at base. Distances are horizontal to a nail and tag (stamped LS 4689) driven into the side center of the root crown.
- . Posted Forest Service Monument and Bearing Tree signs on bearing trees.

G-9
2-31

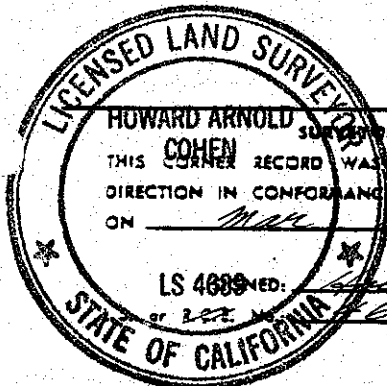

SUPERVISOR'S CERTIFICATE
 THIS CORNER RECORD WAS PREPARED BY ME OR UNDER MY DIRECTION IN CONFORMANCE WITH THE LAND SURVEYORS ACT ON Mar 21 1983

LS 4689 Howard Cohen
 of 222

COUNTY SURVEYOR'S CERTIFICATE
 THE CORNER RECORD WAS RECEIVED _____ 19____
 AND EXAMINED AND FILED _____ 19____
 BY: Howard Hansen
 TITLE: _____

DOCUMENT No. _____
 STATEMENT ON BACK OF SHEET