

CORNER RECORD

COUNTY OF Madera T. 7 S. R. 22 E. M.D.B. & _____ MERIDIAN CALIFORNIA

CORNER TYPE: GOV'T. CORNER MEANDER RANCHO CONTROL OTHER

CORNER IDENTIFICATION - DATE OF VISIT January 4 1989

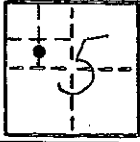

The center-south-northwest 1/64 corner section 5 7/22.
(The SE corner of government lot 15)

CORNER - LEFT AS FOUND FOUND AND TAGGED REESTABLISHED OBLITERATED CORNER RESULT

PHYSICAL DESCRIPTION OF CORNER FOUND; EVIDENCE AND METHOD USED TO IDENTIFY OR REESTABLISH
Corner position established by subdivision of section procedure.

The corner position falls at the base of a 12" dia. +/- pine.

PHYSICAL DESCRIPTION OF MONUMENTS REBUILT OR PERPETUATED
Set 2 reference monuments to the corner. Refer to corner ties #1 and #2.
Reference monuments are F.S.M.'s, up 6", no rock mounds.

F.S.M. - Aluminum monument, 2 1/2" O.D., 30" long with a 3 1/4" O.D. aluminum cap stamped for the corner, with LS 5509, the date and the Forest Service logo.

CALIFORNIA COORDINATE SYSTEM ORDER: FIRST SECOND THIRD
STATIONS USED: NGS (USC & GS) STATE COUNTY OTHER STATION _____ STATION _____
ZONE _____ ELEVATION _____ NORTHINGS (N) _____ EASTINGS (E) _____

SKETCH: (Include reference tie or witness points, remarks and topo of area)

Cap Inscriptions:

Reference Monument #1

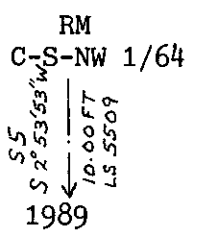

Reference Monument #2

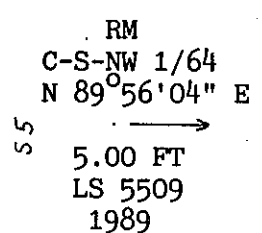

Corner Ties: (from the C-S-NW 1/64 corner)

1. Reference Monument #1 bears N 2°53'53" E 10.00' (on the east line of gov't lot 15). Set a metal post with Forest Service monument signs attached 4 1/2' +/- NE of the Reference Monument.
2. Reference Monument #2 bears S 89°56'04" W 5.00' (on the south line of gov't lot 15). Set a metal post with Forest Service monument signs attached 2 1/2' +/- SE of the Reference monument.

B.5-06
F.B. 38/63
Job No. 88-06
(Continued on back)

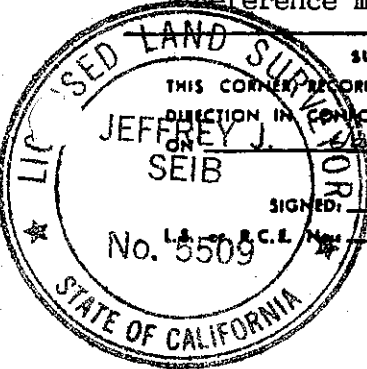

SURVEYOR'S CERTIFICATE
THIS CORNER RECORD WAS PREPARED BY ME OR UNDER MY DIRECTION IN CONFORMANCE WITH THE LAND SURVEYORS ACT ON January 4 1989
SIGNED: Jeffrey J. Seib
LS No. 5509
Exp. 9/30/92

PROFESSIONAL ENGINEER
COUNTY SURVEYOR'S CERTIFICATE
THE CORNER RECORD WAS RECEIVED _____ 19____
AND EXAMINED AND FILED: 5723 1989
BY: Robert J. Shinn
TITLE: Professional Engineer
DOCUMENT NO. _____
STATE OF CALIFORNIA

STATEMENT ON BACK OF SHEET YES NO

3. A Black Oak, 15.2" dia., bears N $45^{\circ} 45'$ E, 3.27'.

4. A Ponderosa Pine, 25.7" dia., bears S $71^{\circ} 30'$ E, 68.41'.

5. A Ponderosa Pine, 26.4" dia., bears S $8^{\circ} 00'$ E, 33.99'

Found a 1 1/4" O.D.I.P., up 3", tagged LS 2737, in a 2' dia. x 1' high rock mound S $19^{\circ} 24' 37''$ W, 15.06' from the corner -- NOT ACCEPTED.

Bearings are to the center of trees at the base. Distances are horizontal to a nail and tag (stamped LS 5509) driven into the side center of the root crown.

Posted Forest Service monument and bearing tree signs.

Blazed and scribed bearing trees: "NBT".

0822220650

