

CORNER RECORD

COUNTY OF Madera T. 7S R. 21E MD MERIDIAN CALIFORNIA

CORNER TYPE: GOV'T. CORNER  MEANDER  RANCHO  CONTROL  OTHER

CORNER IDENTIFICATION — DATE OF VISIT July 19 75

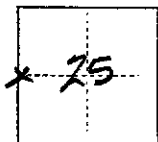

W 1/4 Cor Sec 25 7/21

CORNER — LEFT AS FOUND  FOUND AND TAGGED  REESTABLISHED OBLITERATED CORNER  REBUILT

PHYSICAL DESCRIPTION OF CORNER FOUND; EVIDENCE AND METHOD USED TO IDENTIFY OR REESTABLISH

Found Brass Cap monument, LS 2737, on 1 1/2" I.P. for W 1/4 Cor Sec 25. Orig. B.T., 10" black oak, NSE, 13.9 ft., is now a high stump with the blaze face open and partially readable. The monument is directly under the middle wire of PGE's main transmission line for the area.

PHYSICAL DESCRIPTION OF MONUMENTS REBUILT OR PERPETUATED

CALIFORNIA COORDINATE SYSTEM ORDER: FIRST  SECOND  THIRD   
STATIONS USED: NGS (USC & GS)  STATE  COUNTY  OTHER  STATION \_\_\_\_\_ STATION \_\_\_\_\_  
ELEVATION \_\_\_\_\_ NORTHINGS (Y) \_\_\_\_\_ EASTINGS (X) \_\_\_\_\_

SKETCH: (Include reference tie or witness points, remarks and topo of area)

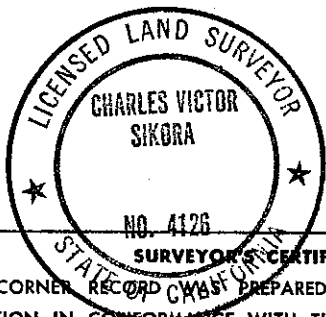
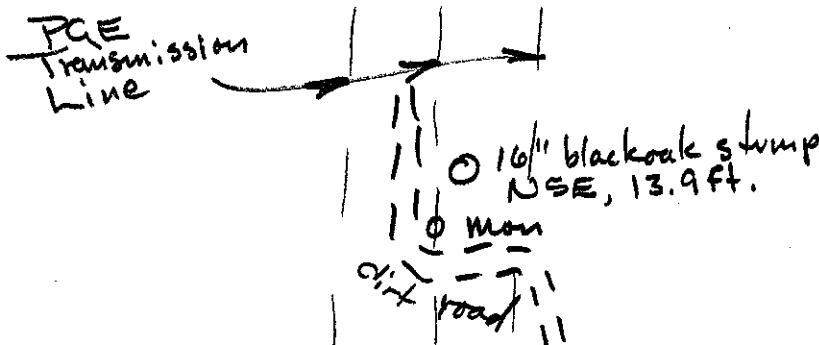

THIS CORNER RECORD WAS PREPARED BY ME OR UNDER MY DIRECTION IN CONFORMANCE WITH THE LAND SURVEYORS ACT ON 10-26 19 76

SIGNED

*Charles Victor Sikora*  
LS 4126

L.S. or R.C.E. No.: \_\_\_\_\_

SEAL

COUNTY SURVEYOR'S CERTIFICATE

THE CORNER RECORD WAS RECEIVED 10-27 19 76 AND EXAMINED AND FILED Oct 28 19 76

BY: A. Grote

TITLE: County Engineer

DOCUMENT No. 76-31-3

STATEMENT ON BACK OF SHEET

YES  NO