

CORNER RECORD

COUNTY OF MADEIRA T. 7S R. R1E. M.D.B. MERIDIAN CALIF.

CORNER TYPE: GOV'T. CORNER () MEANDER () RANCHO () CONTROL () OTHER ()

CORNER IDENTIFICATION --- DATE OF VISIT 25 APRIL 19 77

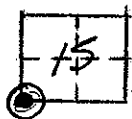

2" I.P. WITH 2" BRASS CAP MARKED FOR SEC.
CORNERS 16/15 T.7S.R21E,
21/22

CORNER -- LEFT AS FOUND () FOUND & TAGGED () REESTABLISHED OBLITERATED CORNER ()
REBUILT ()

PHYSICAL DESCRIPTION OF CORNER FOUND: EVIDENCE & METHOD USED TO IDENTIFY OR REESTABLISH:

2" I.P. WITH 2" BRASS CAP STAMPED FOR SEC'S 15, 16, 21, 22 7/21
AND PIPE STAMPED L.S. 2773 BELOW CAP.

PHYSICAL DESCRIPTION OF MONUMENTS REBUILT OR PERPETUATED:

CALIFORNIA COORDINATE SYSTEM ORDER: FIRST () SECOND () THIRD ()
STATIONS USED: NOS (USC & GS) () STATE () COUNTY () OTHER () STATION _____
STATION _____ ZONE _____ ELEVATION _____ NORTHINGS (Y) _____
EASTINGS (X) _____

SKETCH: (INCLUDE REFERENCE TIE OR WITNESS POINTS, REMARKS AND TOPO OF AREA)

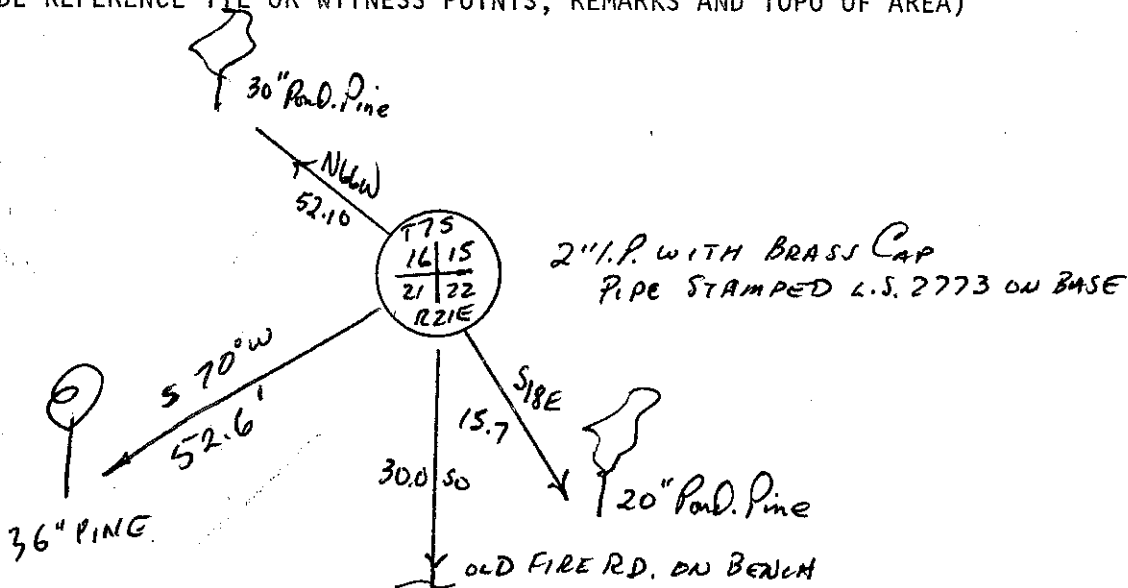

LAND SURVEYOR'S CERTIFICATE
THIS CORNER RECORD WAS PREPARED BY ME OR UNDER MY DIRECTION IN CONFORMANCE WITH THE LAND SURVEYORS ACT ON 29 APRIL 19 77
SIGNED [Signature]
L.S. STATE OF CALIFORNIA R.C.E. NO. L.S. 4261 SEAL

COUNTY SURVEYOR'S CERTIFICATE
THE CORNER RECORD WAS RECEIVED 5-20-77 AND EXAMINED AND FILED May 20 1977
BY: [Signature]
TITLE: County Engineer
DOCUMENT NO. 77-09-04
STATEMENT ON BACK OF SHEET
YES () NO (X)