

CORNER RECORD

COUNTY OF MADERA T. 7S. R. 21E. N.2.B.4 MERIDIAN CALIF.

CORNER TYPE: GOV'T. CORNER ( ) MEANDER ( ) RANCHO ( ) CONTROL ( ) OTHER ( )

CORNER IDENTIFICATION --- DATE OF VISIT 25 APRIL 19 77



N/4 COR. SEC. 15/7/21, FND. 2" I.P. WITH TAG L.S. 2737  
JUST S. OF FRESNO RIVER.

CORNER -- LEFT AS FOUND ( ) FOUND & TAGGED ( ) REESTABLISHED OBLITERATED CORNER ( )  
REBUILT ( )

PHYSICAL DESCRIPTION OF CORNER FOUND: EVIDENCE & METHOD USED TO IDENTIFY OR REESTABLISH:

2" I.P. WITH TAG L.S. 2737 JUST S. OF FRESNO RIVER.

PHYSICAL DESCRIPTION OF MONUMENTS REBUILT OR PERPETUATED:

CALIFORNIA COORDINATE SYSTEM ORDER: FIRST ( ) SECOND ( ) THIRD ( )  
STATIONS USED: NOS (USC & GS) ( ) STATE ( ) COUNTY ( ) OTHER ( ) STATION \_\_\_\_\_  
STATION \_\_\_\_\_ ZONE \_\_\_\_\_ ELEVATION \_\_\_\_\_ NORTHINGS (Y) \_\_\_\_\_  
EASTINGS (X) \_\_\_\_\_

SKETCH: (INCLUDE REFERENCE TIE OR WITNESS POINTS, REMARKS AND TOPO OF AREA)

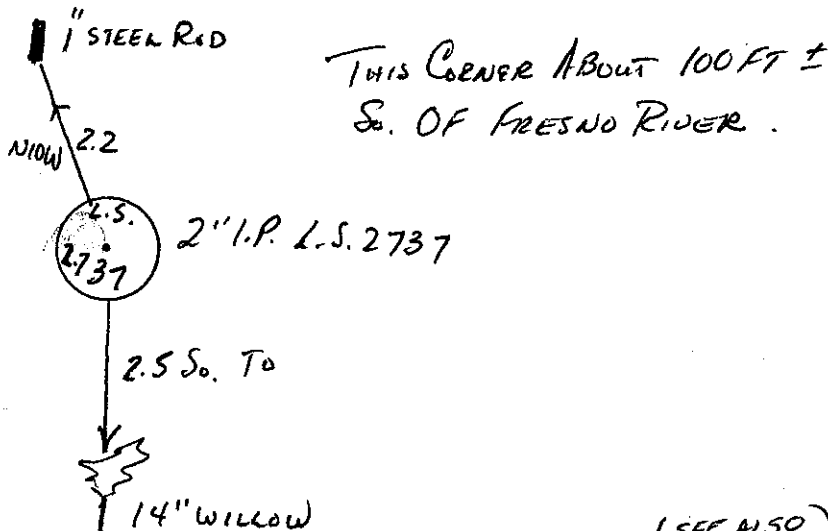

(SEE ALSO PM 1222)

**SURVEYOR'S CERTIFICATE**

THIS CORNER RECORD WAS PREPARED BY ME OR UNDER MY DIRECTION IN CONFORMANCE WITH THE LAND SURVEYORS ACT ON 29 APRIL 19 77

SIGNED [Signature]

L.S. OR R.C.E. NO. L.S. 4261

SEAL

**COUNTY SURVEYOR'S CERTIFICATE**

THE CORNER RECORD WAS RECEIVED 5-20-77 AND EXAMINED AND FILED May 20 1977

BY: A. Grote

TITLE: County Engineer

DOCUMENT NO. 77-09-02

STATEMENT ON BACK OF SHEET YES ( ) NO (X)