

CORNER RECORD

COUNTY OF Madera T. 7 S. R. 21 E. Mt. Diablo MERIDIAN CALIFORNIA
CORNER TYPE: GOVT. CORNER MEANDER RANCHO CONTROL OTHER
CORNER IDENTIFICATION — DATE OF VISIT May 12 1988

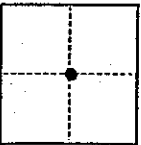

Section 9 Center 1/4 corner

CORNER — LEFT AS FOUND FOUND AND TAGGED REESTABLISHED OBLITERATED CORNER RESULT

PHYSICAL DESCRIPTION OF CORNER FOUND, EVIDENCE AND METHOD USED TO IDENTIFY OR REESTABLISH

*1 1/2" I.P. W/2" brass disc
w/ P.O.S. stamped:*



PHYSICAL DESCRIPTION OF MONUMENTS RESULT OR PERPETUATED

CALIFORNIA COORDINATE SYSTEM ORDER: FIRST SECOND THIRD STATION _____ STATION _____
MONUMENTS USED: NGS (USC & GS) STATE COUNTY OTHER NORTHINGS (Y) _____ EASTINGS (X) _____
ELEVATION _____

(Fold)

SKETCH: (Include reference tie or witness points, remarks and topo of area)

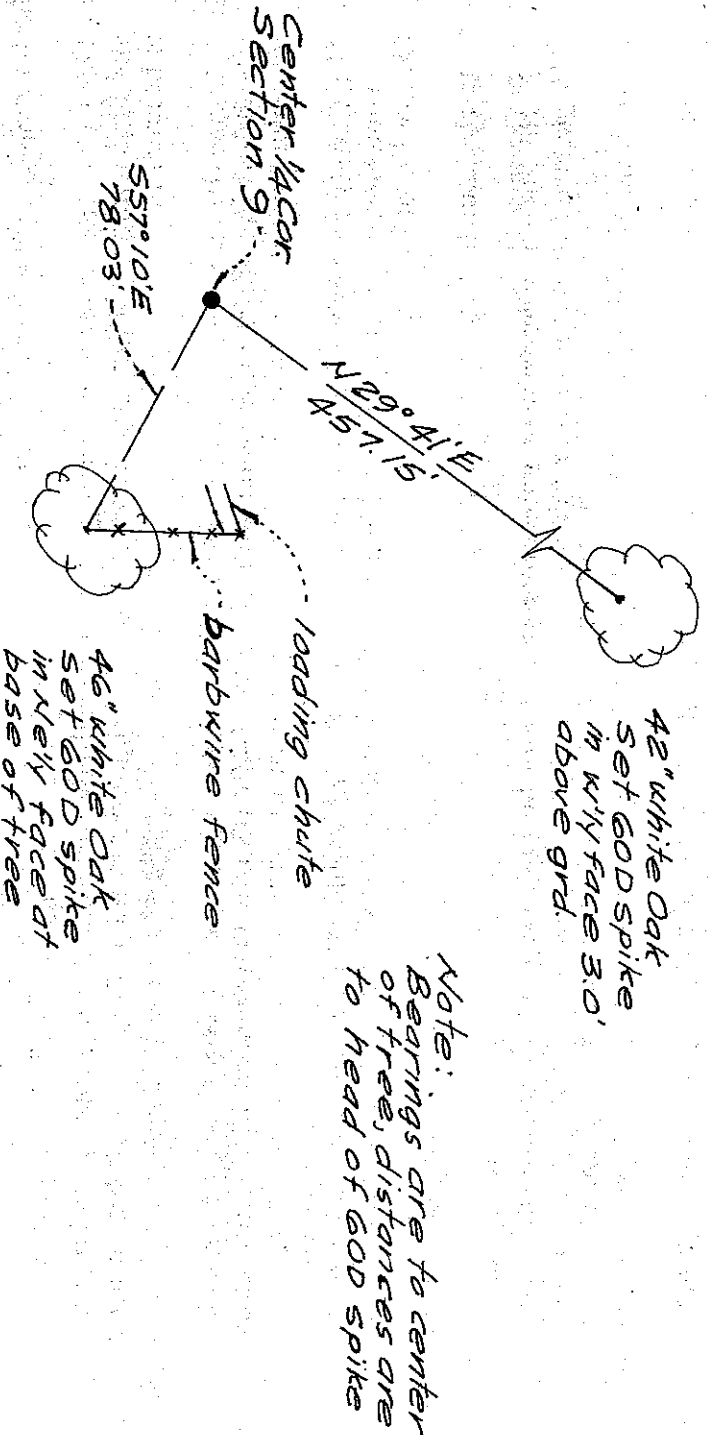

SURVEYOR'S CERTIFICATE

THIS CORNER RECORD WAS PREPARED BY ME OR UNDER MY DIRECTION IN CONFORMANCE WITH THE LAND SURVEYORS ACT

IN May 13 1988

SIGNED: _____

I.S. or R.C.E. No.: 453833

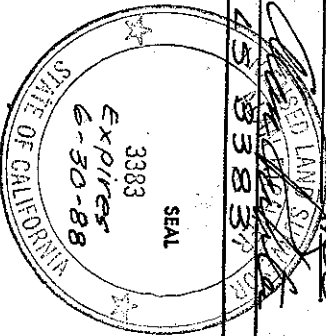

COUNTY SURVEYOR'S CERTIFICATE

THE CORNER RECORD WAS RECEIVED _____ 19____ AND EXAMINED AND ENTERED BY: Samuel W. Anderson

TITLE: _____

DOCUMENT No. _____

STATEMENT ON BACK OF SHEET

YES NO