

**CORNER RECORD**

COUNTY OF MADERA T. T. 7 S. R. 20 E MDM MERIDIAN CALIFORNIA  
 CORNER TYPE: GOVT. CORNER  MEANDER  RANCHO  CONTROL  OTHER   
 CORNER IDENTIFICATION - DATE OF VISIT NOVEMBER 1976



Sec. 20  
SE COR.

CORNER - LEFT AS FOUND  FOUND AND TAGGED  REESTABLISHED  OBLITERATED CORNER  RESULT

PHYSICAL DESCRIPTION OF CORNER FOUND; EVIDENCE AND METHOD USED TO IDENTIFY OR REESTABLISH:  
*found 1 1/4" iron pipe in rock mound at fence cor*

PHYSICAL DESCRIPTION OF MONUMENTS RESULT OR PERPETUATED

*NONE*

CALIFORNIA COORDINATE SYSTEM ORDER: FIRST  SECOND  THIRD   
 STATIONS USED: NGS (USC & GS)  STATE  COUNTY  OTHER  STATION \_\_\_\_\_ STATION \_\_\_\_\_  
 ZONE \_\_\_\_\_ ELEVATION \_\_\_\_\_ NORTHINGS (Y) \_\_\_\_\_ EASTINGS (X) \_\_\_\_\_

SKETCH: (Include reference tie or witness points, remarks and topo of area)

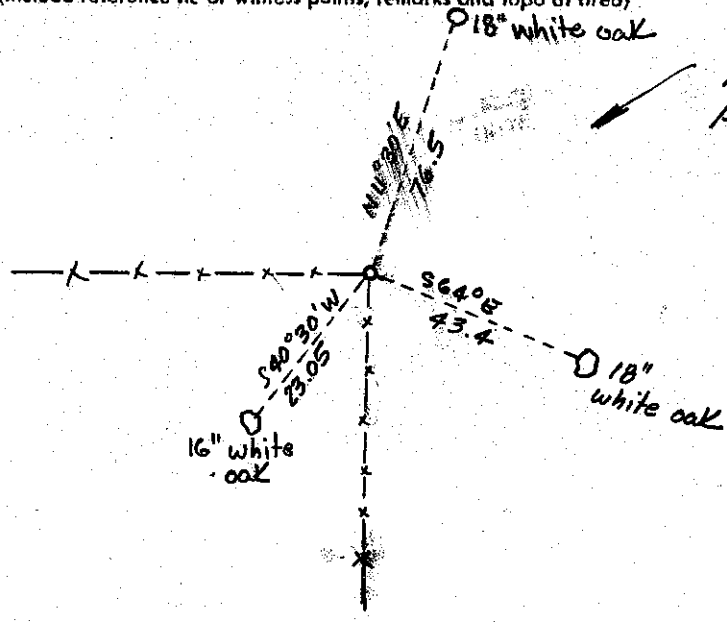

*Found as indicated on  
Parcel Map # 134  
Parcel Map # 453*

*NO SCALE*

**SURVEYOR'S CERTIFICATE**  
 THIS CORNER RECORD WAS PREPARED BY ME OR UNDER MY DIRECTION IN COMPLIANCE WITH THE LAND SURVEYORS ACT ON NOV 23 1976.  
 SIGNED: D. C. Edthausen  
 I.S. or R.C.E. No. 3722

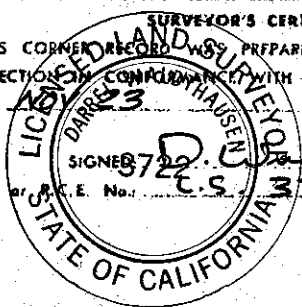

SEAL

**COUNTY SURVEYOR'S CERTIFICATE**  
 THE CORNER RECORD WAS RECEIVED NOV. 30 1976  
 AND EXAMINED AND FILED DEC. 6 1976.  
 BY: A. Crute  
 TITLE: County Engineer  
 DOCUMENT No. 76-36-06

STATEMENT ON BACK OF SHEET: YES  NO