

CORNER RECORD

COUNTY OF MADERA T. T. 7 S. R. R. 20 E. M.D.M. _____ MERIDIAN CALIFORNIA

CORNER TYPE: GOVT. CORNER MEANDER RANCHO CONTROL OTHER

CORNER IDENTIFICATION — DATE OF VISIT _____ 19____

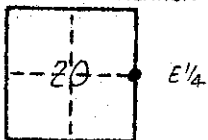

CORNER — LEFT AS FOUND FOUND AND TAGGED REESTABLISHED OBLITERATED CORNER REBUILT

PHYSICAL DESCRIPTION OF CORNER FOUND; EVIDENCE AND METHOD USED TO IDENTIFY OR REESTABLISH

Found 1" pipe and brass cap stamped "R.C.E 5982" in rock mound

PHYSICAL DESCRIPTION OF MONUMENTS REBUILT OR PERPETUATED

NONE

CALIFORNIA COORDINATE SYSTEM ORDER: FIRST SECOND THIRD

STATIONS USED: NGS (USC & GS) STATE COUNTY OTHER STATION _____ STATION _____

ZONE _____ ELEVATION _____ NORTHINGS (Y) _____ EASTINGS (X) _____

SKETCH: (Include reference tie or witness points, remarks and topo of area)

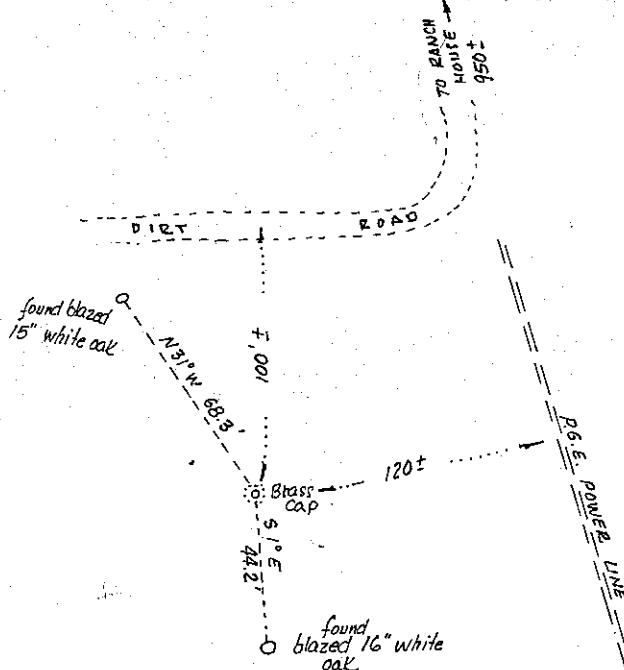

SURVEYOR'S CERTIFICATE

THIS CORNER RECORD WAS PREPARED BY ME OR UNDER MY DIRECTION IN CONFORMANCE WITH THE LAND SURVEYING ACT ON NOV. 23 1976

SIGNED: D. Waldthausen
L.S. or R.C.E. No. 1.S. 3722

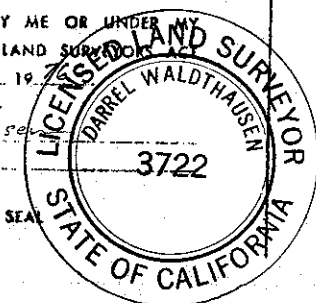

COUNTY SURVEYOR'S CERTIFICATE

THE CORNER RECORD WAS RECEIVED Nov. 30 1976 AND EXAMINED AND FILED DEC 6 1976

BY: A. Soto
TITLE: County Engineer
DOCUMENT No. 76-36-01

STATEMENT ON BACK OF SHEET

YES NO