

CORNER RECORD

COUNTY OF MADERA T. 7S R. 20E M.D.B. MERIDIAN CALIFORNIA

CORNER TYPE: GOVT. CORNER  MEANDER  RANCHO  CONTROL  OTHER

CORNER IDENTIFICATION - DATE OF VISIT 2-18 1989

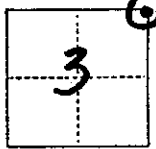

N.E. CR 3-7-20

CORNER - LEFT AS FOUND  FOUND AND TAGGED  REESTABLISHED OBLITERATED CORNER  REBUILT

PHYSICAL DESCRIPTION OF CORNER FOUND; EVIDENCE AND METHOD USED TO IDENTIFY OR REESTABLISH  
FND 1 1/2" I.P. WITH REMNANT OF I. B.T.  
SET TAG L.S. 4261

PHYSICAL DESCRIPTION OF MONUMENTS REBUILT OR PERPETUATED  
LEFT AS FND. CORNER WAS SET BY JIM KATES  
WHEN TREE WAS STANDING UPRIGHT ± 1970, NO TREES TO  
TIE TO.

CALIFORNIA COORDINATE SYSTEM ORDER: FIRST  SECOND  THIRD   
STATIONS USED: NGS (USC & GS)  STATE  COUNTY  OTHER  STATION \_\_\_\_\_ STATION \_\_\_\_\_  
ZONE \_\_\_\_\_ ELEVATION \_\_\_\_\_ NORTHINGS (N) \_\_\_\_\_ EASTINGS (X) \_\_\_\_\_

(Fold)

SKETCH: (Include reference tie or witness points, remarks and topo of area)

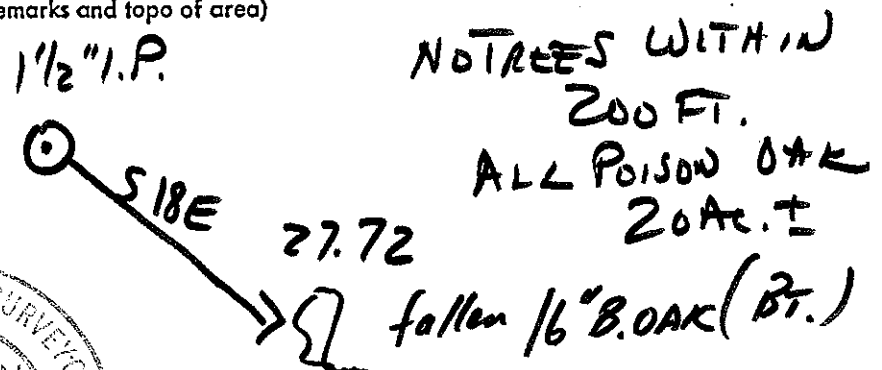

LICENSED LAND SURVEYOR  
L. M. JENSEN  
SURVEYOR'S CERTIFICATE  
THIS CORNER RECORD WAS PREPARED BY ME OR UNDER MY  
DIRECTION IN CONFORMANCE WITH THE LAND SURVEYORS ACT  
ON 5-11-89 1989  
SIGNED: [Signature]  
L.S. or R.C.E. No.: L.S. 4261

REGISTERED PROFESSIONAL ENGINEER  
STINSON  
COUNTY SURVEYOR'S CERTIFICATE  
THE CORNER RECORD WAS RECEIVED 5-22 1989  
AND EXAMINED & FILED 5-23 1989  
NO. 15500  
Doug Stinson  
Civil Engineer  
STATE OF CALIFORNIA  
STATEMENT ON BACK OF SHEET

SEAL YES  NO