

CORNER RECORD

COUNTY OF MADERA T. 7S R. 20E M.D.B. MERIDIAN CALIFORNIA
 CORNER TYPE: GOVT. CORNER MEANDER RANCHO CONTROL OTHER
 CORNER IDENTIFICATION — DATE OF VISIT 3-7- 19 89

3 E 1/4 cor 3/7/20

CORNER — LEFT AS FOUND FOUND AND TAGGED REESTABLISHED OBLITERATED CORNER REBUILT

PHYSICAL DESCRIPTION OF CORNER FOUND, EVIDENCE AND METHOD USED TO IDENTIFY OR REESTABLISH
SET 1 1/2" I.P. & TAG L.W. 4261 FROM EXIST ALIVE
B.T. — S50E, 64.68 FT. WITH NOTCHED FACE.

PHYSICAL DESCRIPTION OF MONUMENTS REBUILT OR PERPETUATED
SET 1 1/2" I.P. WITH L.W. 4261
SET B.T. TAG ON B.T.

CALIFORNIA COORDINATE SYSTEM ORDER: FIRST SECOND THIRD
 STATIONS USED: NGS (USC & GS) STATE COUNTY OTHER STATION _____ STATION _____
 ZONE _____ ELEVATION _____ NORTHINGS (Y) _____ EASTINGS (X) _____

(Fold)

SKETCH: (Include reference tie or witness points, remarks and topo of area)

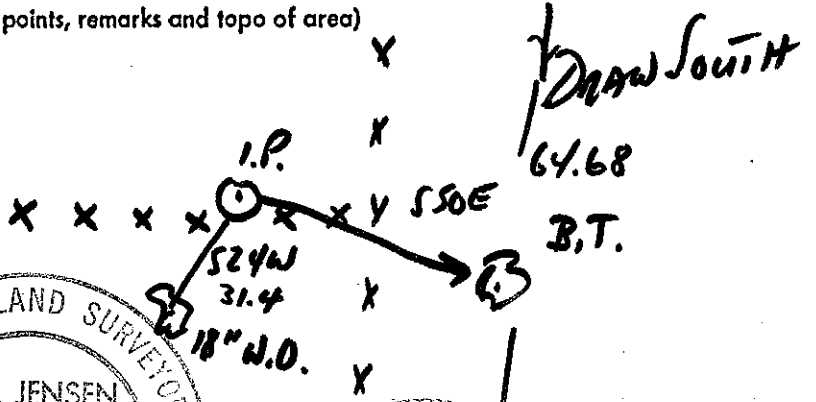

LICENSED LAND SURVEYOR
 L. M. JENSEN
 SURVEYOR'S CERTIFICATE
 CORNER RECORD WAS PREPARED BY ME OR UNDER MY
 DIRECTION IN CONFORMANCE WITH THE LAND SURVEYORS ACT
 ON 5-23-89 19 89
 SIGNED: [Signature]
 L.S. or R.C.E. No. LS4261

REGISTERED PROFESSIONAL ENGINEER
 COUNTY SURVEYOR'S CERTIFICATE
 THIS CORNER RECORD WAS RECEIVED 5-22 19 89
 AND EXAMINED AND FILED 5-23 19 89
 BY Dave Stinson
 Co. Eng'r.
 REGISTERED PROFESSIONAL ENGINEER
 STATE OF CALIFORNIA
 NO. 15301
 ON BACK OF SHEET

SEAL YES NO