

Index  
File No. **E 5**  
T. **65** R. **24 E**  
Meris. **MDM**

CORNER RECORD (SEARCH)  
(Ref. FSM 7151.4)

R.O. **Minarets** County **Madera**  
N.F. **Sierra** State **California**

Tract or  
Survey No.

Cor.  
No. **6/5**  
**7/8**

CORNER DIAGRAM

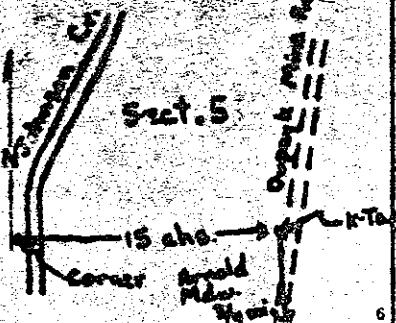

DESCRIBE CORNER MONUMENT FOUND

A post 2 1/2 ft. high, painted red, with a nail set in the top and a few rocks around the base.

DESCRIBE BEARING TREES OR OTHER OFFICIAL ACCESSORIES FOUND

A 48" dbh Ponderosa Pine bearing N 68°W, 119 links distant.  
(Bears a tag reading "This is a bearing tree. J. Clark 8/10/48.")

PHOTO IDENTIFICATION DATA

Photo No. \_\_\_\_\_  
Filed At. \_\_\_\_\_  
Object Ident. \_\_\_\_\_  
Ident. By \_\_\_\_\_  
Signature \_\_\_\_\_

DESCRIBE CORNER LOCATION RELATIVE TO NEAR-BY FEATURES, ALSO HOW TO REACH CORNER

Corner post is set 1' off the west bank of Johnsons Cr. N from a large old tree spanning the stream.  
Go 3/4 mi. up Dupzyk Rd. until you reach a K-Tag on a PP on the west side of road. Corner is about 15 chs West.

PLANE COORDINATE POSITION DATA

State \_\_\_\_\_ Zone \_\_\_\_\_  
X \_\_\_\_\_  
Y \_\_\_\_\_  
Estab. By \_\_\_\_\_  
Agency \_\_\_\_\_

Signature **S/Verne H Farrell**

Title

Division **Timber**

Headquarters

**Minarets**

Date **8/7/70**

7100-52 (3/68)

**SE CORNER SECTION 6**