

SW Cor Sec 5 6/23

USDA-FOREST SERVICE

Index File No. \_\_\_\_\_

CORNER RECORD (SEARCH)  
(Ref. FSM 7151.4)

Tract or Survey No. \_\_\_\_\_ Cor. No. \_\_\_\_\_

T. \_\_\_\_\_ R. \_\_\_\_\_ R.D. \_\_\_\_\_ County \_\_\_\_\_  
M. d. \_\_\_\_\_ N.F. \_\_\_\_\_ State \_\_\_\_\_

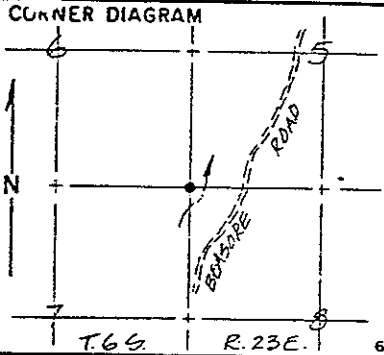

DESCRIBE CORNER MONUMENT FOUND

Found dead partial remains, (mostly the southerly and easterly outer rings and bark) of a sugar pine with scars in south and east faces.

DESCRIBE BEARING TREES OR OTHER OFFICIAL ACCESSORIES FOUND

Found a 36" fir (North 56° East, 18.06') with scribing exposed.

PHOTO IDENTIFICATION DATA

Photo No. \_\_\_\_\_  
Filed At. \_\_\_\_\_  
Object Ident. \_\_\_\_\_  
Ident. By \_\_\_\_\_  
*Signature*

DESCRIBE CORNER LOCATION RELATIVE TO NEAR-BY FEATURES, ALSO HOW TO REACH CORNER

Go north on Beasore Road approximately 1 1/4 miles from Cold Springs Summit to small creek. Walk west down cleared, posted line to corner.

PLANE COORDINATE POSITION DATA

State \_\_\_\_\_ Zone \_\_\_\_\_  
X \_\_\_\_\_  
Y \_\_\_\_\_  
Estab. By \_\_\_\_\_  
*Agency*

Signature \_\_\_\_\_ Title \_\_\_\_\_ Division \_\_\_\_\_ Headquarters \_\_\_\_\_ Date \_\_\_\_\_ FS-7100-52 (3/68)

CORNER RECORD (PERPETUATION)

MONUMENT: DESCRIBE NEW MONUMENT SET, OR WORK DONE TO PRESERVE EXISTING MONUMENT

Set a U.S.F.S. monument marked 'Witness Corner' 20.00' south and a U.S.F.S. monument marked 'Witness Corner' 20.00' west to Section 5, Section 6, Section 7 and Section 8, Township 6 South, Range 23 East. Both monuments in rock mounds.

ACCESSORIES: DESCRIBE NEW BT'S WITNESS OBJECTS ETC. ESTABLISHED, OR WORK DONE TO PRESERVE EXISTING EVIDENCE

I blazed a 29" fir South 36° West, 33.40' and a 14" fir North 2° West, 40.70'.

Work Done By Jones Title Surveyor Date \_\_\_\_\_ State Registration No. LS 4298  
or Agency \_\_\_\_\_

Certified Cor. Record Prepared? Yes  No  Filed At: \_\_\_\_\_ Date \_\_\_\_\_

REMARKS

Index File No. \_\_\_\_\_ T. \_\_\_\_\_ R. \_\_\_\_\_ M. \_\_\_\_\_ Tract or Surv. No. \_\_\_\_\_ Cor. \_\_\_\_\_