

Index File No.

CORNER RECORD (SEARCH)
(Ref. FSM 7151.4)

T or S
Section No.

SE Cor Gov Lot 1

Cor. No.

T 10 R. 23

R.D. _____ County _____

Merid. _____ N.F. _____ State _____

CORNER DIAGRAM

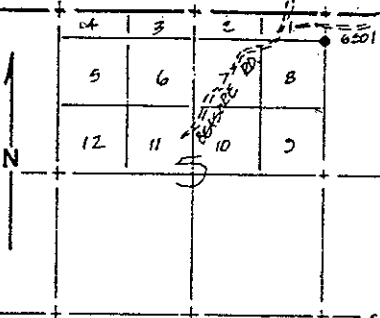

DESCRIBE CORNER MONUMENT FOUND

None found

DESCRIBE BEARING TREES OR OTHER OFFICIAL ACCESSORIES FOUND

None found

PHOTO IDENTIFICATION DATA

Photo No. _____
 Filed At. _____
 Object Ident. _____
 Ident. By _____
 Signature _____

DESCRIBE CORNER LOCATION RELATIVE TO NEAR-BY FEATURES, ALSO HOW TO REACH CORNER

Go north past Jones Store to Road 6S01. Turn east less than 1/2 mile to large rockpile fence corners. Walk south 400'.

PLANE COORDINATE POSITION DATA

State _____ Zone _____
 X _____
 Y _____
 Estab. By _____
 Agency _____

Signature _____ Title _____ Division _____ Headquarters _____ Date _____
 FS-7100-52 (3/68)

CORNER RECORD (PERPETUATION)

MONUMENT: DESCRIBE NEW MONUMENT SET, OR WORK DONE TO PRESERVE EXISTING MONUMENT

Set U.S.F.S. monument in a rock mound marked 1/16 (80), Section 5 and Section 4, Township 6 South, Range 23 East.

ACCESSORIES: DESCRIBE NEW BT'S WITNESS OBJECTS ETC. ESTABLISHED, OR WORK DONE TO PRESERVE EXISTING EVIDENCE

I blazed a 15" tamarack South 50° West, 40.24 feet and a 14" tamarack North 30° West, 7.51 feet. I set a U.S.F.S. post North 45° East, 4.0'.

Work Done By Jones Title Surveyor Date _____ State Registration No. LS 4298
 or Agency _____
 Certified Cor Record Prepared? Yes No Filed At _____ Date _____

REMARKS

Index No. T. R. M. Tract Surv. No. Cor.