

Index File No. \_\_\_\_\_

CORNER RECORD (SEARCH)  
(Ref. FSM 7151.4)

Tract or Survey No. \_\_\_\_\_  
SW Cor Sec 4 6/23  
Cor. No. \_\_\_\_\_

T. \_\_\_\_\_ R. \_\_\_\_\_ R.D. \_\_\_\_\_ County \_\_\_\_\_  
Merid. \_\_\_\_\_ N.F. \_\_\_\_\_ State \_\_\_\_\_

CORNER DIAGRAM

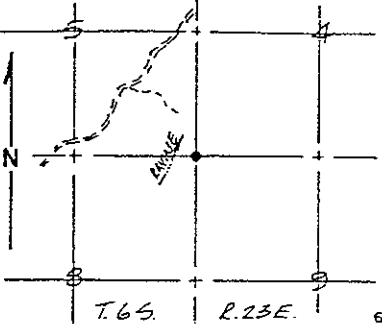

DESCRIBE CORNER MONUMENT FOUND  
Found set stone in rock mound.

DESCRIBE BEARING TREES OR OTHER OFFICIAL ACCESSORIES FOUND  
Found a dead fir stump (South 79° West) with scribing visible. Accepted heal on a 28" fir (North 44° West, 34.45') as original BT.

PHOTO IDENTIFICATION DATA  
Photo No. \_\_\_\_\_  
Filed At. \_\_\_\_\_  
Object Ident. \_\_\_\_\_  
Ident. By \_\_\_\_\_  
Signature \_\_\_\_\_

DESCRIBE CORNER LOCATION RELATIVE TO NEAR-BY FEATURES, ALSO HOW TO REACH CORNER  
Turn east at Cold Springs Summit onto logging road north at 1/2 mile, approximately 1 1/2 miles to skid road heading east. Ascend easterly thru a small pass side slope southeasterly approximately 1000 feet to corner east of small ravine.

PLANE COORDINATE POSITION DATA  
State \_\_\_\_\_ Zone \_\_\_\_\_  
X \_\_\_\_\_  
Y \_\_\_\_\_  
Estab. By \_\_\_\_\_  
Agency \_\_\_\_\_

Signature \_\_\_\_\_ Title \_\_\_\_\_ Division \_\_\_\_\_ Headquarters \_\_\_\_\_ Date \_\_\_\_\_

FS-7100-52 (3/68)

CORNER RECORD (PERPETUATION)

MONUMENT: DESCRIBE NEW MONUMENT SET, OR WORK DONE TO PRESERVE EXISTING MONUMENT

Replaced stone with U.S.F.S. monument in rock mound marked corner Section 4, Section 5, Section 8 and Section 9, Township 6 South, Range 23 East.

ACCESSORIES : DESCRIBE NEW BT'S WITNESS OBJECTS ETC. ESTABLISHED, OR WORK DONE TO PRESERVE EXISTING EVIDENCE

I blazed a 12" fir North 32° East, 36.61', a 16" fir South 50° East, 21.78' and a 10" fir South 80° West, 27.10'. I set a U.S.F.S. post North 45° West, 4.0'.

Work Done By. Jones Title Surveyor Date \_\_\_\_\_ State Registration No. LS 4298  
or Agency \_\_\_\_\_  
Certified Cor. Record Prepared? Yes No Filed At. \_\_\_\_\_ Date \_\_\_\_\_

REMARKS