

CORNER RECORD

COUNTY OF Madera T. 6S R. 22E M.D.B. & M. MERIDIAN CALIFORNIA

CORNER TYPE: GOV'T. CORNER MEANDER RANCHO CONTROL OTHER

CORNER IDENTIFICATION - DATE OF VISIT August 20 19 79

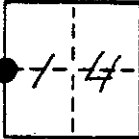

W 1/4 cor. Sec. 14 6/22

CORNER - LEFT AS FOUND FOUND AND TAGGED REESTABLISHED OBLITERATED CORNER RESULT

PHYSICAL DESCRIPTION OF CORNER FOUND; EVIDENCE AND METHOD USED TO IDENTIFY OR REESTABLISH

*could not find original monument or Bearing trees.
Set corner at proportionate distance between
fd. SW cor. Sec 14 and reestablished NW corner
Sec 15 6/22. This position is in agreement with
original calls.*

PHYSICAL DESCRIPTION OF MONUMENTS RESULT OR PERPETUATED

*Set 30" aluminum monument
with flared base and 3 1/4" aluminum cap with Forest
Service logo; stamped for corner with date (1979)
and L.S. 4689. Built rock md. around monument.
Monument up 6"*

CALIFORNIA COORDINATE SYSTEM ORDER: FIRST SECOND THIRD
STATIONS USED: NGS (USC & GS) STATE COUNTY OTHER STATION _____ STATION _____
ZONE _____ ELEVATION _____ NORTHINGS (Y) _____ EASTINGS (X) _____

SKETCH: (Include reference tie or witness points, remarks and topo of area) *Ties are from
Monument. Bearing trees are blazed and scribed
'NBT' for New Bearing tree.*

Ties:

<i>N 27° E</i>	<i>18.71'</i>	<i>to 5&N</i>	<i>in</i>	<i>16.9" dia.</i>	<i>Incense Cedar</i>
<i>S 45 1/4° E</i>	<i>18.69'</i>	<i>to 5&N</i>	<i>in</i>	<i>17.2" dia</i>	<i>White Fir</i>
<i>S 39 1/2° W</i>	<i>41.16'</i>	<i>to 5&N</i>	<i>in</i>	<i>23.3" dia</i>	<i>White Fir</i>
<i>N 72 1/2° W</i>	<i>24.95'</i>	<i>to 5&N</i>	<i>in</i>	<i>20.2" dia</i>	<i>Incense Cedar</i>

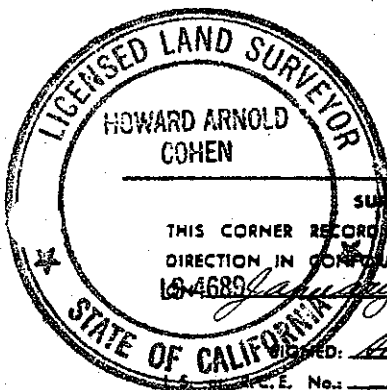

SURVEYOR'S CERTIFICATE

THIS CORNER RECORD WAS PREPARED BY ME OR UNDER MY DIRECTION IN COMPLIANCE WITH THE LAND SURVEYORS ACT
L.S. 4689 January 18 19 80

Signed: Howard Arnold Cohen
L.S. No.: LS. 4689

COUNTY SURVEYOR'S CERTIFICATE

THE CORNER RECORD WAS RECEIVED _____ 19____
AND EXAMINED AND FILED 2/6 19 80
BY: A. Brate
TITLE: COUNTY ENGR.

DOCUMENT No. _____

STATEMENT ON BACK OF SHEET