

# CORNER RECORD

COUNTY OF Madera T. 6S R. 22E MDB& MERIDIAN CALIFORNIA

CORNER TYPE: GOVT. CORNER  MEANDER  RANCHO  CONTROL  OTHER

CORNER IDENTIFICATION -- DATE OF VISIT 8-23 1978

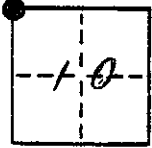

Northwest corner Section 10 within Sierra National Forest

CORNER -- LEFT AS FOUND  FOUND AND TAGGED  REESTABLISHED OBLITERATED CORNER  REBUILT

**PHYSICAL DESCRIPTION OF CORNER FOUND; EVIDENCE AND METHOD USED TO IDENTIFY OR REESTABLISH**  
 Found 1"x2"x8" stake in 2' dia rock mound--mound and stake not original. Also found remains of three original bearing trees.  
 Accepted rock mound and stake as a perpetuation of original corner position. See below.

**PHYSICAL DESCRIPTION OF MONUMENTS REBUILT OR PERPETUATED**

Set 30" alum. monument with flared base and 3-1/4" alum. cap with Forest Service logo; stamped for corner as per BLM Manual of Surveying Instructions, date and LS 4481.  
 Monument up 8" in 4' dia rock mound. Rock mound painted red.

CALIFORNIA COORDINATE SYSTEM ORDER: FIRST  SECOND  THIRD

STATIONS USED: NGS (USC & GS)  STATE  COUNTY  OTHER  STATION \_\_\_\_\_ STATION \_\_\_\_\_

ZONE \_\_\_\_\_ ELEVATION \_\_\_\_\_ NORTHINGS (Y) \_\_\_\_\_ EASTINGS (X) \_\_\_\_\_

**SKETCH: (Include reference tie or witness points, remarks and topo of area)**

1. (Sugar Pine 60" dia S 80-3/4°E 92 lks (60.72')  
 Found Sugar Pine stump 60" dia. S80-3/4°E 62.2'
2. (Sugar Pine 56" dia S28-1/2°W 100 lks (66'))  
 Found Sugar Pine stump 56" dia. S29°W 69.2'
3. (Fir 18" dia N 71-3/4°W 47 lks(31.02')  
 Found remains of Fir stump 2' dia + N70°W 32.4'

Ties from corner:  
 N44-1/2°E 17.09' to S&N in 51" dia Sugar Pine  
 S40-1/2°E 43.27' to S&N in 36" dia White Fir  
 S3-3/4°E 48.32' to S&N in 23" dia White Fir  
 S32°W 41.38' to S&N in 30" dia White Fir  
 N86-1/2°W 37.78' to S&N in 32" dia White Fir

Placed bearing tree tags, USFS Attention signs and painted red ring around all witness trees.  
 ( ) enclose Record GLO bearing and distance.

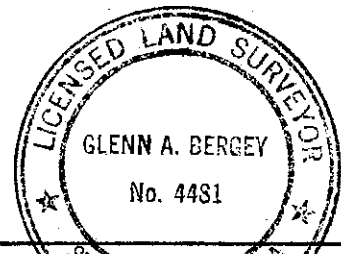

**SURVEYOR'S CERTIFICATE**

THIS CORNER RECORD WAS PREPARED BY ME OR UNDER MY DIRECTION IN CONFORMANCE WITH THE LAND SURVEYORS ACT ON January 26 1979

SIGNED: Glenn A. Bergey  
 L.S. or R.C.E. No.: LS # 4481

**COUNTY SURVEYOR'S CERTIFICATE**

THE CORNER RECORD WAS RECEIVED \_\_\_\_\_ 19\_\_\_\_  
 AND EXAMINED AND FILED \_\_\_\_\_ 19\_\_\_\_  
 BY: \_\_\_\_\_  
 TITLE: \_\_\_\_\_

DOCUMENT No. \_\_\_\_\_

STATEMENT ON BACK OF SHEET