

CORNER RECORD

COUNTY OF Madera T. 6S R. 22E M.D.B.R. MERIDIAN CALIFORNIA

CORNER TYPE: GOVT. CORNER MEANDER RANCHO CONTROL OTHER

CORNER IDENTIFICATION - DATE OF VISIT August 16, 1979

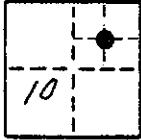

NE 1/16 cor. Sec. 10 6/22

CORNER - LEFT AS FOUND FOUND AND TAGGED REESTABLISHED OBLITERATED CORNER REBUILT

PHYSICAL DESCRIPTION OF CORNER FOUND; EVIDENCE AND METHOD USED TO IDENTIFY OR REESTABLISH

Established position of NE 1/16 cor. @ intersection of straight lines between opposite 1/16 corners.

PHYSICAL DESCRIPTION OF MONUMENTS REBUILT OR PERPETUATED

set 30" aluminum monument with flared base and 3 1/4" aluminum cap with Forest Service logo; stamped for corner and date (1979) and L.S. 4689. Built rock mound around monument. Monument up 3"

CALIFORNIA COORDINATE SYSTEM ORDER: FIRST SECOND THIRD
 STATIONS USED: NGS (USC & GS) STATE COUNTY OTHER STATION _____ STATION _____
 ZONE _____ ELEVATION _____ NORTHINGS (Y) _____ EASTINGS (X) _____

SKETCH: (Include reference tie or witness points, remarks and topo of area) *Ties are from monument Bearing trees are blazed and scribed 'NBT' for New Bearing Tree.*

Ties:
N 15 3/4° E 53.69' to SB&N in 17.9" dia. Incense Cedar
S 61 1/2° E 15.97' to SB&N in 16.3" dia. Incense Cedar

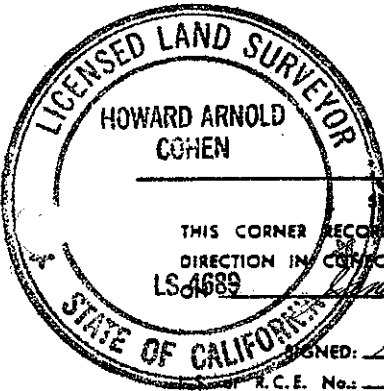

SURVEYOR'S CERTIFICATE
 THIS CORNER RECORD WAS PREPARED BY ME OR UNDER MY DIRECTION IN CONFORMANCE WITH THE LAND SURVEYORS ACT
 LS 4689 January 18, 1980
 SIGNED: Howard Arnold Cohen
 License No.: L.S. 4689

COUNTY SURVEYOR'S CERTIFICATE
 THE CORNER RECORD WAS RECEIVED _____ 19____
 AND EXAMINED AND FILED FEB 16, 1980
 BY: D. G. Gato
 TITLE: COUNTY ENGR.
 DOCUMENT No. _____
 STATEMENT ON BACK OF SHEET