

CORNER RECORD

COUNTY OF Madera T. 6S R. 22E M.D.B.R. MERIDIAN CALIFORNIA
 CORNER TYPE: GOVT. CORNER MEANDER RANCHO CONTROL OTHER
 CORNER IDENTIFICATION — DATE OF VISIT August 20 1979



N. ctr. 416 cor. 5. 10 6/22

CORNER — LEFT AS FOUND FOUND AND TAGGED REESTABLISHED OBLITERATED CORNER REBUILT

PHYSICAL DESCRIPTION OF CORNER FOUND; EVIDENCE AND METHOD USED TO IDENTIFY OR REESTABLISH
Established position of N ctr. 416 cor. on line between the ctr. 44 cor. and N 44 cor. and halfway between.

PHYSICAL DESCRIPTION OF MONUMENTS REBUILT OR PERPETUATED *Set 30" aluminum monument with flared base and 3 1/4" aluminum cap with Forest service logo; stamped for corner with date (1979) and L.S. 4689. Built rock mound around cor. mon. Mon. up. 6"*

CALIFORNIA COORDINATE SYSTEM ORDER: FIRST SECOND THIRD
 STATIONS USED: NGS (USC & GS) STATE COUNTY OTHER STATION _____ STATION _____
 ZONE _____ ELEVATION _____ NORTHINGS (Y) _____ EASTINGS (X) _____

SKETCH: (Include reference tie or witness points, remarks and topo of area)
Ties are from monument. Bearing trees are blazed and scribed 'NBT' for New Bearing Tree.

Ties
*S 34 1/2° W 27.04' to SB&N in 6.5" dia. white Fir.
 N 87 1/4° E 12.87' to SB&N in 12.3" dia white Fir.*

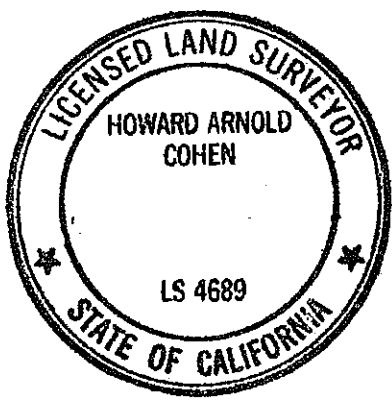

SURVEYOR'S CERTIFICATE
 THIS CORNER RECORD WAS PREPARED BY ME OR UNDER MY DIRECTION IN CONFORMANCE WITH THE LAND SURVEYORS ACT ON January 18 1980
 SIGNED: Howard Arnold Cohen
 L.S. or R.C.E. No. L.S. 4689

COUNTY SURVEYOR'S CERTIFICATE
 THE CORNER RECORD WAS RECEIVED _____ 19_____
 AND EXAMINED AND FILED FEB 6 1980
 BY: A. Corate
 TITLE: COUNTY EDGR.
 DOCUMENT No. _____
 STATEMENT ON BACK OF SHEET