

CORNER RECORD

COUNTY OF Madera T. 6 S R. 22 E Madera MERIDIAN CALIFORNIA

CORNER TYPE: GOVT. CORNER MEANDER RANCHO CONTROL OTHER

CORNER IDENTIFICATION - DATE OF VISIT August 20, 1979

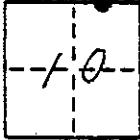

$E \frac{1}{16} \text{ cor. } \frac{3}{10}$

CORNER - LEFT AS FOUND FOUND AND TAGGED REESTABLISHED OBLITERATED CORNER REBUILT

PHYSICAL DESCRIPTION OF CORNER FOUND; EVIDENCE AND METHOD USED TO IDENTIFY OR REESTABLISH

Established position of $E \frac{1}{16}$ cor. halfway between the $N \frac{1}{4}$ cor & the NE cor sec 10 $\frac{6}{22}$ and on the straight line between them.

PHYSICAL DESCRIPTION OF MONUMENTS REBUILT OR PERPETUATED

Set 30" aluminum monument with flared base and $3 \frac{1}{4}$ " cap with Forest Service logo; stamped for cor. with date (1979) and LS 4689. Built rock md. around mon. Monument up 6".

CALIFORNIA COORDINATE SYSTEM ORDER: FIRST SECOND THIRD
 STATIONS USED: NGS (USC & GS) STATE COUNTY OTHER STATION _____ STATION _____
 ZONE _____ ELEVATION _____ NORTHINGS (Y) _____ EASTINGS (X) _____

SKETCH: (Include reference tie or witness points, remarks and topo of area)

Ties are from monument. Bearing trees are blazed and scribed 'NBT' for New Bearing Tree.

Ties

$N 42 \frac{1}{4}^{\circ} E \quad 6.16'$ to 5&N in 14.4" dia. White Fir
 $S 55 \frac{1}{4}^{\circ} E \quad 37.72'$ to 5&N in 19.3" dia Incense Cedar

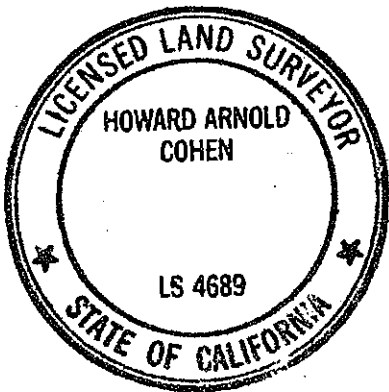

SURVEYOR'S CERTIFICATE

THIS CORNER RECORD WAS PREPARED BY ME OR UNDER MY DIRECTION IN CONFORMANCE WITH THE LAND SURVEYORS ACT ON January 18, 1980

SIGNED: Howard Arnold Cohen

L.S. or R.C.E. No.: L.S. 4689

COUNTY SURVEYOR'S CERTIFICATE

THE CORNER RECORD WAS RECEIVED _____ 19____ AND EXAMINED AND FILED FEB. 6, 1980

BY: D. Grate

TITLE: COUNTY ENGR

DOCUMENT No. _____

STATEMENT ON BACK OF SHEET