

# CORNER RECORD

COUNTY OF Madera T. 6 S R. 22 E M.D.B. & MERIDIAN CALIFORNIA

CORNER TYPE: GOV'T. CORNER  MEANDER  RANCHO  CONTROL  OTHER

CORNER IDENTIFICATION - DATE OF VISIT August 16 1979

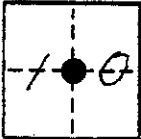

*ctt. 1/4 cor. S. 10 6/22*

CORNER - LEFT AS FOUND  FOUND AND TAGGED  REESTABLISHED OBLITERATED CORNER  RESULT

PHYSICAL DESCRIPTION OF CORNER FOUND; EVIDENCE AND METHOD USED TO IDENTIFY OR REESTABLISH

*Established position of c 1/4 cor. at intersection of straight lines connecting opposite 1/4 corners*

PHYSICAL DESCRIPTION OF MONUMENTS RESULT OR PERPETUATED *Set 30" aluminum monument with flared base and 3 1/4" aluminum cap with Forest Service Logo; stamped for corner with date (1979) and L.S. 4689. Built rock md. around monument. Monument up. 6".*

CALIFORNIA COORDINATE SYSTEM ORDER: FIRST  SECOND  THIRD   
 STATIONS USED: NGS (USC & GS)  STATE  COUNTY  OTHER  STATION \_\_\_\_\_ STATION \_\_\_\_\_  
 ZONE \_\_\_\_\_ ELEVATION \_\_\_\_\_ NORTHINGS (Y) \_\_\_\_\_ EASTINGS (X) \_\_\_\_\_

SKETCH: (Include reference tie or witness points, remarks and topo of area) *Ties are from monument. Bearing trees are blazed and scribed 'N B T' for New Bearing Tree.*

Ties:

*N 80 1/4° W 114.32' to 5&N in 18.2" dia. Incense Cedar  
 N 0 1/4° E 152.59' to 5&N in 41.7" dia Incense Cedar*

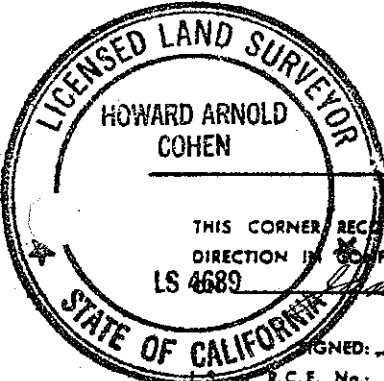
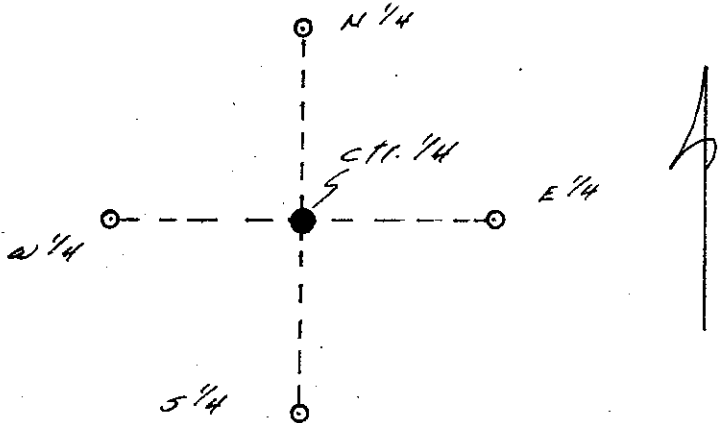

**SURVEYOR'S CERTIFICATE**  
 THIS CORNER RECORD WAS PREPARED BY ME OR UNDER MY DIRECTION IN PERFORMANCE WITH THE LAND SURVEYORS ACT  
 LS 4689 January 19 1980  
 SIGNED: Howard Arnold Cohen  
 R.C.E. No.: LS. 4689

**COUNTY SURVEYOR'S CERTIFICATE**  
 THE CORNER RECORD WAS RECEIVED \_\_\_\_\_ 19\_\_\_\_\_  
 AND EXAMINED AND FILED FEB. 16 1980  
 BY: A. J. ...  
 TITLE: COUNTY ENGR.  
 DOCUMENT No. \_\_\_\_\_  
 STATEMENT ON BACK OF SHEET