

CORNER RECORD

COUNTY OF MADERA T. 6S R. T1E. M.D.B. & - MERIDIAN CALIF.

CORNER TYPE: GOV'T. CORNER () MEANDER () RANCHO () CONTROL () OTHER ()

CORNER IDENTIFICATION --- DATE OF VISIT 28 July 19 76

S.E. CORNER SEC. 35 T6S R21E.



CORNER -- LEFT AS FOUND () FOUND & TAGGED () REESTABLISHED OBLITERATED CORNER () REBUILT ()

PHYSICAL DESCRIPTION OF CORNER FOUND: EVIDENCE & METHOD USED TO IDENTIFY OR REESTABLISH: 4x4x24" REDWOOD POST WITH SCRIBING. A NAIL HAS BEEN SET IN THE TOP OF THE POST.

PHYSICAL DESCRIPTION OF MONUMENTS REBUILT OR PERPETUATED: LEFT AS FND.

CALIFORNIA COORDINATE SYSTEM ORDER: FIRST () SECOND () THIRD () STATIONS USED: NOS (USC & GS) () STATE () COUNTY () OTHER () STATION _____ STATION _____ ZONE _____ ELEVATION _____ NORTHINGS (Y) _____ EASTINGS (X) _____

SKETCH: (INCLUDE REFERENCE TIE OR WITNESS POINTS, REMARKS AND TOPO OF AREA)

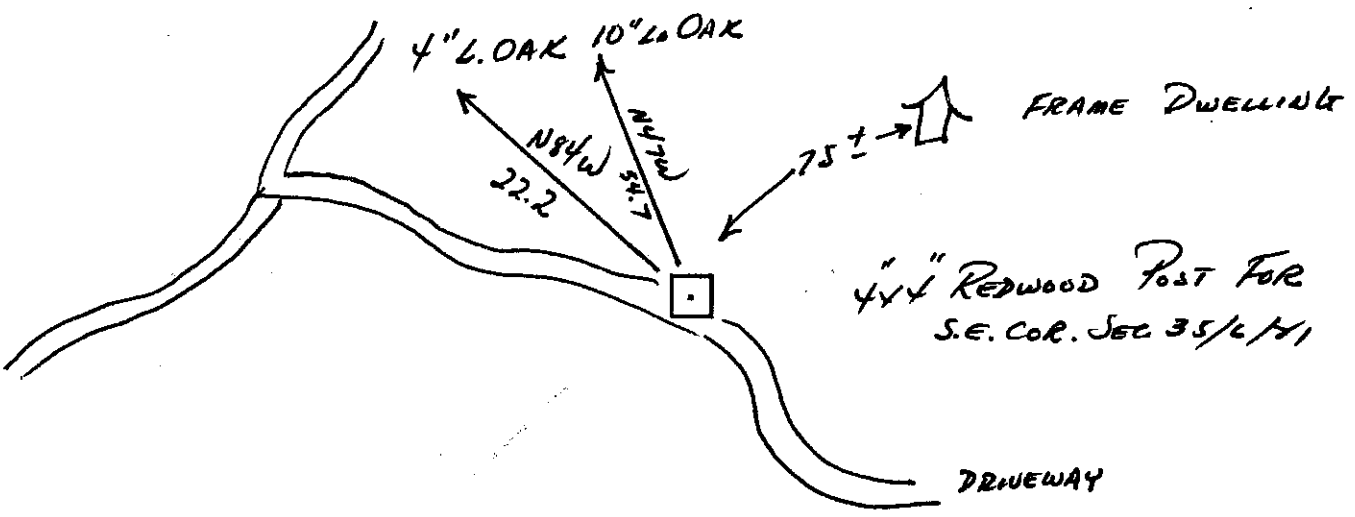

SURVEYOR'S CERTIFICATE

THIS CORNER RECORD WAS PREPARED BY ME OR UNDER MY DIRECTION IN CONFORMANCE WITH THE LAND SURVEYORS ACT ON 28 July 19 76

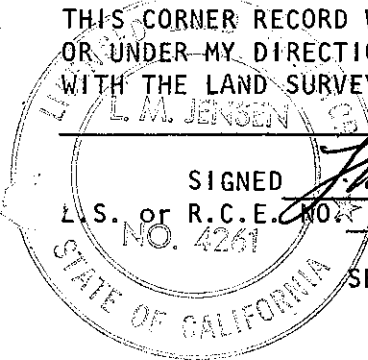

SIGNED L.M. Jensen L.S. or R.C.E. NO. L.S. 4261

COUNTY SURVEYOR'S CERTIFICATE

THE CORNER RECORD WAS RECEIVED 8-19-76 AND EXAMINED AND FILED 8-19 1976

BY: A. Grote TITLE: County Engineer

DOCUMENT NO. 76-24-3 STATEMENT ON BACK OF SHEET YES () NO ()