

CORNER RECORD

COUNTY OF MADERA T. 65 R. 21 E MT. DIABLO MERIDIAN CALIFORNIA
 CORNER TYPE: GOV'T. CORNER MEANDER RANCHO CONTROL OTHER
 CORNER IDENTIFICATION - DATE OF VISIT APRIL 16 19 90

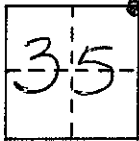

CORNER - LEFT AS FOUND FOUND AND TAGGED REESTABLISHED OBLITERATED CORNER REBUILT

PHYSICAL DESCRIPTION OF CORNER FOUND; EVIDENCE AND METHOD USED TO IDENTIFY OR REESTABLISH

*FOUND 1" IRON PIPE TAGGED RE 8938
 UP 08' IN ROCK MOUND
 WITH GUARD POST & FOREST SERVICE MARKER STAMPED FOR COR.
 INFORMATION FROM RECORD OF SURVEY 33/93*

PHYSICAL DESCRIPTION OF MONUMENTS REBUILT OR PERPETUATED

CALIFORNIA COORDINATE SYSTEM ORDER: FIRST SECOND THIRD
 STATIONS USED: NGS (USC & GS) STATE COUNTY OTHER STATION _____ STATION _____
 ZONE _____ ELEVATION _____ NORTHINGS (Y) _____ EASTINGS (X) _____

SKETCH: (Include reference tie or witness points, remarks and topo of area)

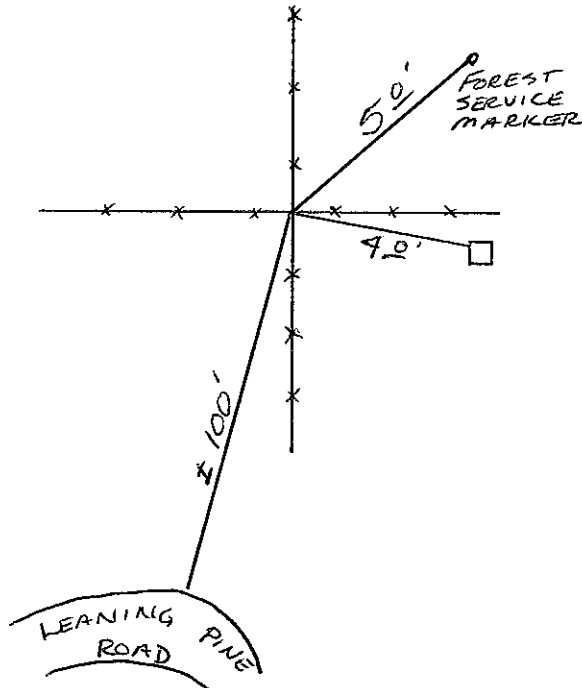

- 6' NORTH OF BOTTOM OF GULLEY

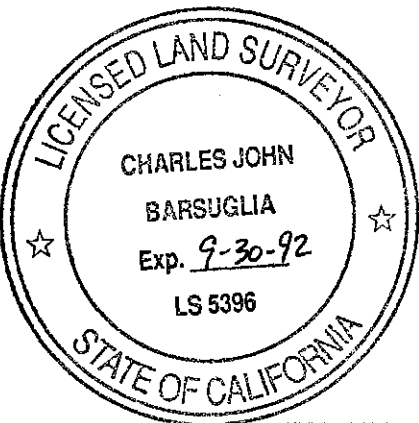

SURVEYOR'S CERTIFICATE

THIS CORNER RECORD WAS PREPARED BY ME OR UNDER MY DIRECTION IN CONFORMANCE WITH THE LAND SURVEYORS ACT ON 5-24 19 90 FOR THE STATE OF CALIFORNIA

SIGNED: Charles Barsuglia
 L.S. OF R.C.E. No.: 5396

SEAL

COUNTY SURVEYOR'S CERTIFICATE

THE CORNER RECORD WAS RECEIVED _____ 19 _____ AND EXAMINED AND FILED 6-18 19 90.
 BY: Dave Stinson
 TITLE: Madera Co. Engin.

DOCUMENT No. _____

STATEMENT ON BACK OF SHEET

YES NO